

5 cm

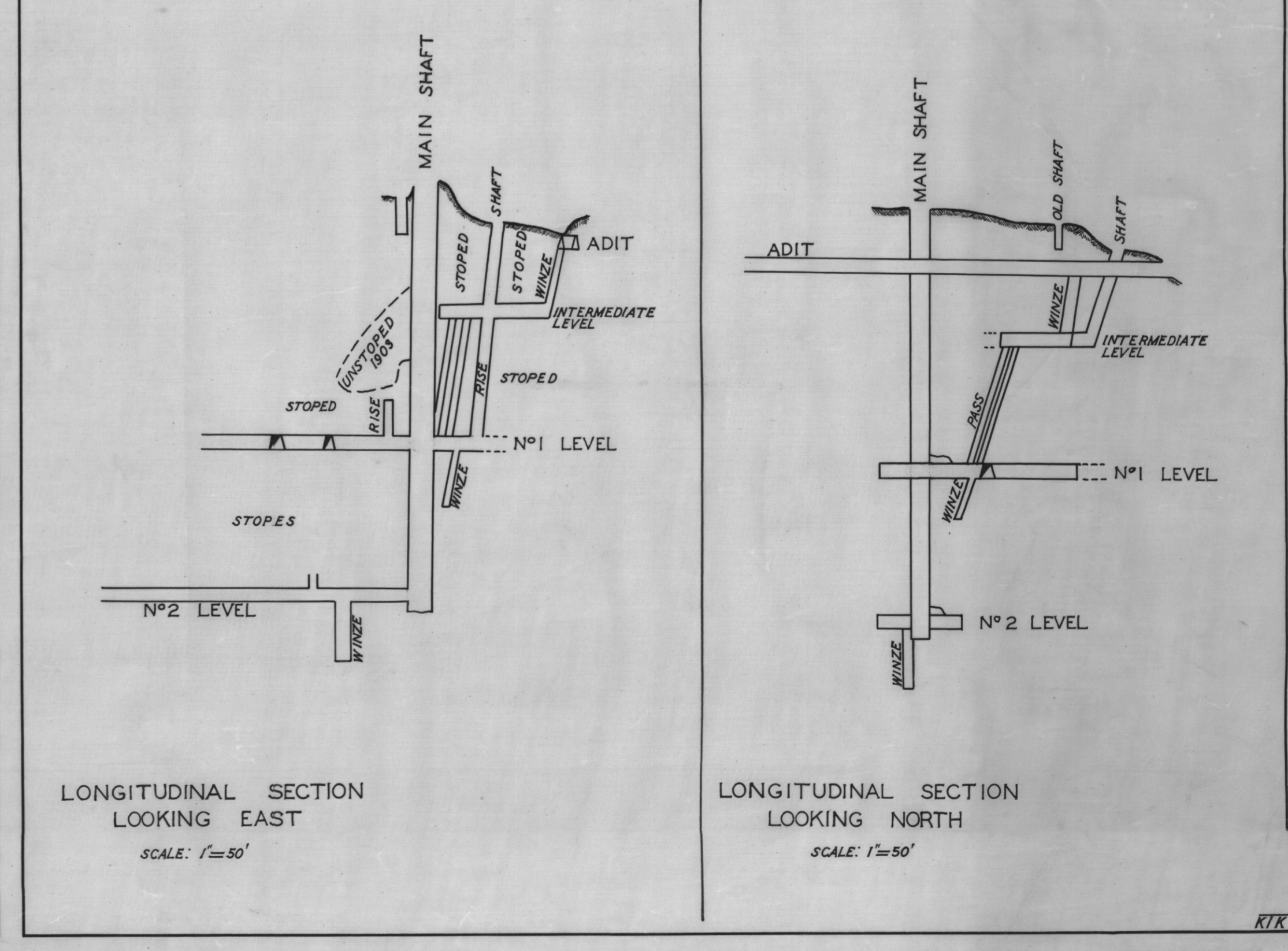
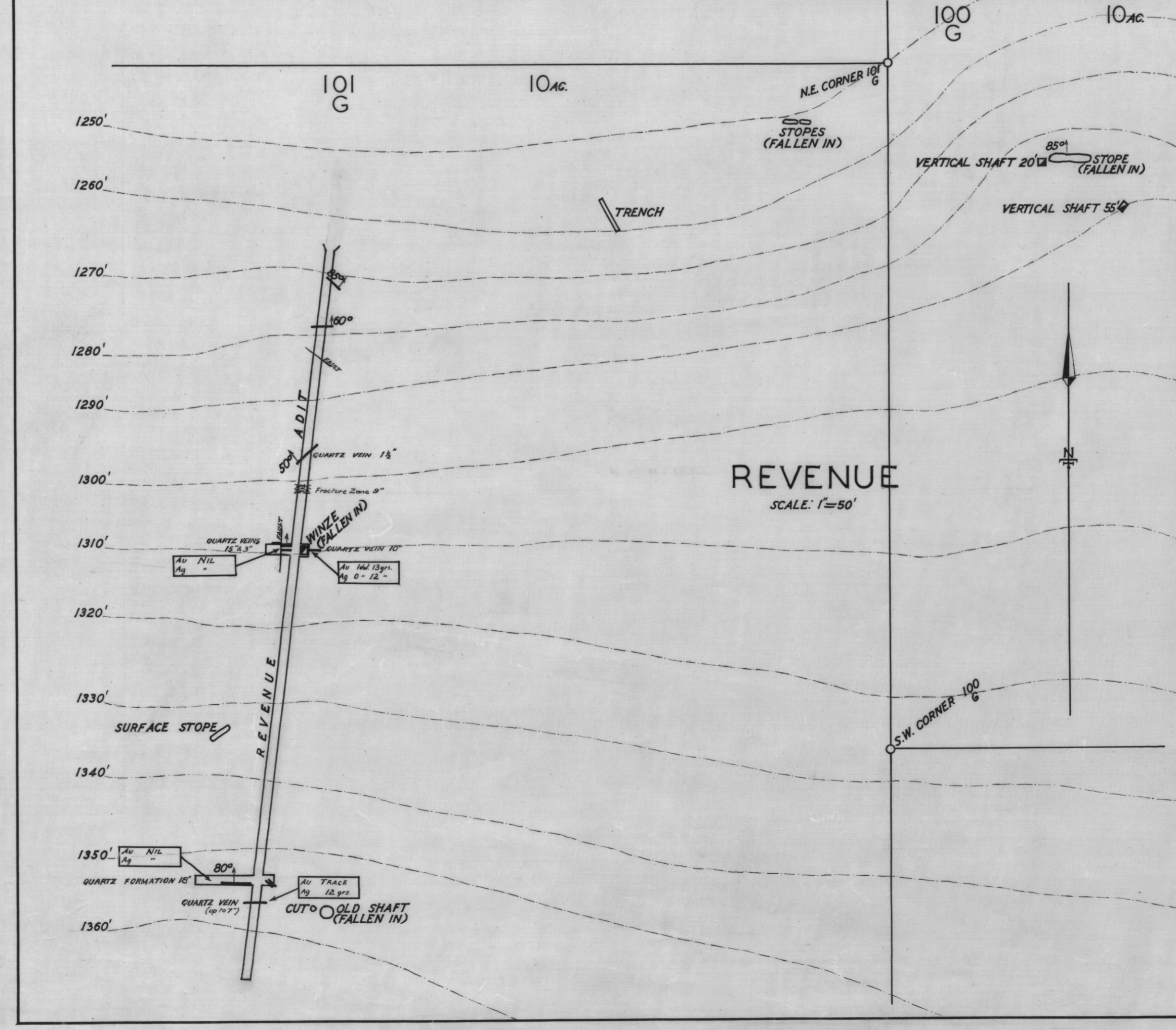
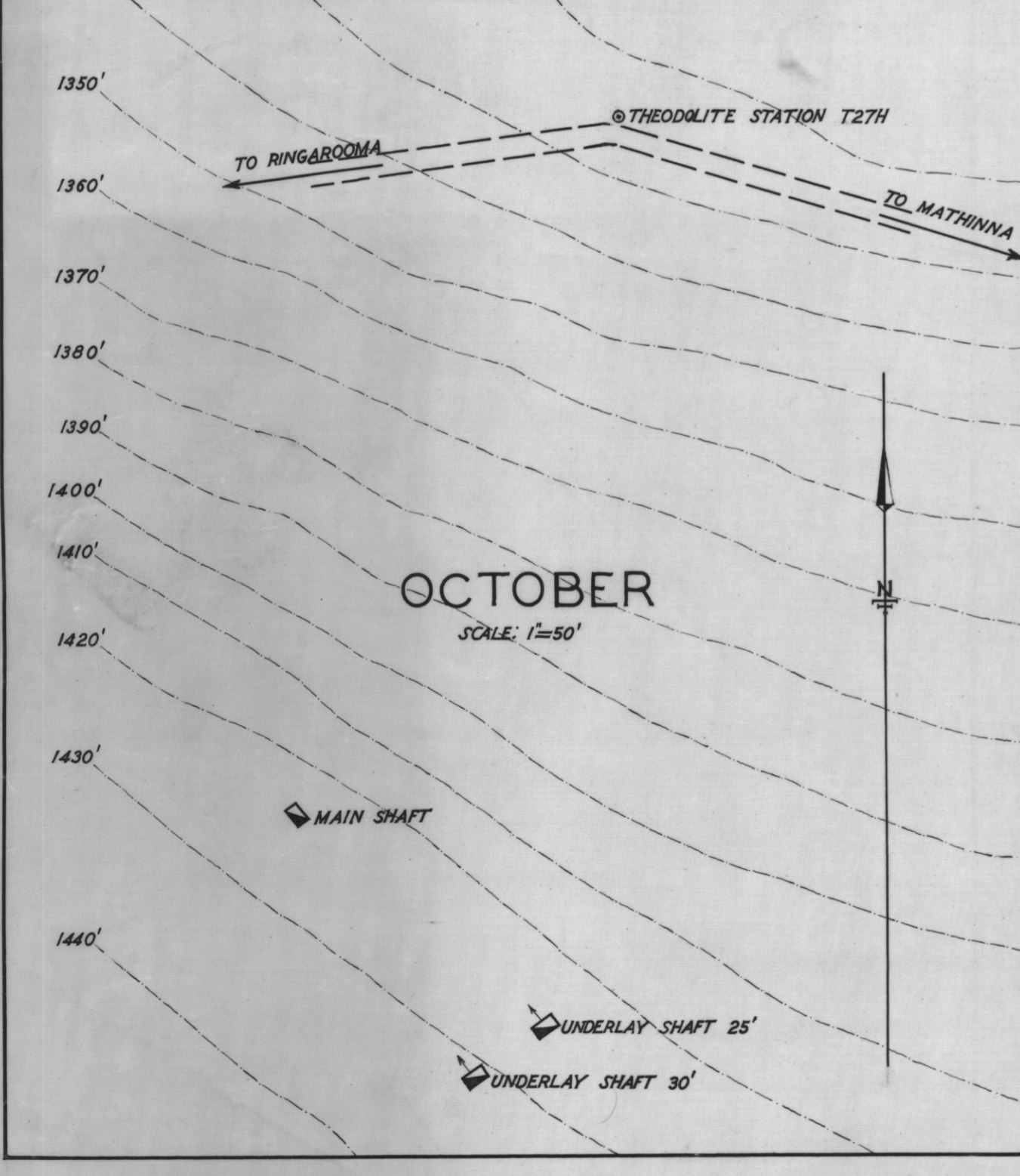
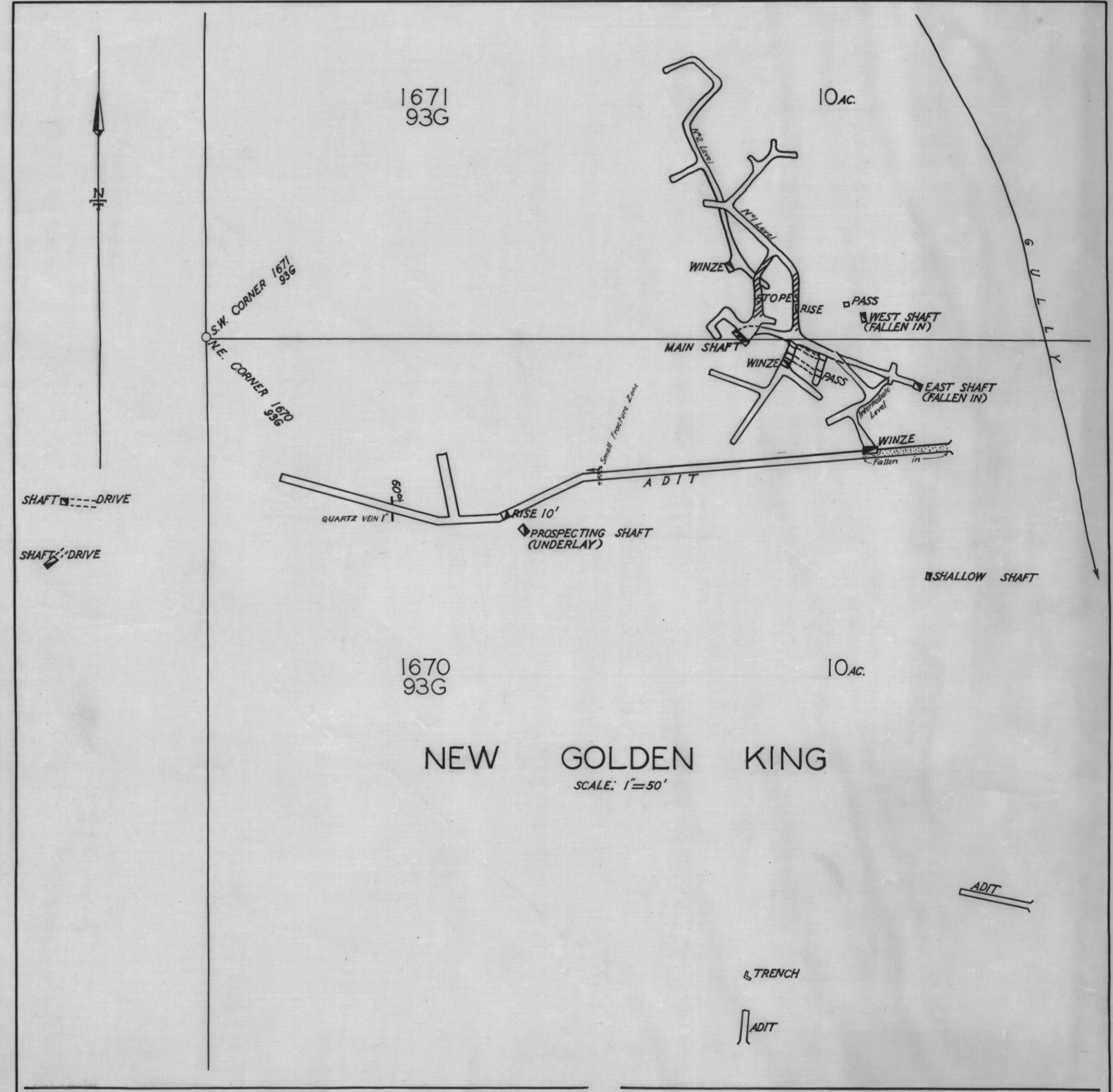
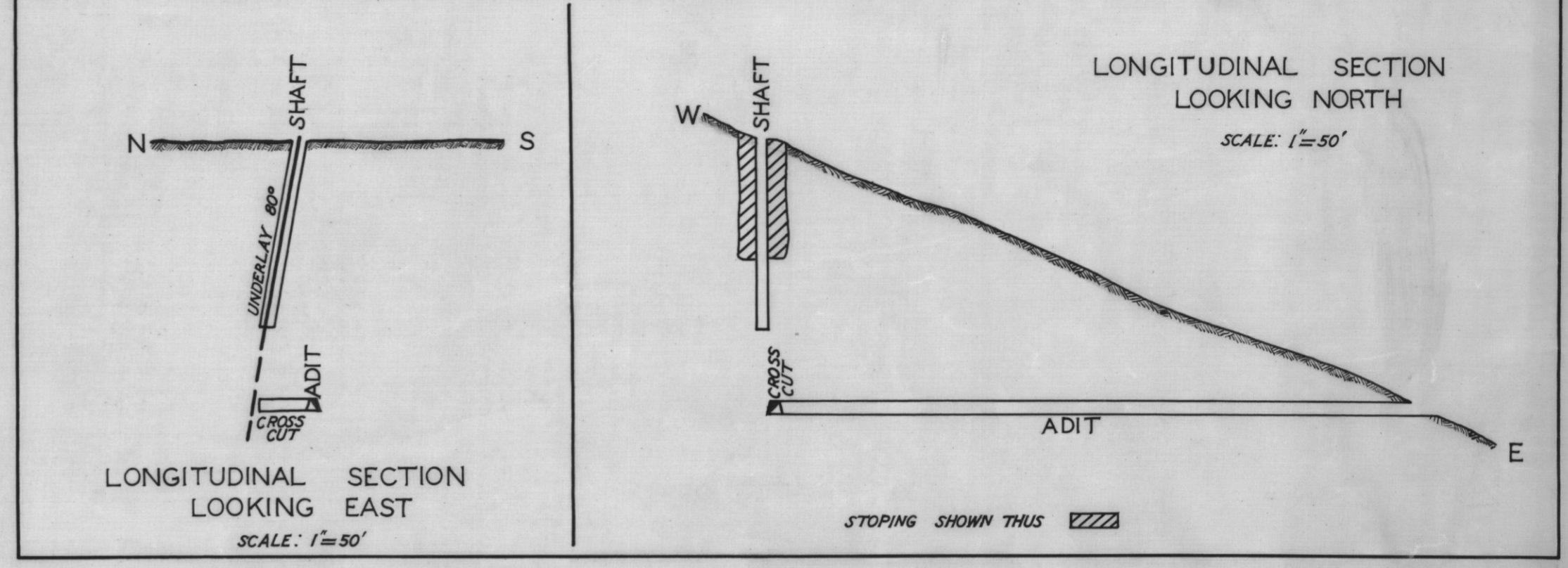
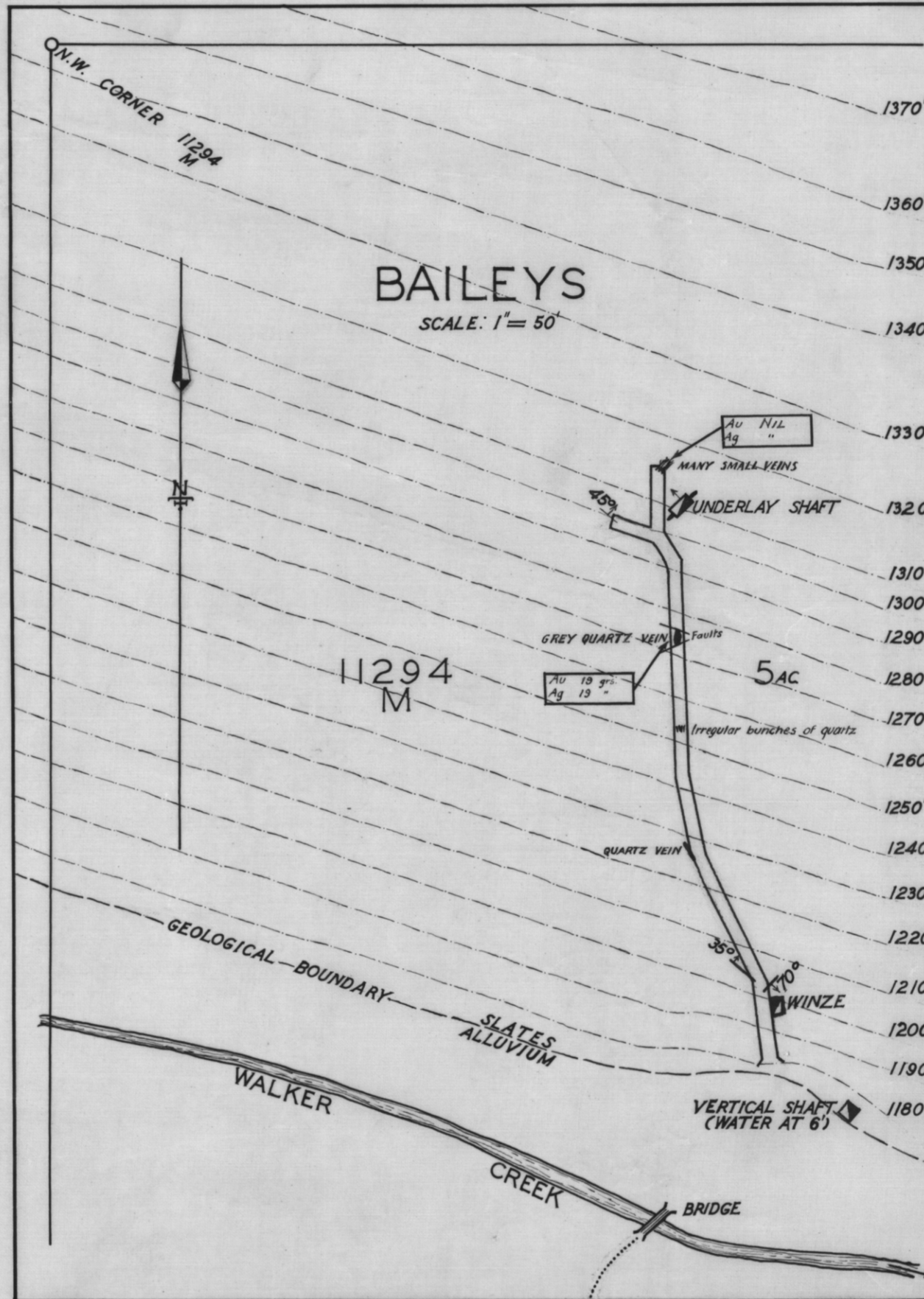
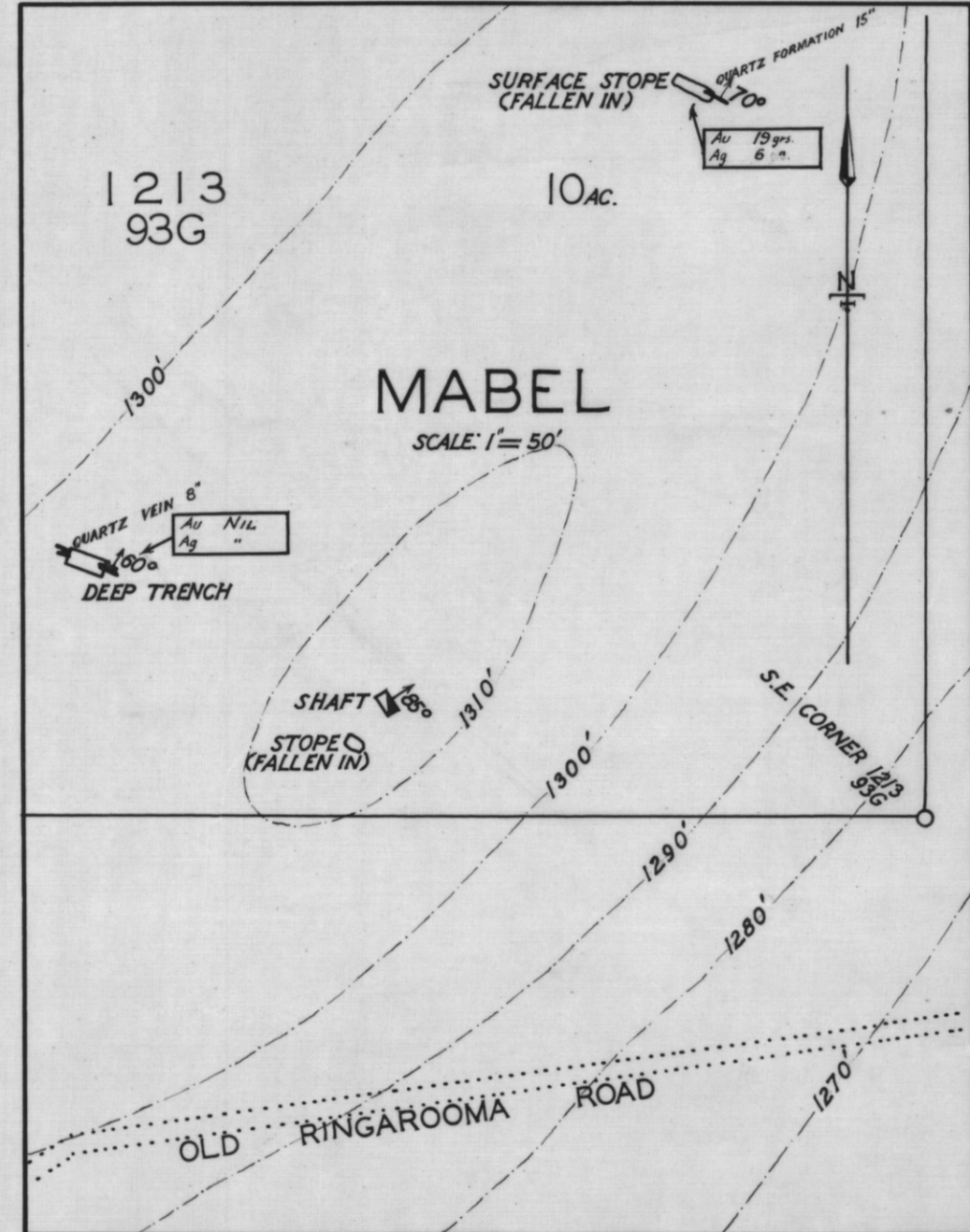
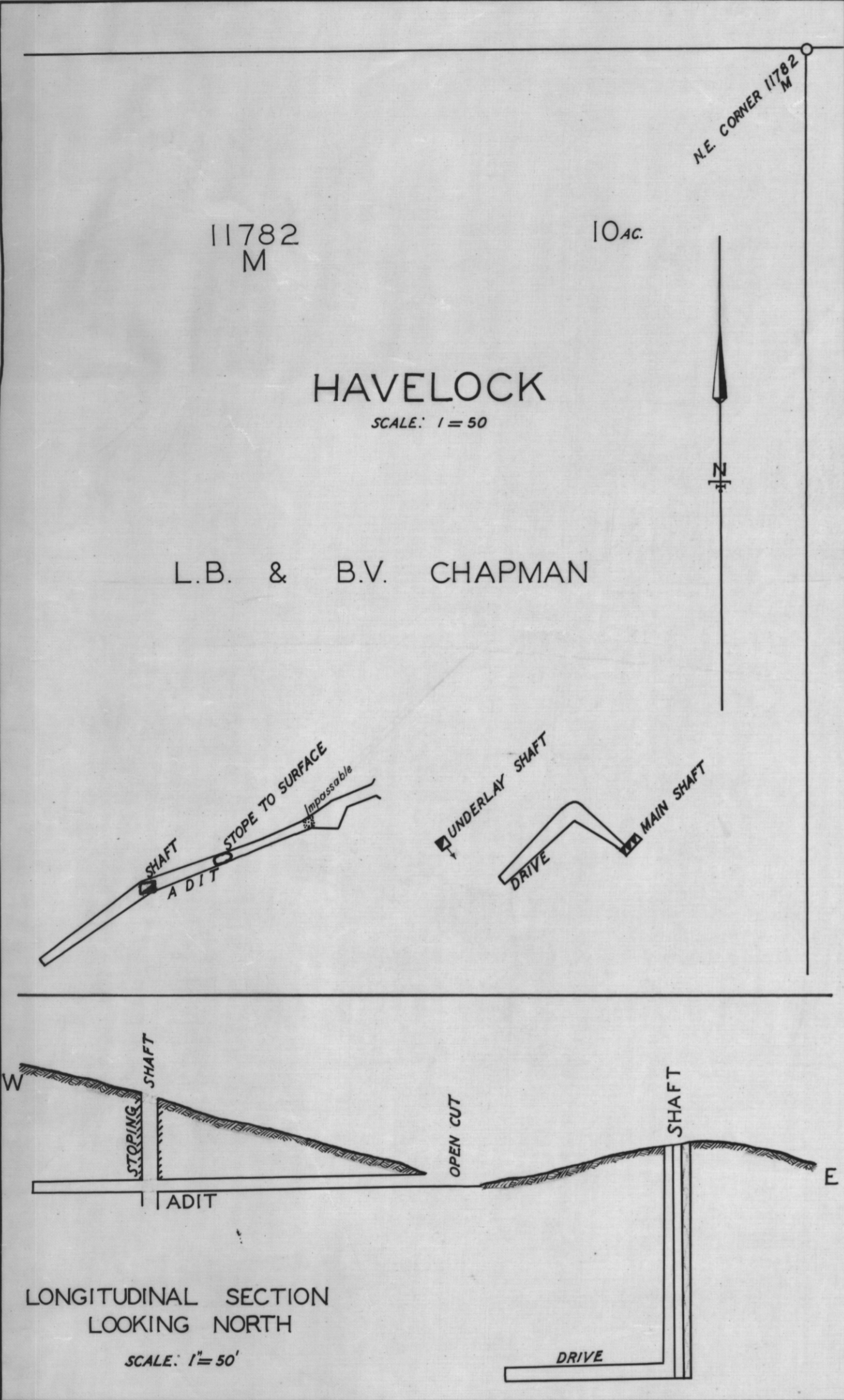
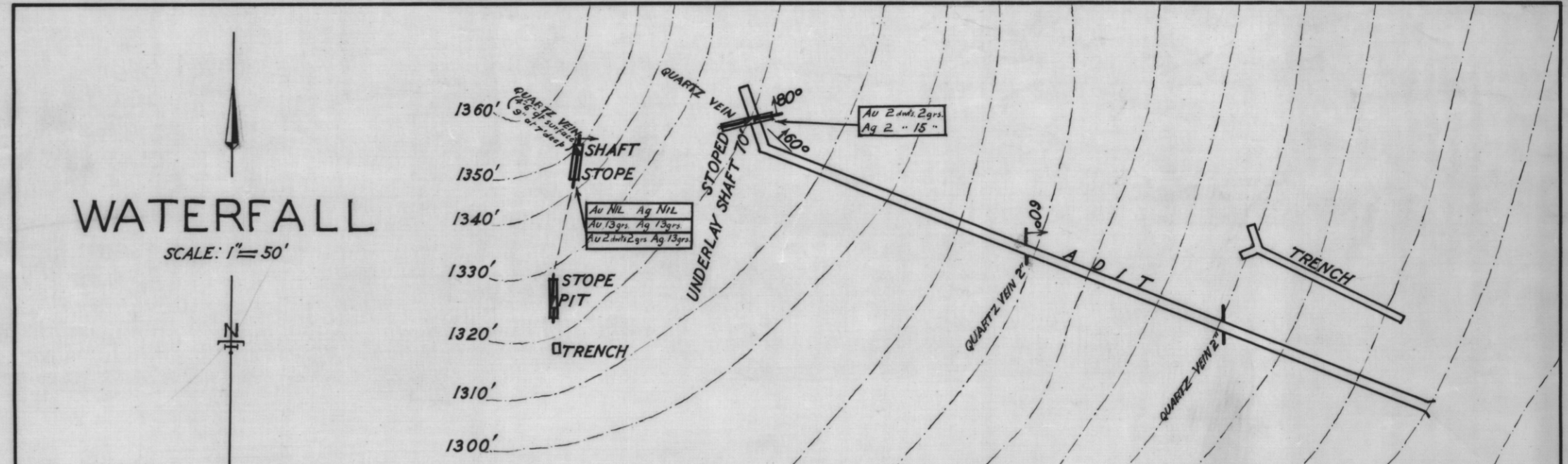
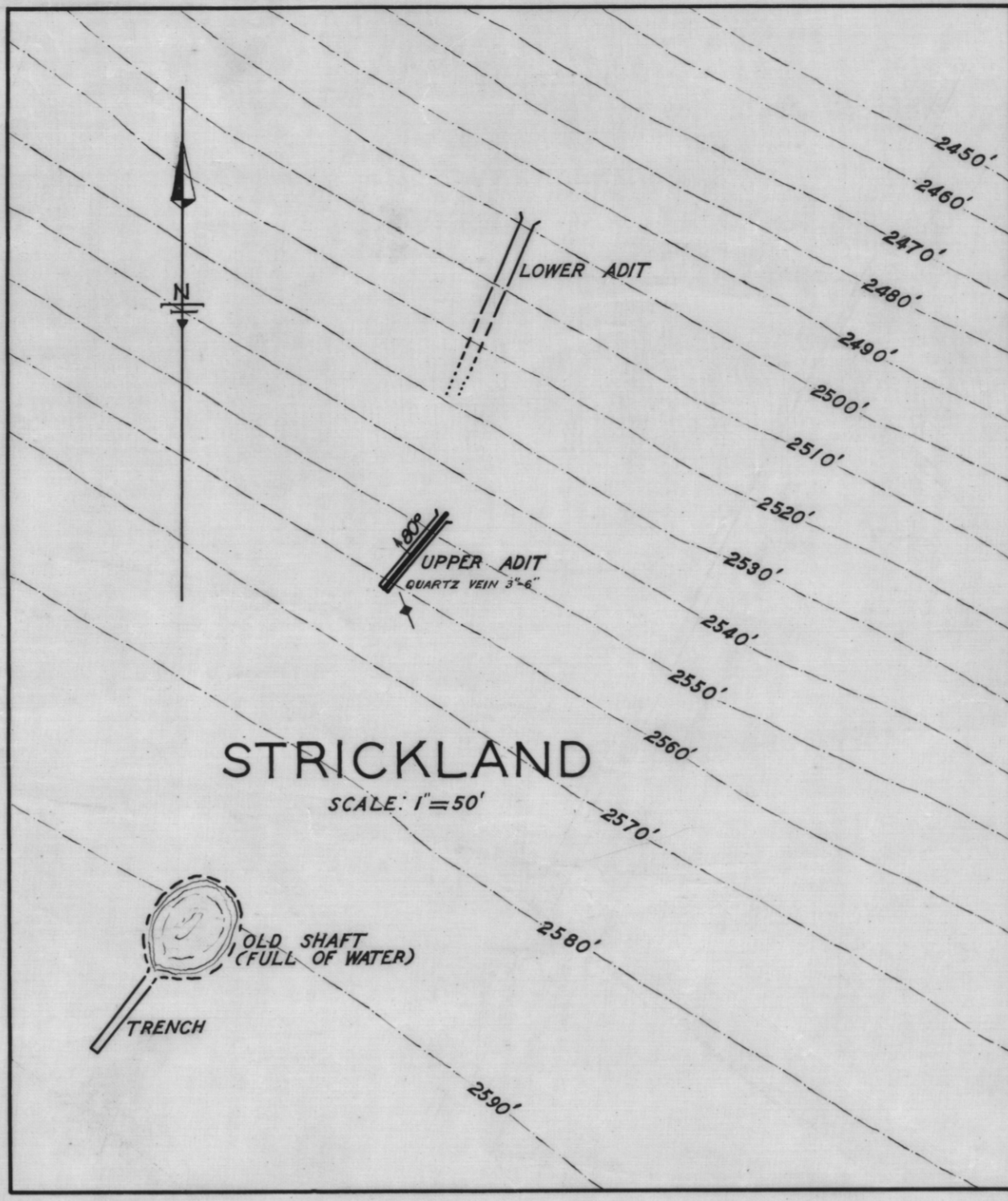
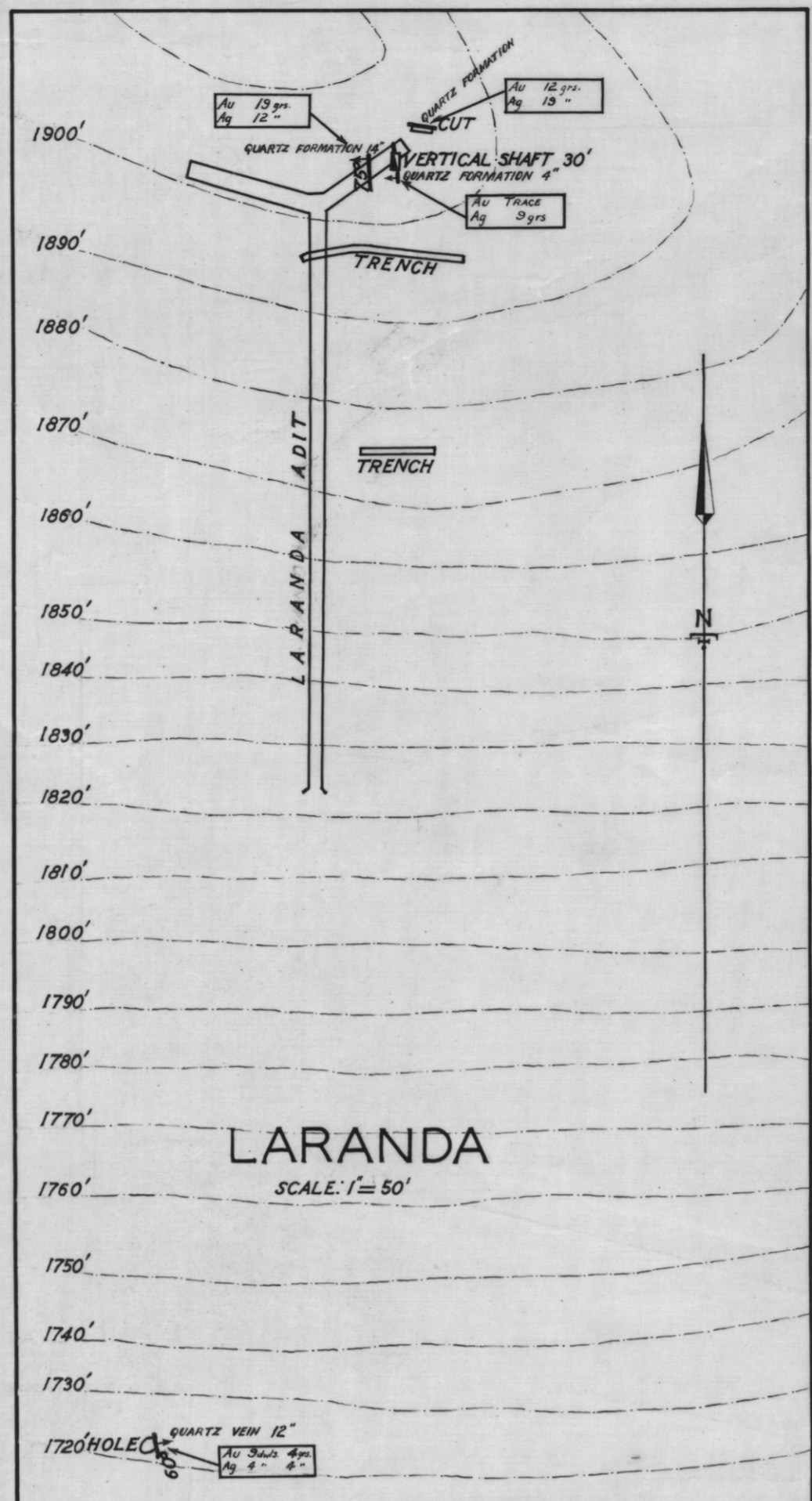
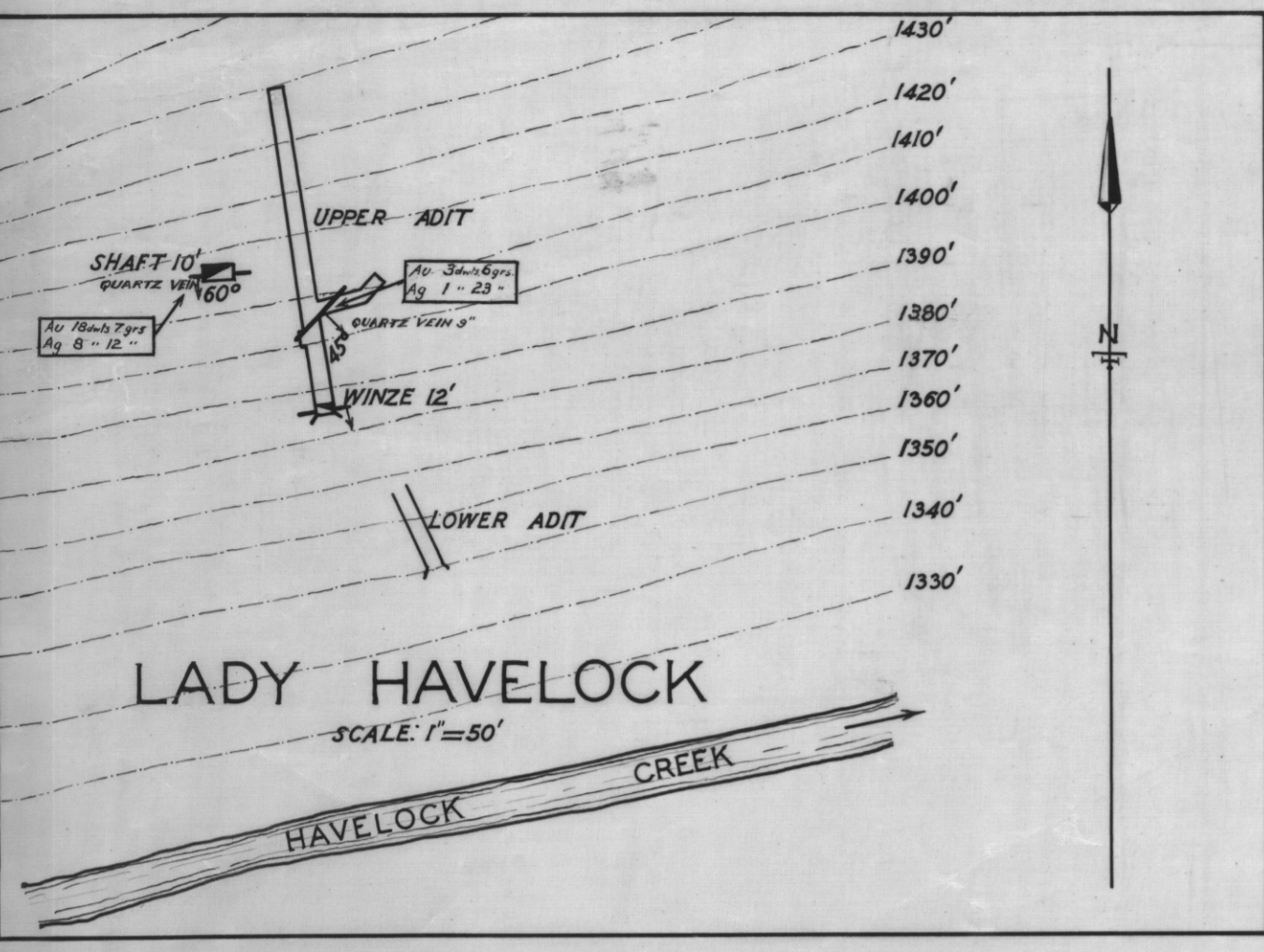

**DAN RIVULET GOLDFIELD**  
INDIVIDUAL WORKINGS SHEET 3

*Source: Hughes, B.Sc.*  
9. 9. 47

N.B. ALL CONTOUR INTERVALS 10'  
ALL HEIGHTS BASED ON RAILWAY LEVEL AT RINGAL STATION (754)