

5 cm

WATERS MEETING AREA

(AVOCA ROAD)

APPROX. SCALE: 1 IN. = 250 FT.

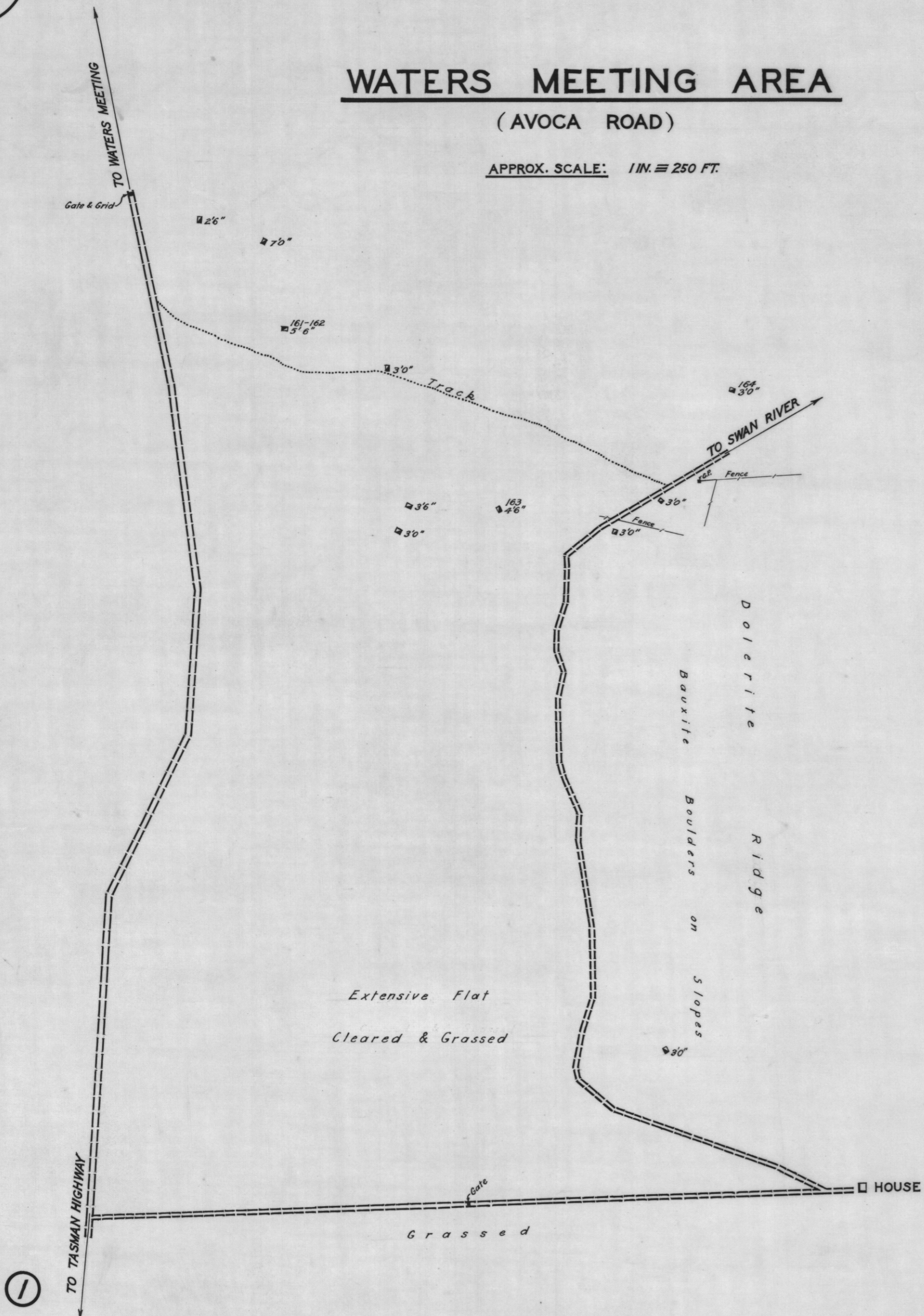

THE MILTON AREA

(MR GORDON AMOS)

APPROX. SCALE: 1 IN. = 250 FT.

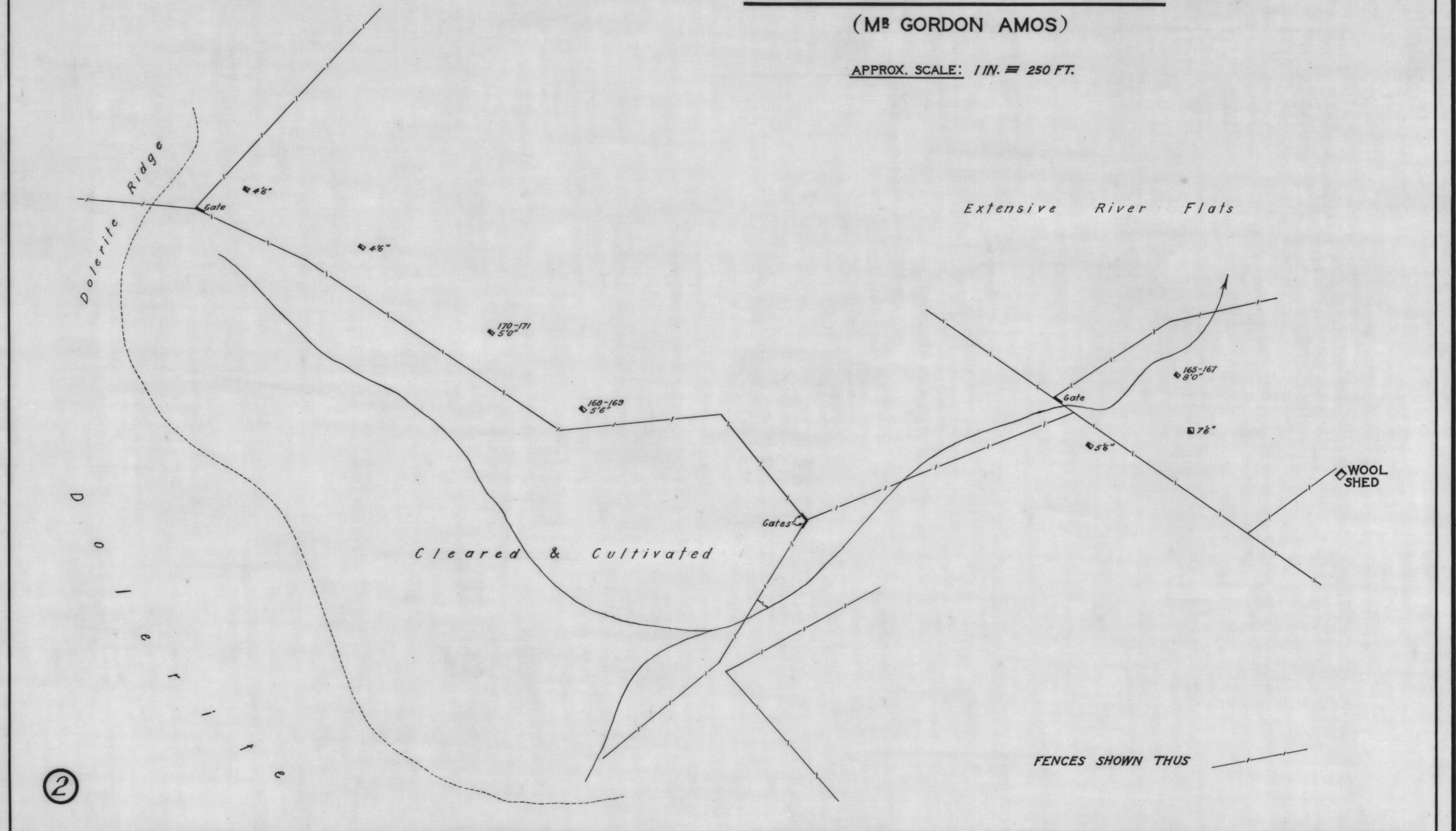

BAUXITE — SWANSEA AREA

SHOWING POSITION OF SHAFTS & SAMPLES

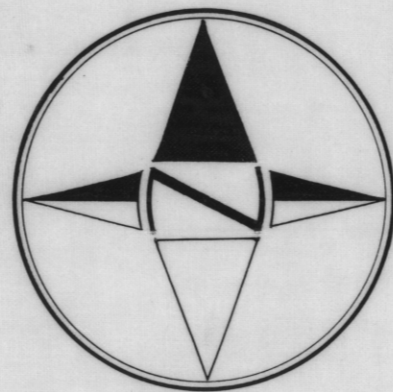

N.B. COMPASS AND PACE SURVEYS ONLY.

SEARLES AREA IS SHOWN ON LOCALITY PLAN AS ③.

SHAFTS Sample No. Shaft Depth

A. G. Reid M.Sc.
CHIEF GEOLOGIST
5 1949

DPT. OF MINES

RTR

LOCALITY PLAN

SCALE: 1 IN. = 1 MILE

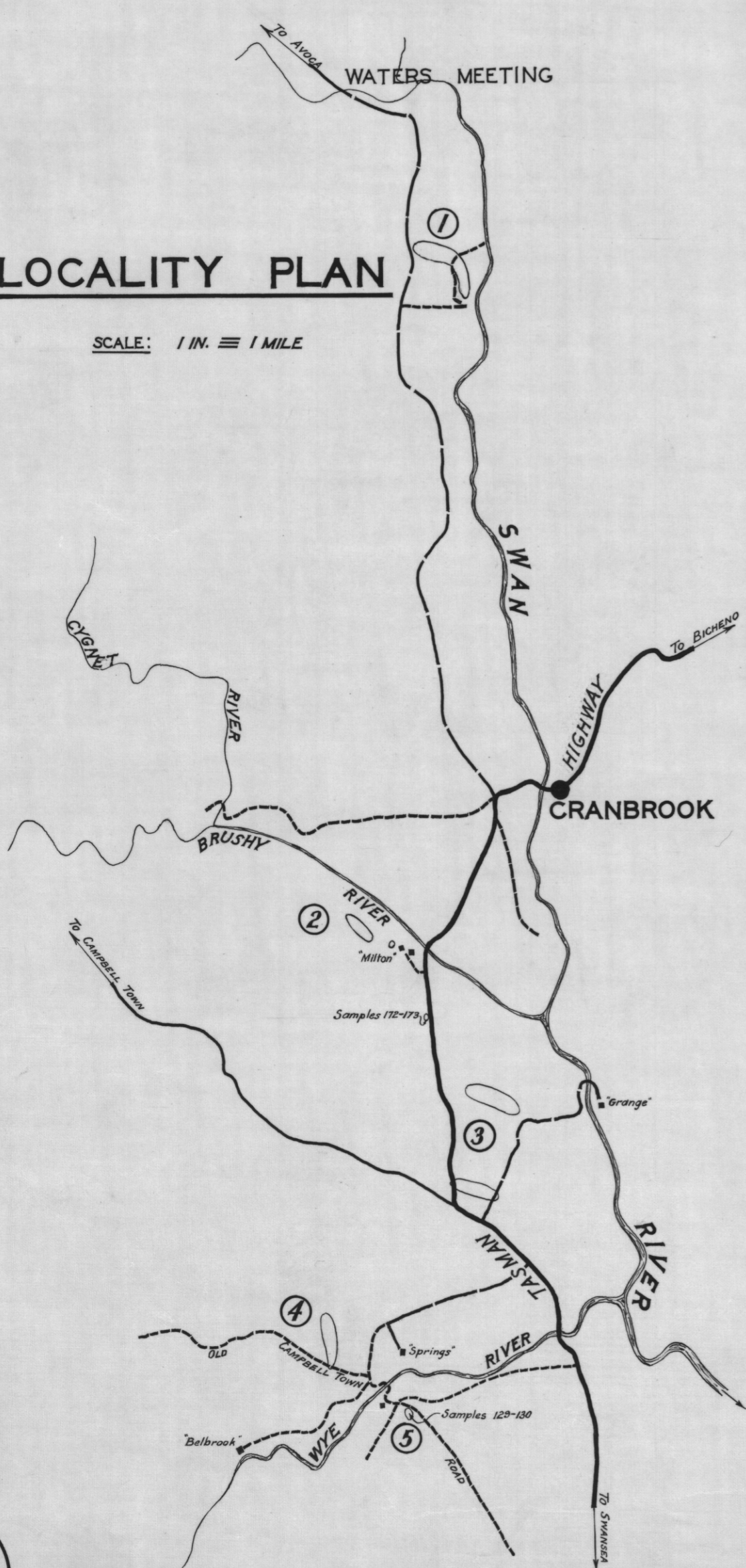

SIX MILE AREA

APPROX. SCALE: 1 IN. = 500 FT.

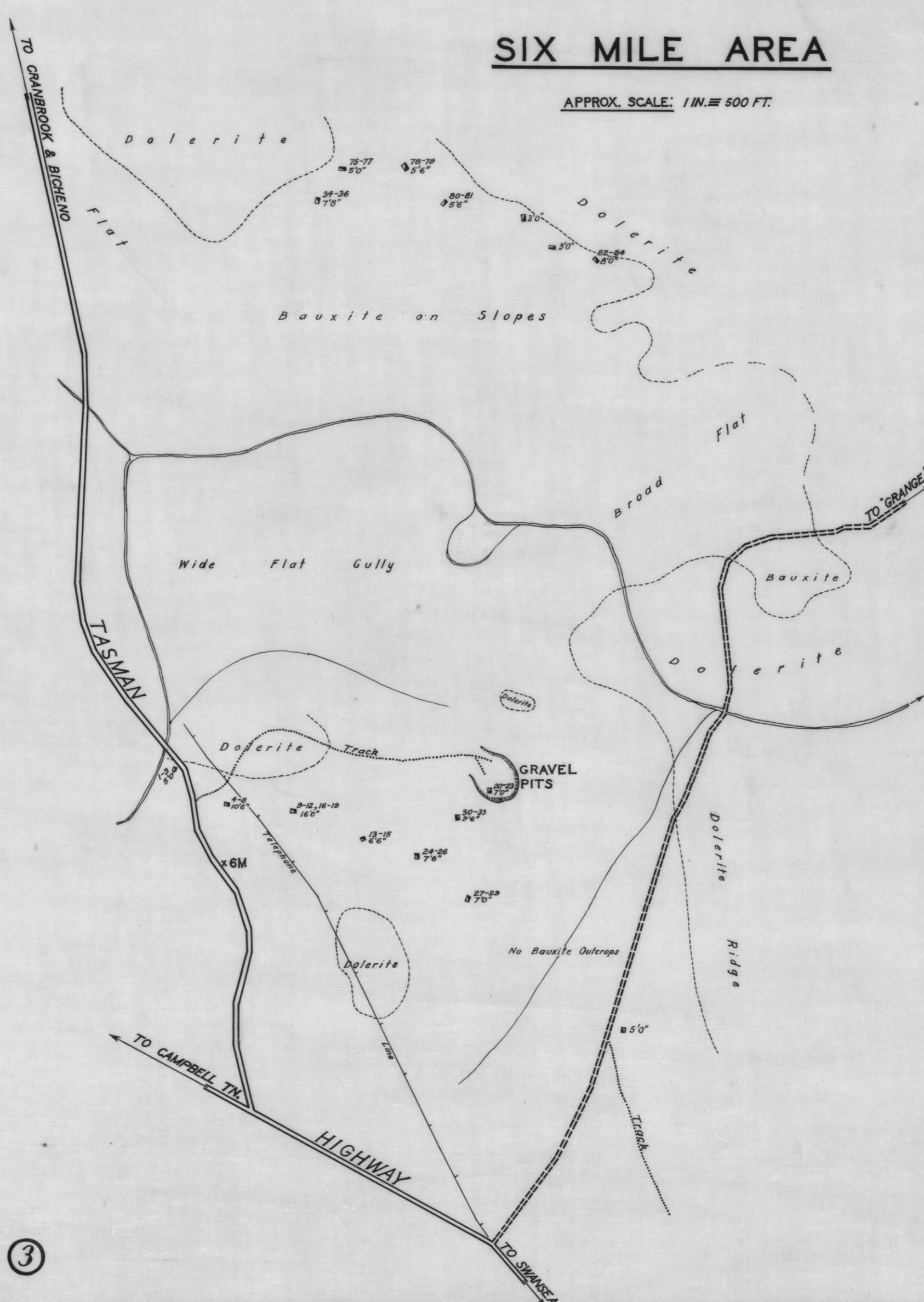

THE SPRINGS AREA

(MR BREWIS LYNE)

APPROX. SCALE: 1 IN. = 250 FT.

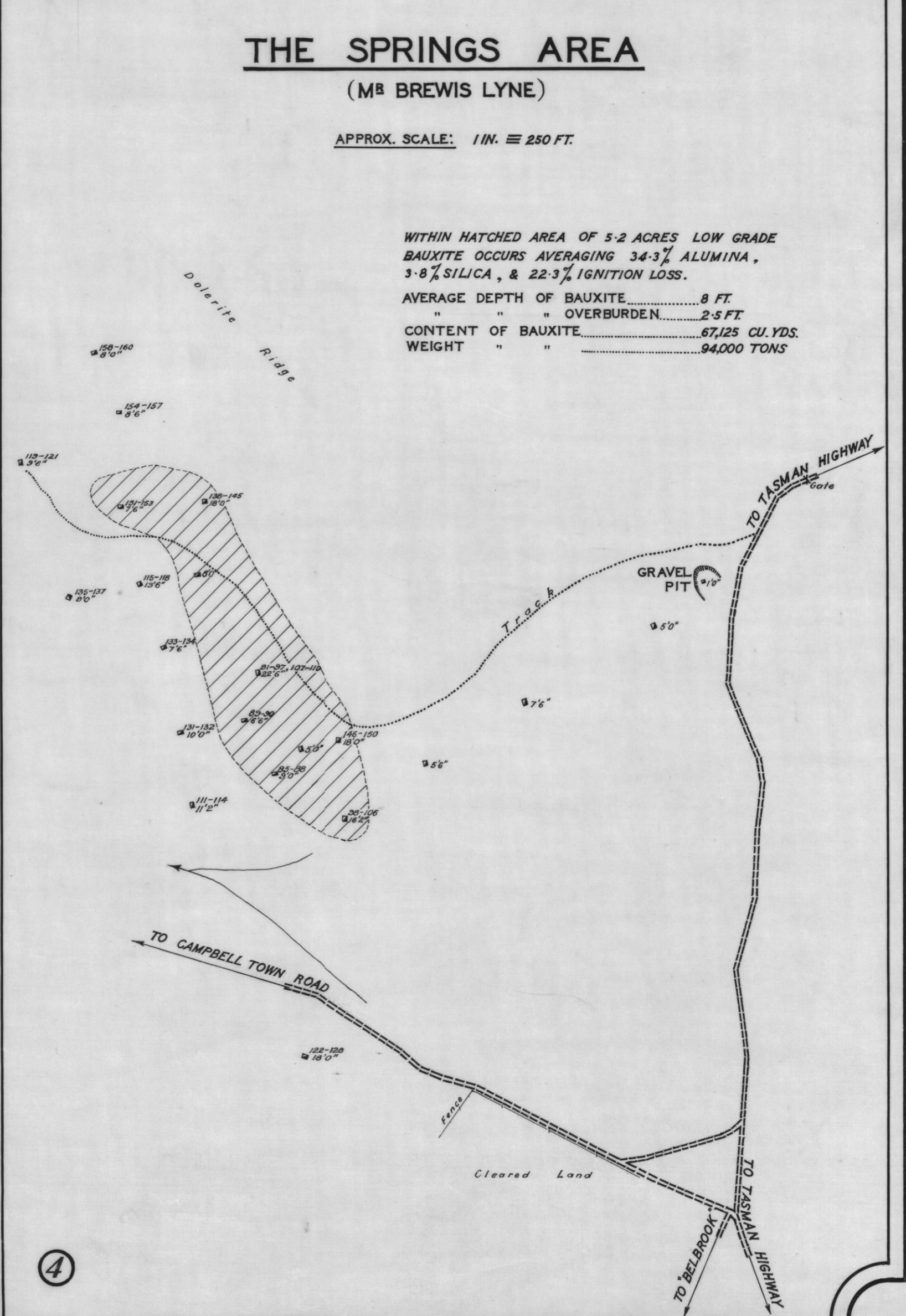

WITHIN HATCHED AREA OF 5.2 ACRES LOW GRADE
BAUXITE OCCURS AVERAGING 34.3% ALUMINA,
3.8% SILICA, & 22.3% IGNITION LOSS.
AVERAGE DEPTH OF BAUXITE 8 FT.
" " " OVERBURDEN 2.5 FT.
CONTENT OF BAUXITE 87,125 CU. YDS.
WEIGHT " " 94,000 TONS