

PROPOSED
CASCADE — BRANXHOLM RACE

SECTION II
 (443-509 CHAINS)

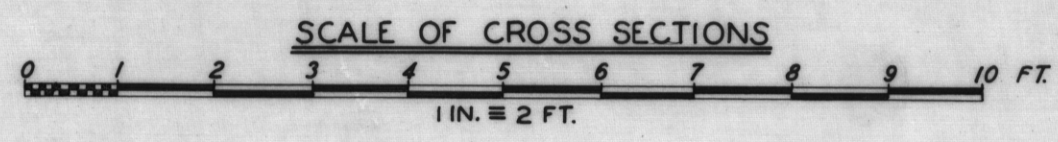

GRANITE BOULDERS.....
 TEST HOLES.....
 CHAINAGE PEGS.....
James O'Hughes.
 GEOLOGIST
 27. 9. 1949

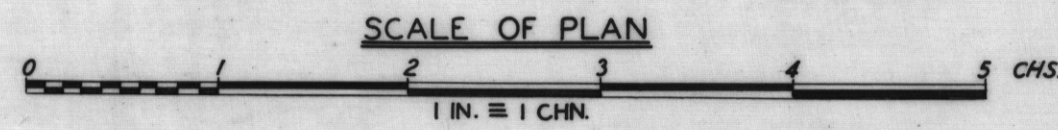
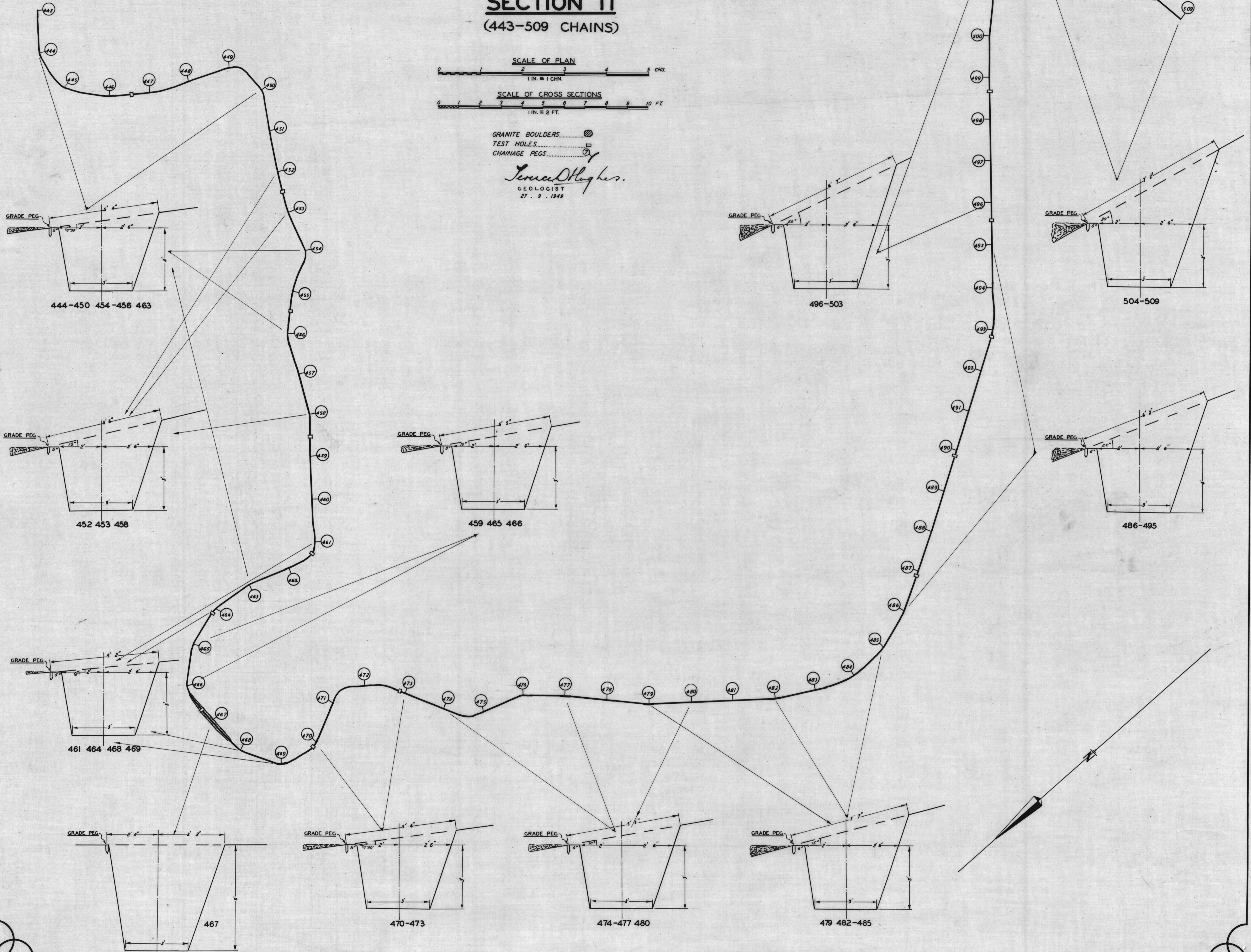

444-450 454-456 463

496-503

504-509

452 453 458

459 465 466

486-495

461 464 468 469

467

470-473

474-477 480

479 482-485

5 cm

1116

160