

1259A

332

5 cm

GEOLOGICAL SKETCH MAP CHUDLEIGH ESTATE

SCALE
0 10 20 30 40 CHNS.
1 IN. = 10 CHNS.

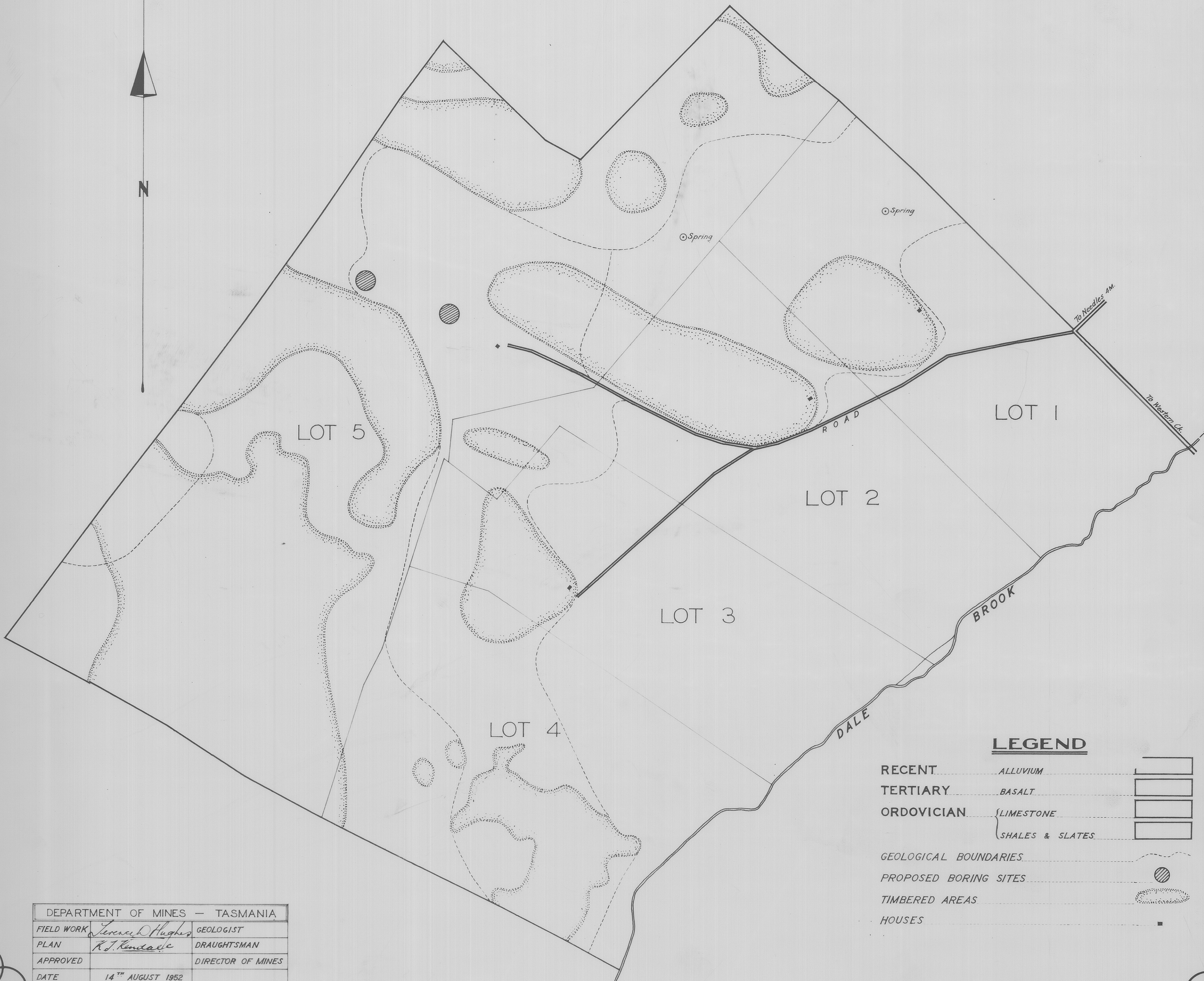

LEGEND

- RECENT ALLUVIUM
- TERTIARY BASALT
- ORDOVICIAN { LIMESTONE
- SHALES & SLATES
- GEOLOGICAL BOUNDARIES
- PROPOSED BORING SITES
- TIMBERED AREAS
- HOUSES

DEPARTMENT OF MINES — TASMANIA	
FIELD WORK	<i>Terence D. Hughes</i> GEOLOGIST
PLAN	<i>R. J. Kendall</i> DRAUGHTSMAN
APPROVED	DIRECTOR OF MINES
DATE	14 TH AUGUST 1952

1259-45