

LEONARD'S CLAY DEPOSIT BEACONSFIELD

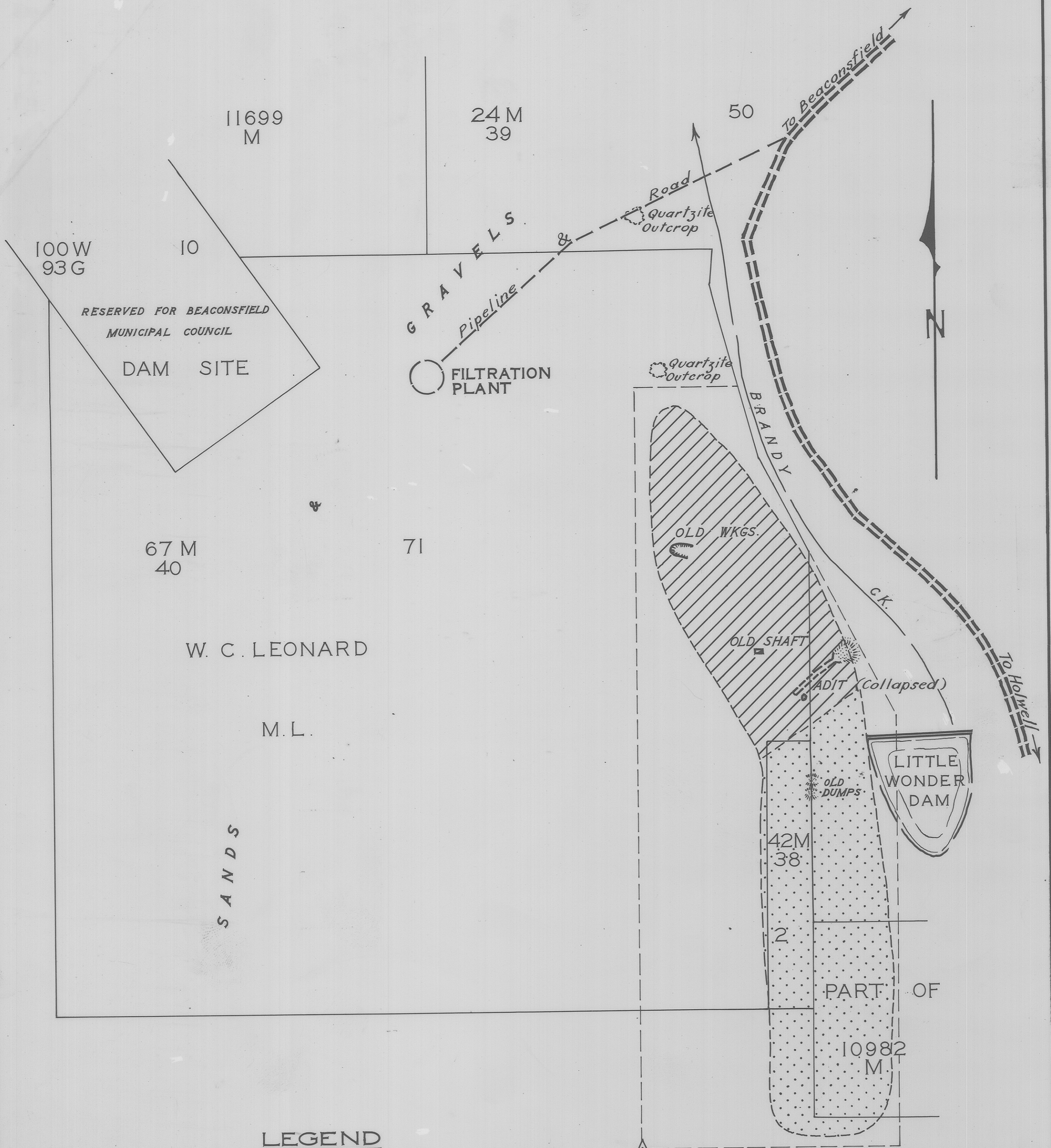
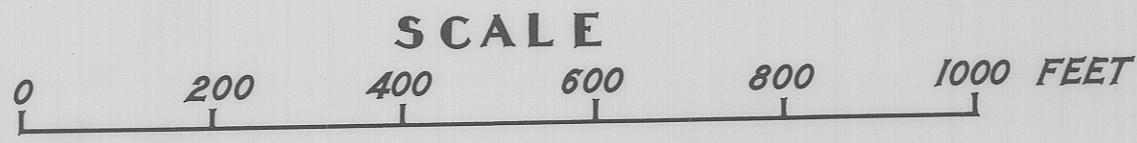

LEGEND

- GOOD CLAY DEPOSITS
- POORER CLAY MIXED WITH SAND
- SUGGESTED NEW LEASE

Terence O. Hughes
 SEN. GEOLOGIST
 24TH JUNE 1957

DEPT OF MINES
 1477-30

Reduce to 24 cm wide.