

5 cm

LIMESTONE AT PULBEENA

BORING FOR A. PEARSON

NOTE The original plan showed only Bores completed by Mines Dept. The outline of the two pits & gantry have been added from a sketch supplied by Mr. A. Pearson. Bores completed by Mr. A. Pearson have been added from the sketch supplied to him by his men. Sections drawn on Bore Holes are based on data supplied and not on departmental information.

0 3 6 CHS.

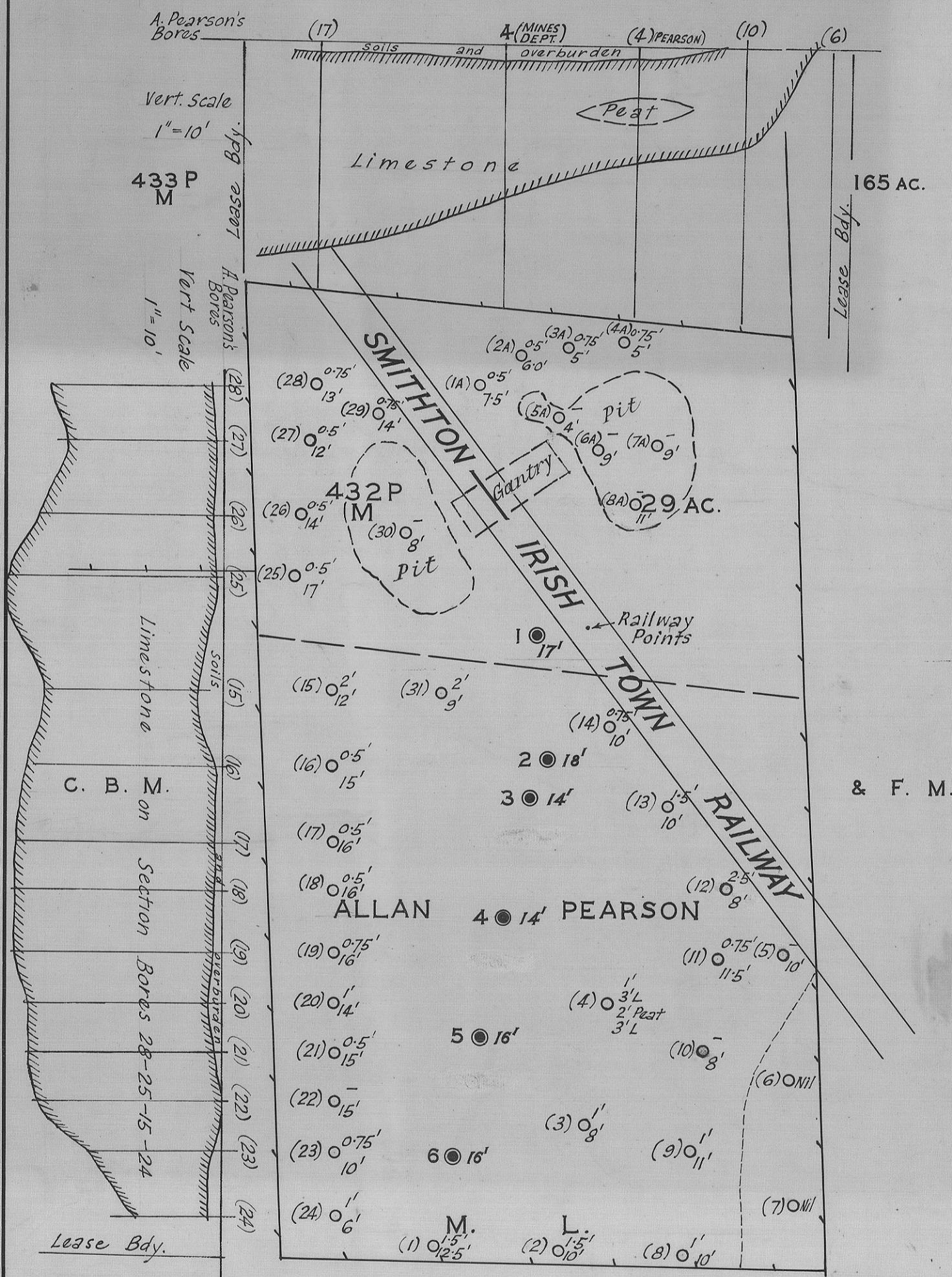

BORE SECTIONS

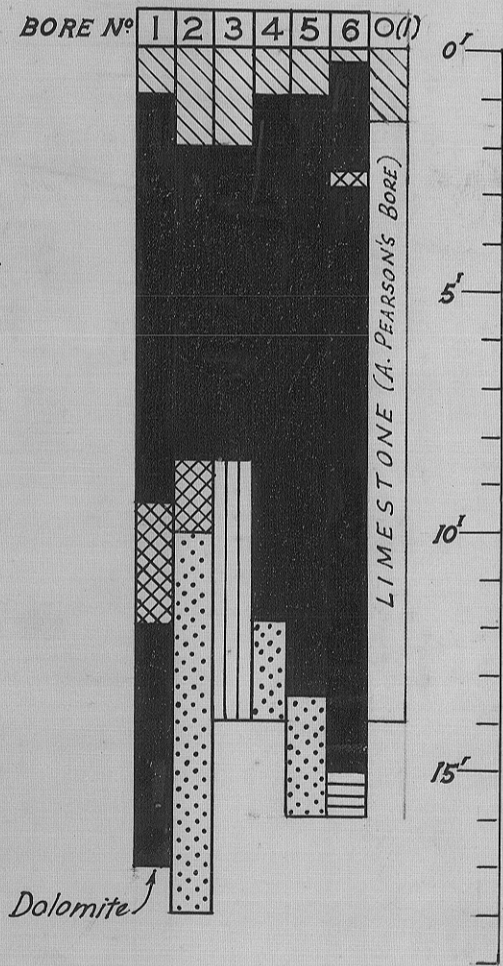

- BLACK PEAT & SOIL
- LIMESTONE
- BLACK SAND
- BLACK PEAT
- BLACK PEAT & SAND
- CLAY OR CEMENTED GRAVEL
- BORES (by Mines Dept.)
- BORES (by A. Pearson)

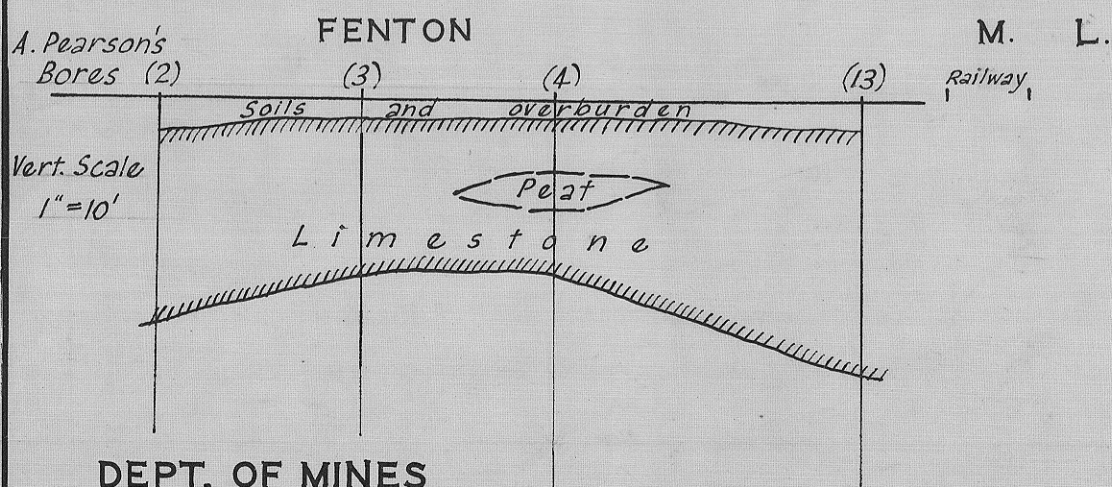

DEPT. OF MINES
1515-21

H. Enkeid M.Sc., M.A.I.M.M.
CHIEF GEOLOGIST 27.9.57