

5 cm

DISTRICT OF STORY CREEK VICINITY OF ABERFOYLE

Scale 200 feet to 1 inch



10184 21ac
M
B.C. Lutwyche
& J. Richards

10183
M
4.0ac

B.C. Lutwyche & J. Richards

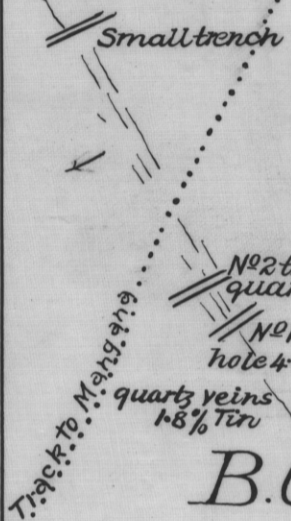

No 1 trench
hole 4.6 ft deep
quartz veins 1.8% tin

Shaft 14 feet deep. Bulk sample of
Lode 0.75% tin

Old tunnel 156 ft long

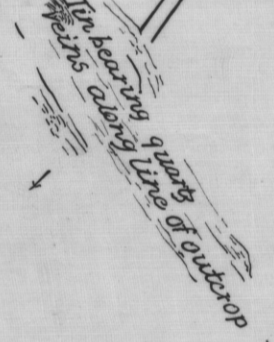

Tin bearing quartz veins

Tin bearing quartz veins

Plan showing locality on scale of 200 ft to 1 inch

trench with tin-bearing quartz veins

Small outcrop of tin-bearing quartz veins at foot of cliff

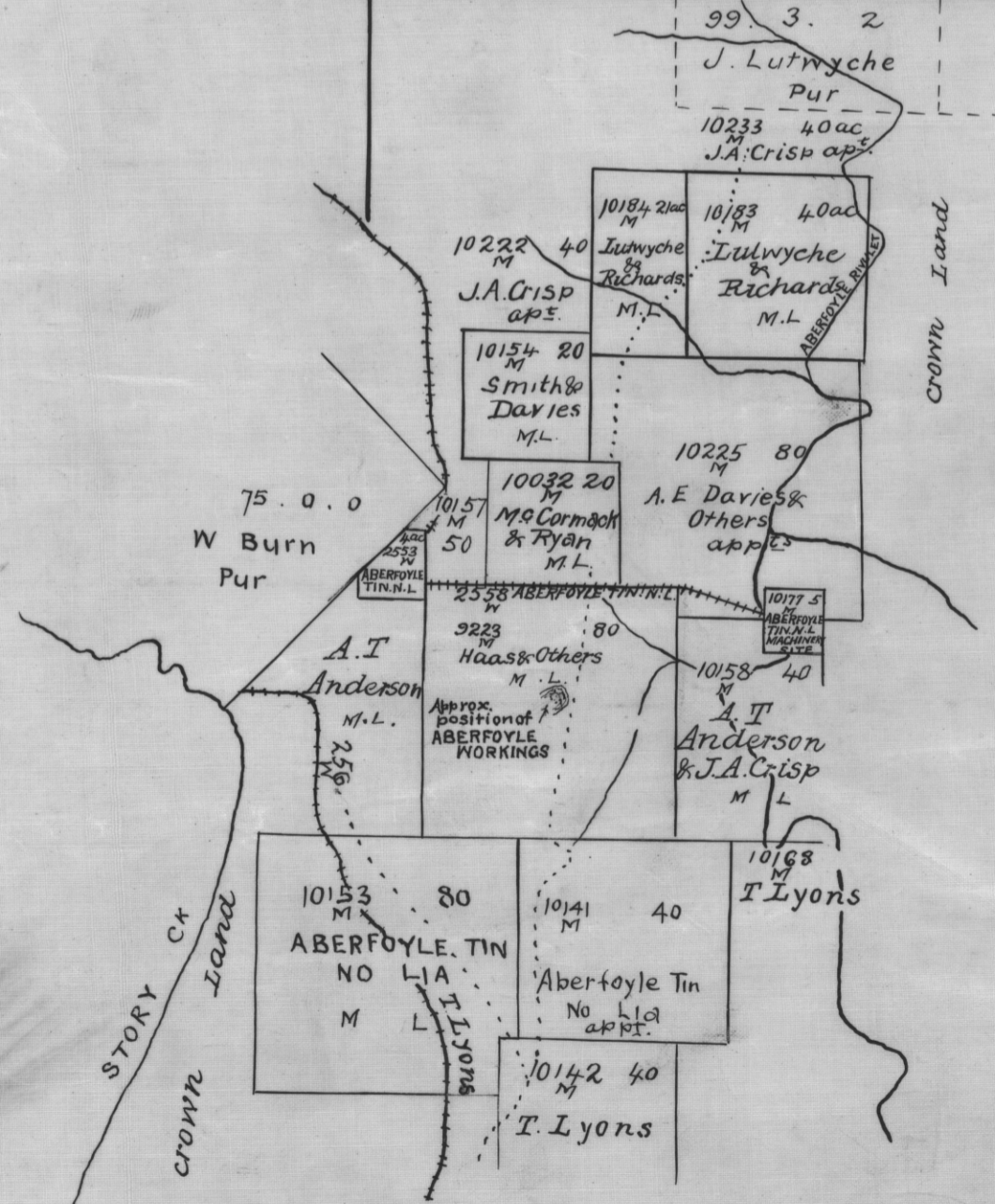

J.B. Scott
State Mining Engineer
14-12-27