

LOCALITY MAP  
SAVAGE RIVER - MAIN SOUTH IRON DEPOSIT.

0 400 800 FT.

5 cm

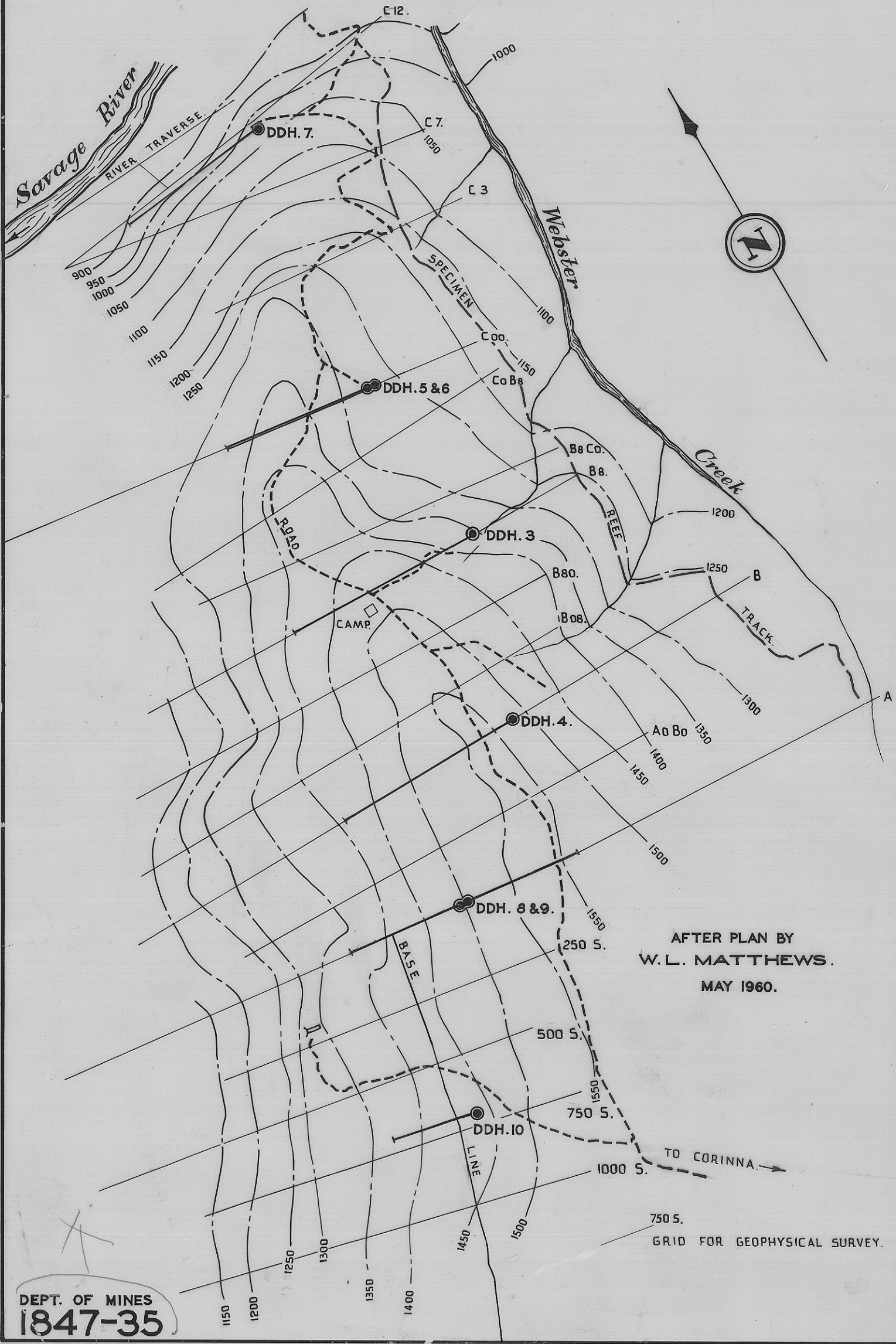

AFTER PLAN BY  
W.L. MATTHEWS.  
MAY 1960.

750 S.  
GRID FOR GEOPHYSICAL SURVEY.

DEPT. OF MINES  
1847-35

875

1847

4" col.