

1880

900

5 cm

TIN MINE - TIN SPUR

(REECE & THOMAS)

0 50 100 FT.

SAMPLE No.	% Au.	% Ag	% Sn	% Pb	% Mn	% Fe	% Zn.
1	.	.	0.22
2
3	.	.	0.3	.	TRACE	14.8	0.2
4	.	TRACE	TRACE	TRACE	TRACE	2.6	0.2
5	.	"	7.9	"	"	15.7	0.1
6	.	"	0.1	.	"	11.6	0.2
7	.	"	3.95	0.1	"	10.7	.
8	.	.	TRACE
9	.	.	5.6	TRACE	.	.	.

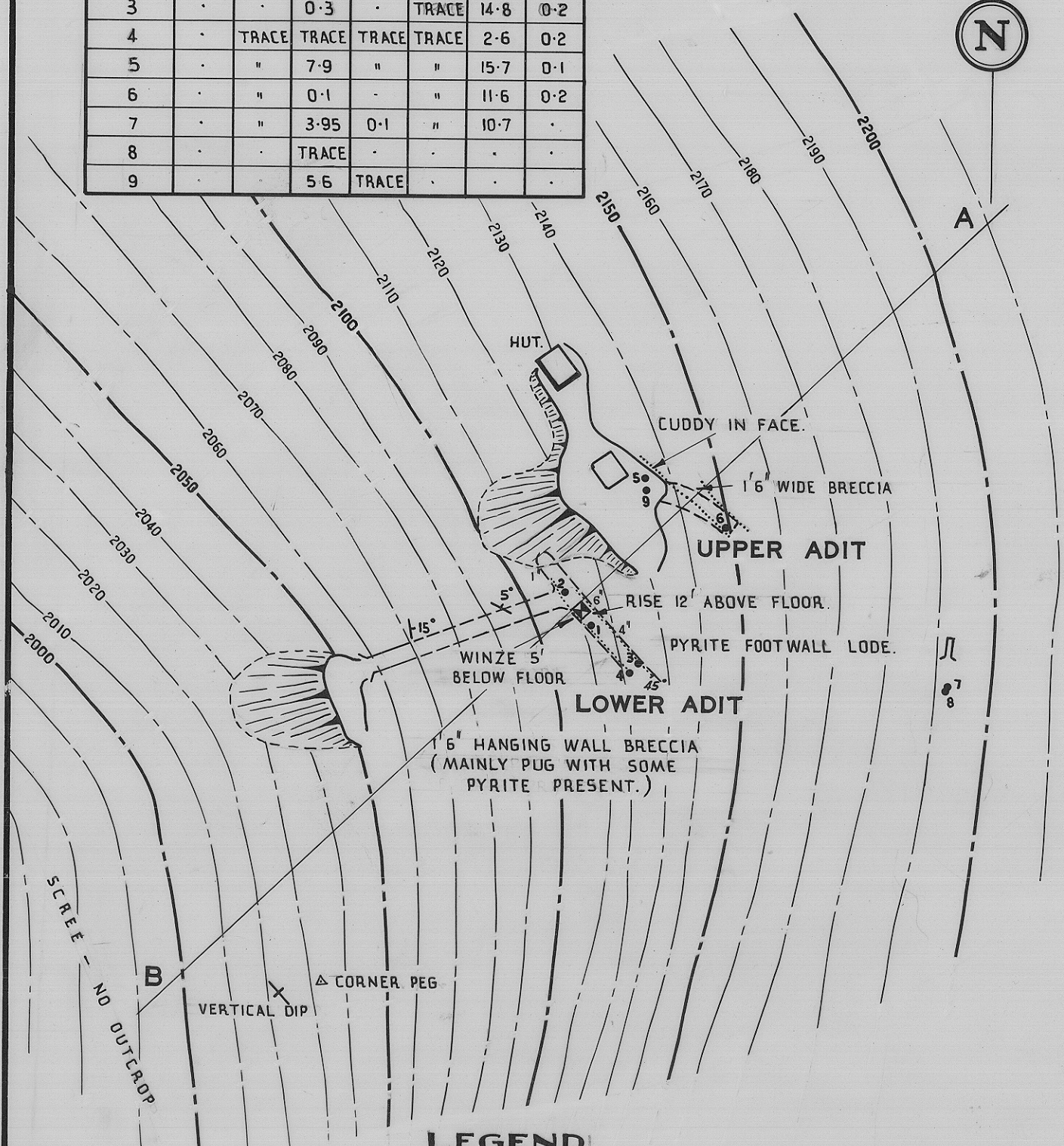
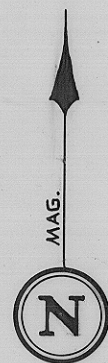

LEGEND

- LODE.
- SAMPLE LOCALITY.
- 45° UNDERGROUND DIP.
- 15° SURFACE DIP.

R.G. ROBINSON
GEOLOGIST 1958.