

212/33

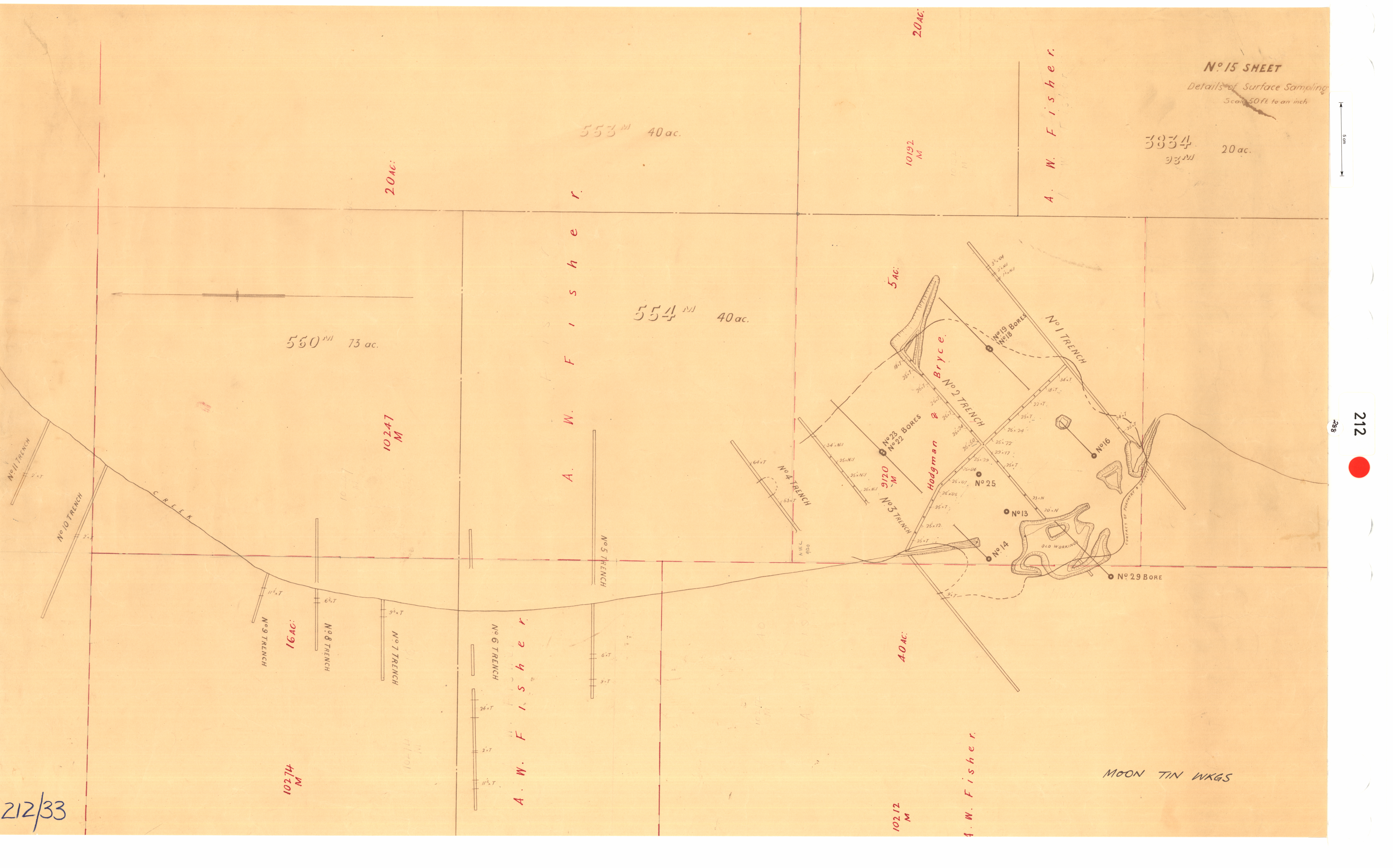

553^M 40 ac.

10192^M

3834^M 20 ac.

20 ac.

A. W. Fisher.

550^M 73 ac.

554^M 40 ac.

10247^M

A. W. Fisher.

5 ac.

40 ac.

10212^M

A. W. Fisher.

MOON TIN WKS

No 11 TRENCH

No 10 TRENCH

CREEK

No 9 TRENCH

No 8 TRENCH

No 7 TRENCH

No 6 TRENCH

No 5 TRENCH

No 4 TRENCH

No 3 TRENCH

No 2 TRENCH

No 1 TRENCH

Hodgman & Bryce

9120^M

No 23 BORES

No 22 BORES

No 25

No 14

No 13

No 16

No 19 BORES

No 18 BORES

No 29 BORE

OLD WORKING

CONTACT OF MOUNTAIN & PLAIN