

2502

543

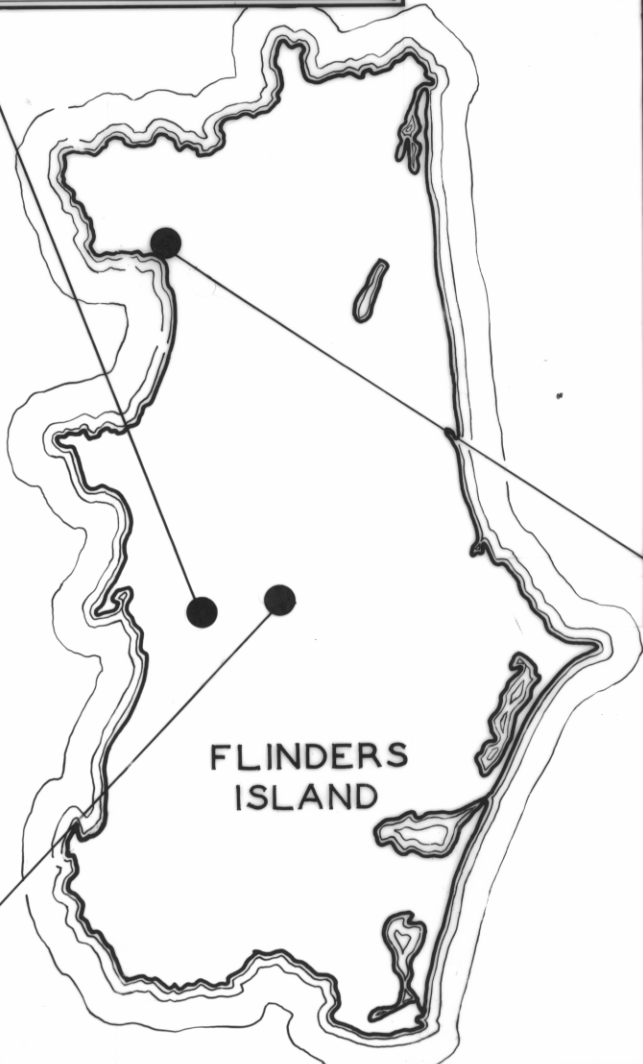
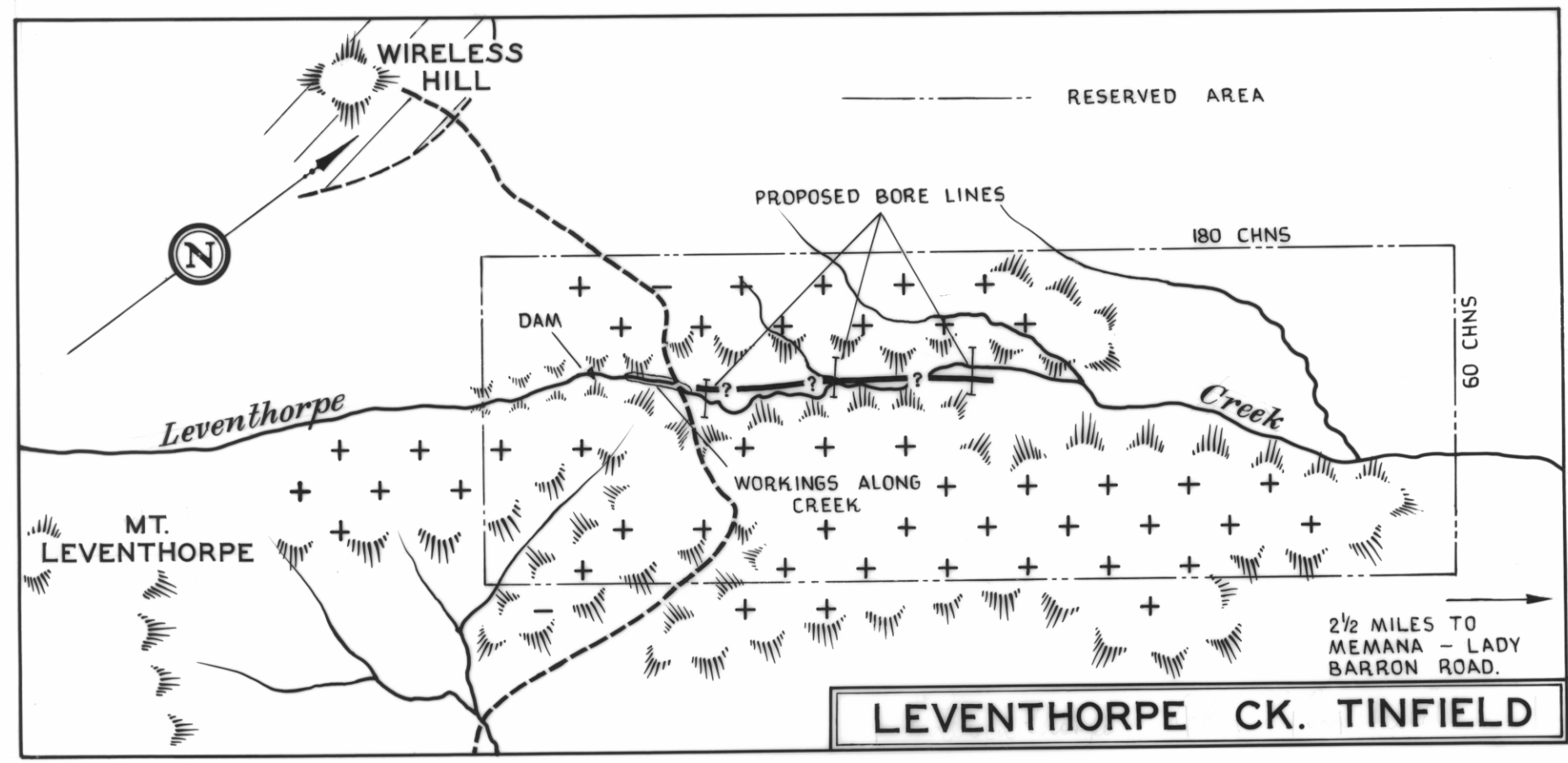
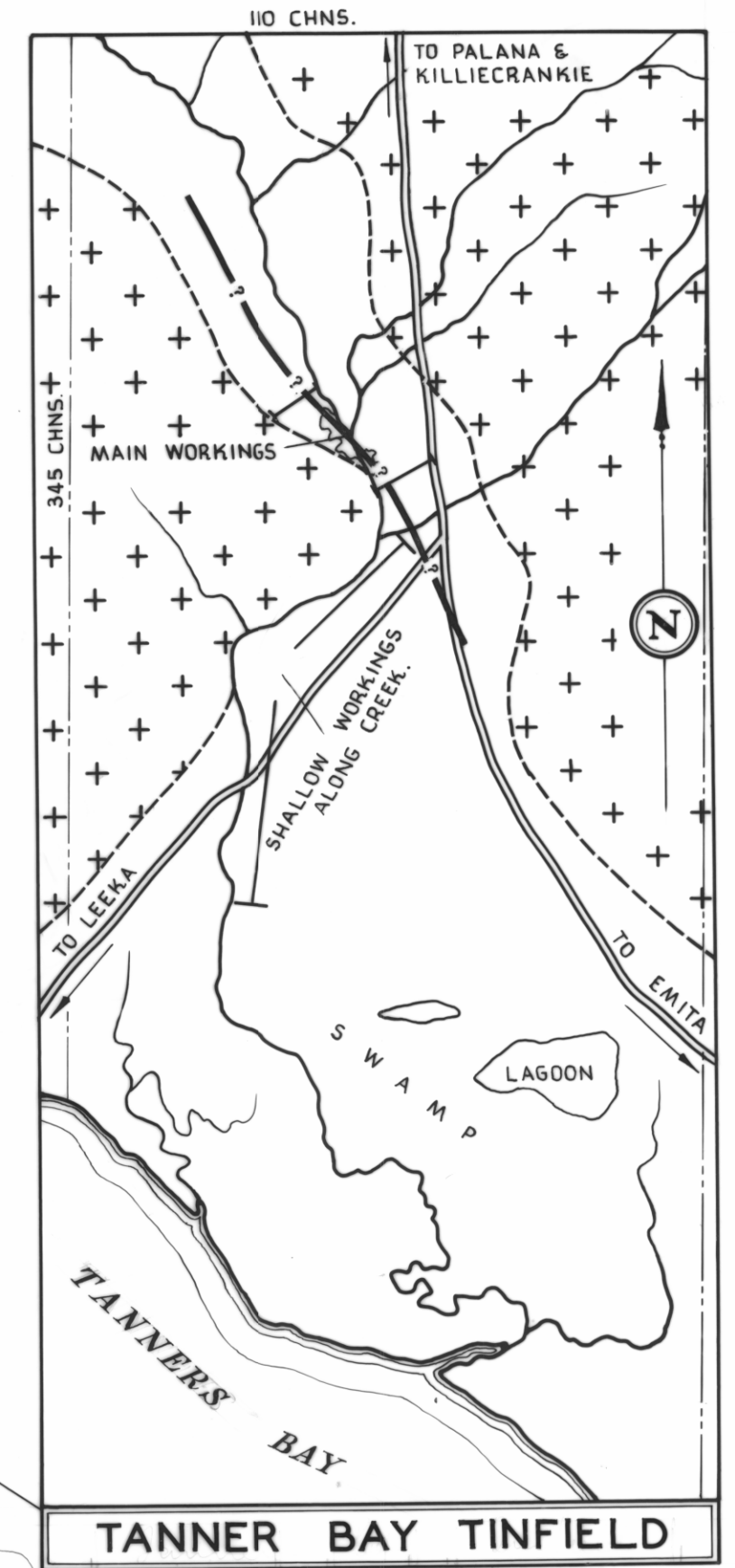
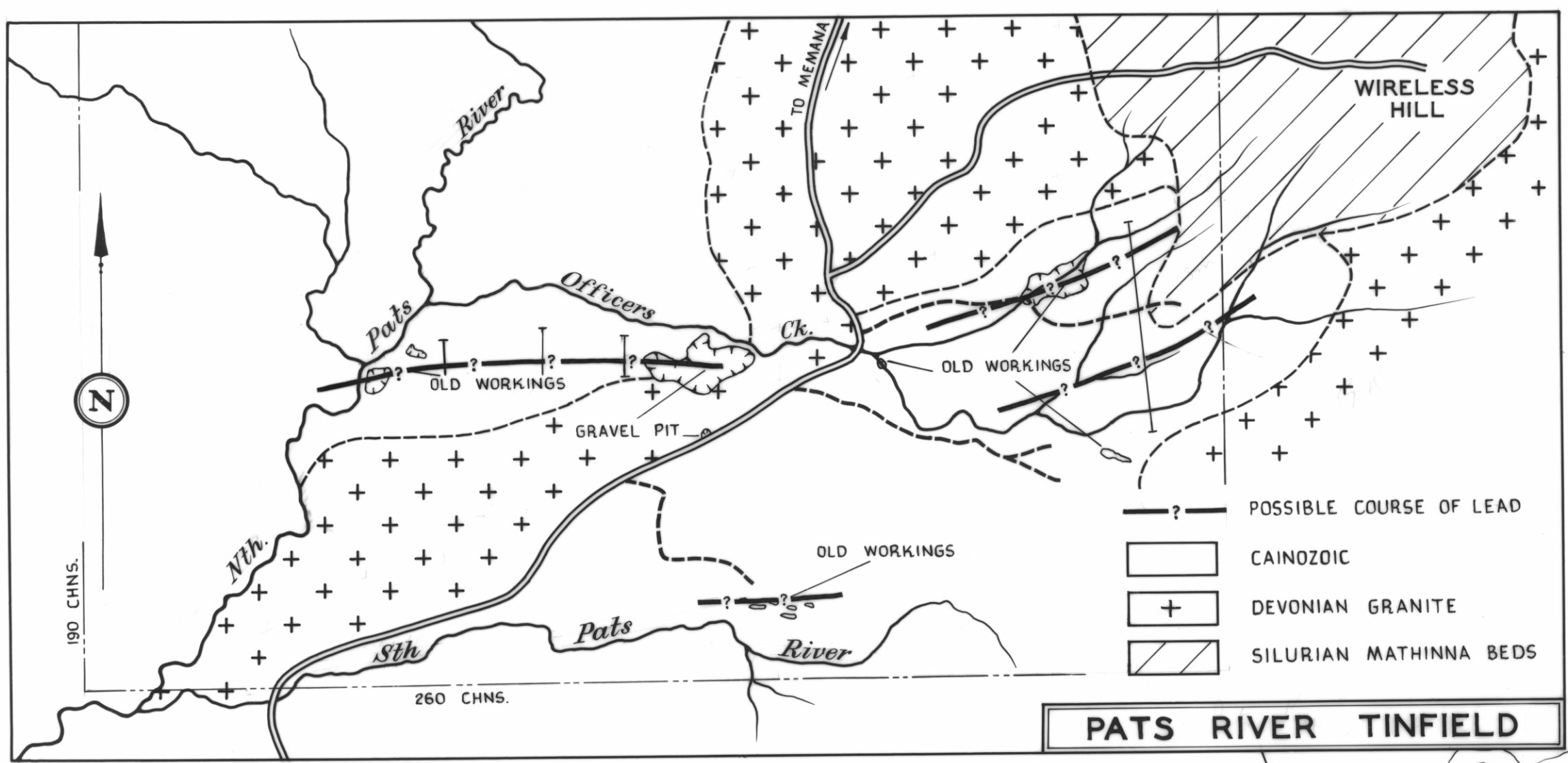

5 cm

DEPARTMENT OF MINES - TASMANIA	
ALLUVIAL TIN WORKINGS FLINDERS ISLAND	
DATE <i>December '64</i>	SCALE CHS. 0 30
GEOLOGIST <i>R. Jack</i>	SURVEYOR
DRAUGHTSMAN <i>R. Nankivell</i>	MAP SHEET & NO. <i>9, 9a, 12.</i>
REVISIONS	FILE NO. 2502-12

115 of revised