

GOVERNMENT BORING PLANT GLADSTONE.

DR MALLINSON'S SECTION No 7298 20 ACRES

260/25

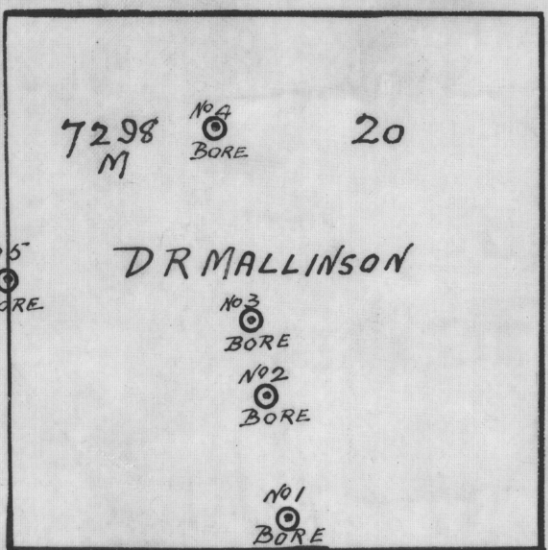
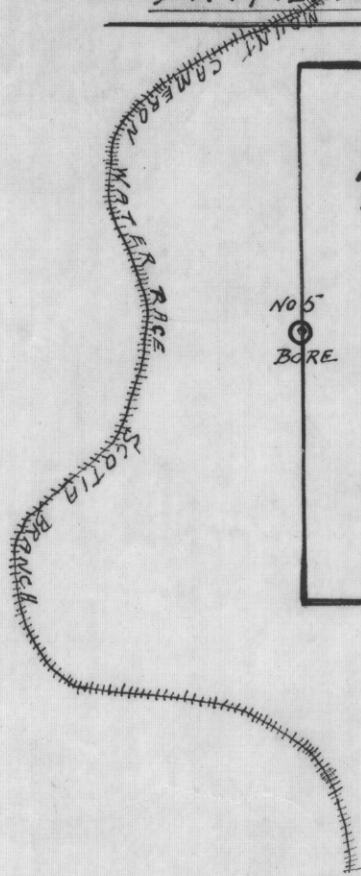

SCALE

16 INCHES TO ONE MILE

PARTICULARS

| No 1 BORE | | No 2 BORE | | No 3 BORE | | No 4 BORE | | No 5 BORE | |
|----------------|--------|---------------|--------|----------------|--------|----------------|--------|----------------|--------|
| MATERIAL | DEPTH | MATERIAL | DEPTH | MATERIAL | DEPTH | MATERIAL | DEPTH | MATERIAL | DEPTH |
| SURFACE | 2' 6" | SURFACE | 2' 0" | SURFACE | 2' 6" | SURFACE | 2' 6" | SURFACE | 6" |
| CEMENT | 6" | CEMENT | 6" | CEMENT | 4' 6" | CEMENT | 1' 0" | SAND | 7' 6" |
| WHITE DRIFT | 10' 0" | GRAVEL | 12' 6" | DRIFT | 42' 0" | WHITE DRIFT | 16' 6" | GRAVEL | 2' 0" |
| WHITE GRAVEL | | GRAVEL | | PUG | 3' 0" | GRAVEL | | GRAVEL | |
| SMALL WASH | 4' 0" | PUG | 1' 0" | DRIFT | 3' 6" | PUG | 1' 6" | CLAYEY | 1' 0" |
| PUGGY DRIFT | 3' | WHITE | | BROWN | | WHITE GRAVEL | 5' 6" | GRAVEL | |
| GRAVEL | | SAND (TIGN) | 2' 0" | SEDEMENT | 2' 0" | PUG | | DRIFT | 30' 0" |
| PUG | 4' 6" | WHITE DRIFT | 2' 0" | GRAVEL | 2' 6" | DECAYED | | PUG | 2' 6" |
| WHITE DRIFT | 2' 6" | PUG | 6" | SEDEMENT | | TIMBER | 1' 6" | | |
| RED GRAVEL | 1' | GRAVEL | 7' 0" | GRAVEL | 2' 6" | GRAVEL | | | |
| GRAVEL | | PUG | 4' 0" | BROWN | | SEDEMENT | | | |
| HARD SEDEMENT | 2' 0" | GRAVEL | 12' 0" | SEDEMENT | 4' 0" | DECAYED | | | |
| GRAVEL | | HARD BROWN | | | | TIMBER | 10' 6" | | |
| DECOMPOSED | | SEDEMENT | 6' 0" | | | PUG | | | |
| TIMBER | 8' 6" | GRAVEL | 3' 6" | | | DECAYED | | | |
| GRAVEL | 4' 0" | BROWN | | | | TIMBER | 1' 0" | | |
| PUG | | SEDEMENT | 1' 6" | | | DRIFT | | | |
| DECOMPOSED | | SOFT SLATE | | | | DECAYED | | | |
| TIMBER | 17' 6" | BOTTOM | 1' 6" | | | TIMBER | 5' 0" | | |
| SMALL WASH | | | | | | PUG | 2' 6" | | |
| PYRITIES | 3' 0" | PYRITIES | | | | DRIFT | 1' 0" | | |
| SEDEMENT | | IN LAST | | | | PUG | 1' 6" | | |
| PYRITIES | 2' 0" | PORTION | | | | DRIFT | 2' 0" | | |
| | | OF BORE | | | | PUG | | | |
| | | | | | | GRAVEL | 8' 0" | | |
| TOTAL DEPTH | 65' 0" | | 56' 0" | | 66' 6" | | 60' 0" | | 42' 6" |
| UNBOTTOMED | | BOTTOMED | | UNBOTTOMED | | UNBOTTOMED | | UNBOTTOMED | |
| NOT SUFFICIENT | | ON SOFT SLATE | | NOT SUFFICIENT | | NOT SUFFICIENT | | NOT SUFFICIENT | |
| PLANT | | | | PLANT | | PLANT | | | |
| VALUE TRACES | | VALUE TRACES | | VALUE TRACES | | VALUE TRACES | | VALUE TRACES | |

ROUGH SKETCH PLAN

Barry J. Roady

FOREMAN

28.10.1916.



THE LESSEE OF THIS SECTION WANTED THE GROUND BORING TO ABOUT 50 FEET ONLY. NOT BEING ABLE TO TREAT IT TO A GREATER DEPTH.

WITH THE AMOUNT OF PLANT ON HAND WE COULD NOT BORE ANY DEEPER THAN THE ABOVE DEPTHS.

I STRONGLY RECOMMEND THAT THIS GROUND BE BORED TO BEDROCK WITH SEVERAL LINES OF BORES

IN MY OPINION THE DEPTH TO BEDROCK IS FROM 60 TO 100 FEET.

9604

260

330