

2822

669

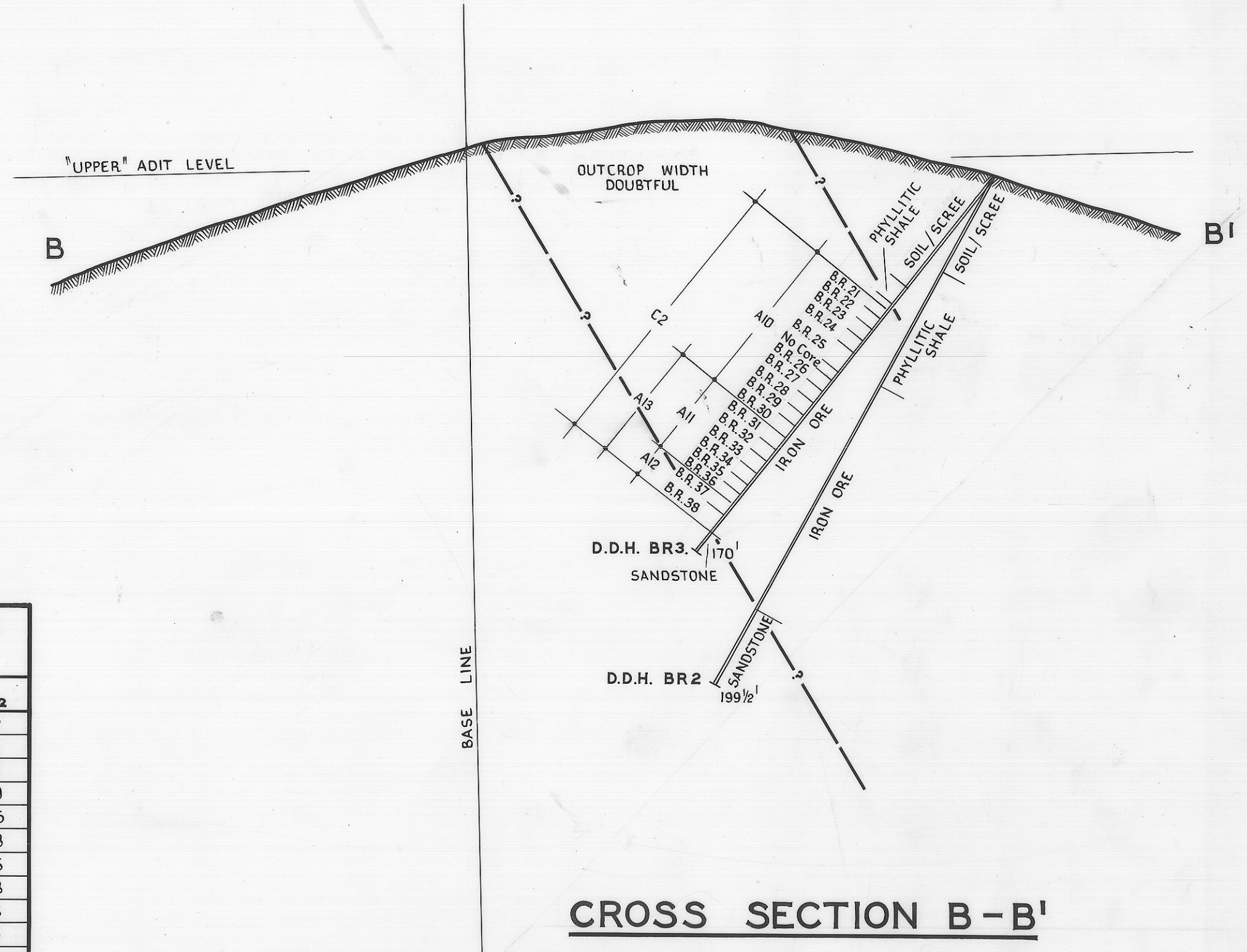
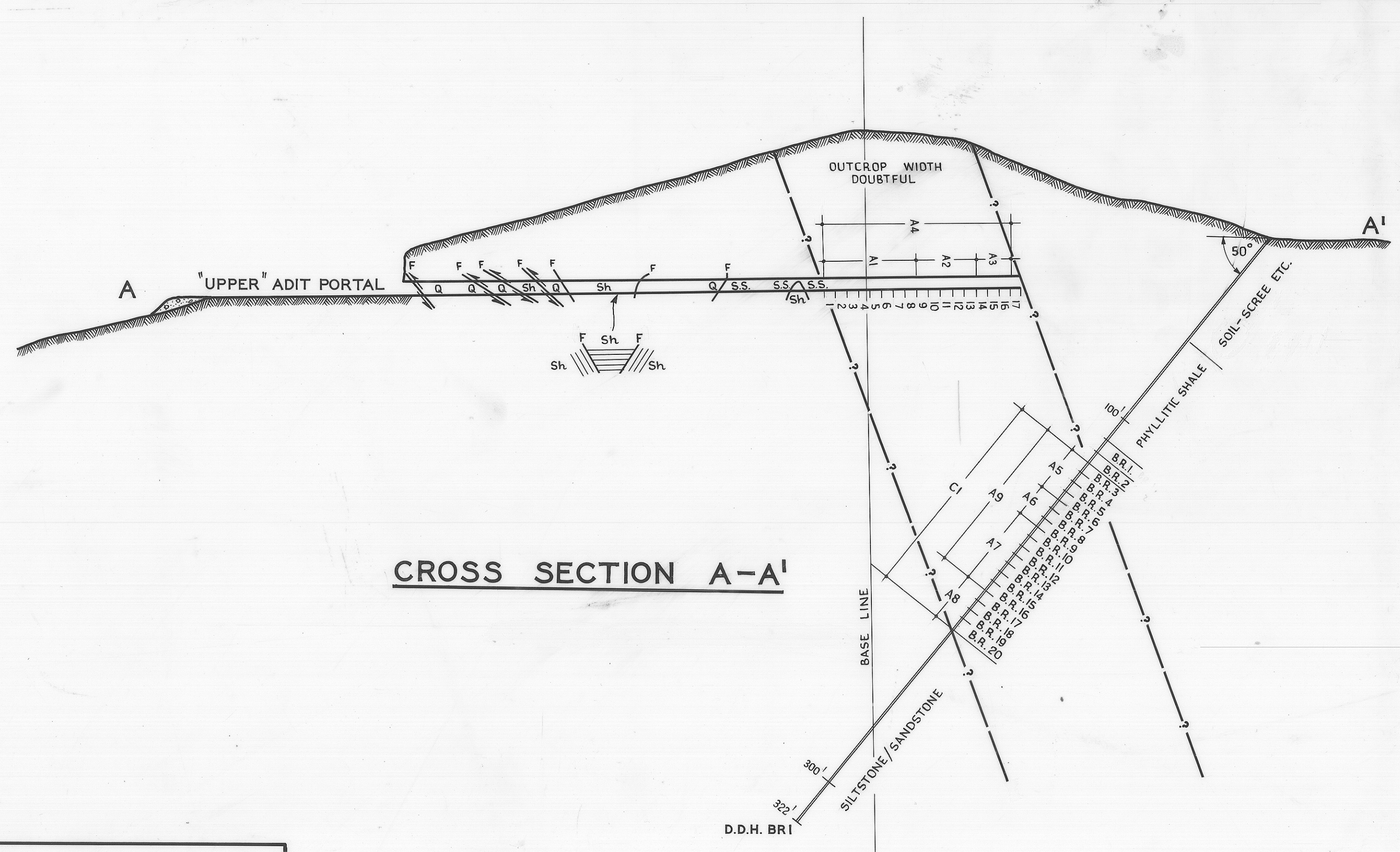
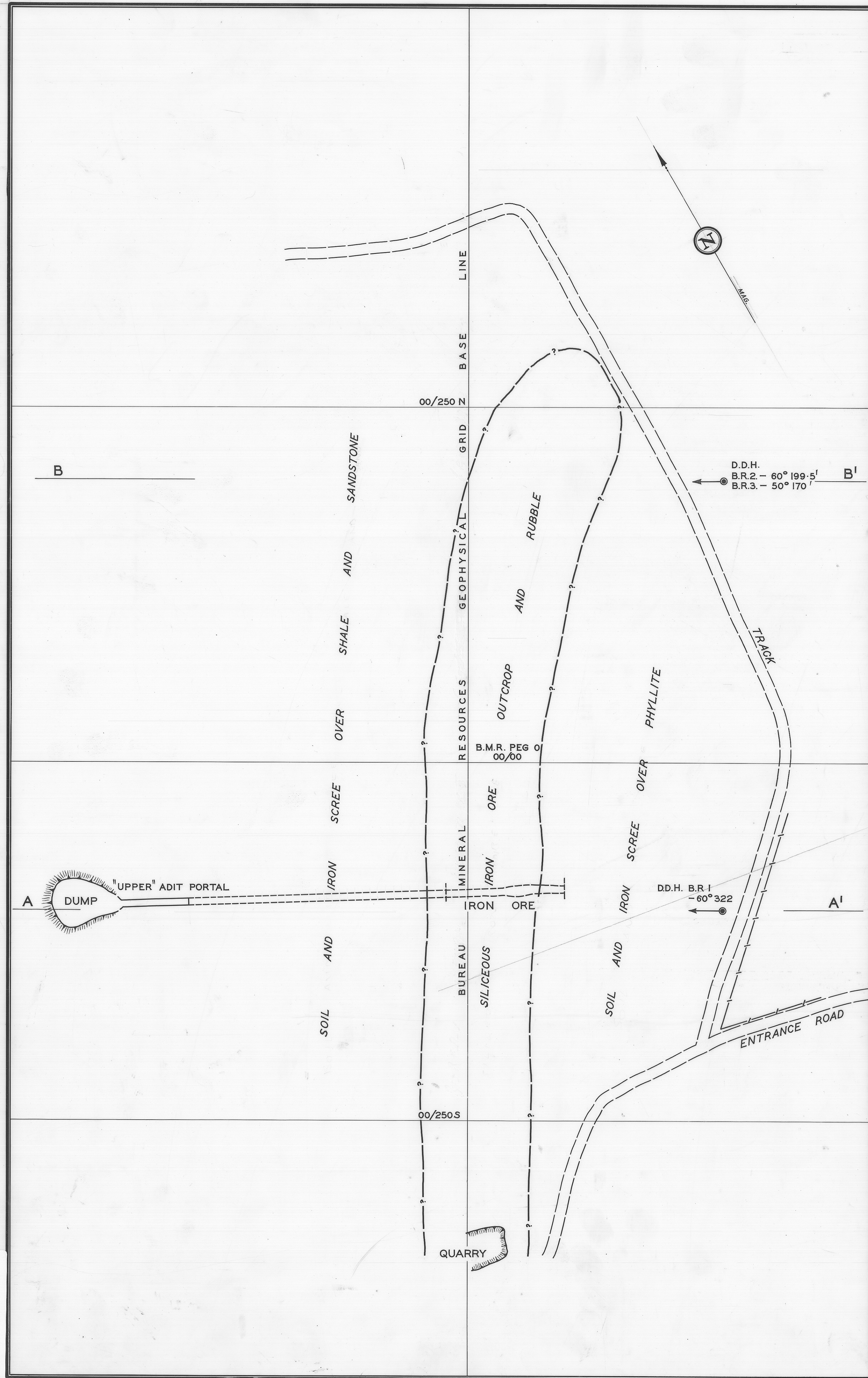

DIAMOND DRILL CORE SAMPLES

HOLE N°	SAMPLE N°	FROM	TO	% Fe	% S ₁ O ₂
DDH. B.R. 1	B.R. 1	110'-10"	118'-0"	8.17	83.9
	B.R. 2	118'-0"	124'-3"	9.58	85.8
	B.R. 3	124'-3"	129'-3"	55.0	21.2
	B.R. 4	129'-3"	134'-3"	58.2	12.2
	B.R. 5	134'-3"	139'-3"	60.1	13.2
	B.R. 6	139'-3"	144'-3"	64.0	6.7
	B.R. 7	144'-3"	149'-3"	25.7	60.2
	B.R. 8	149'-3"	154'-3"	21.7	68.7
	B.R. 9	154'-3"	159'-3"	29.5	57.6
	B.R. 10	159'-3"	164'-3"	45.7	32.6
	B.R. 11	164'-3"	169'-3"	46.0	31.0
	B.R. 12	169'-3"	174'-3"	47.8	29.5
	B.R. 13	174'-3"	179'-3"	47.0	28.2
	B.R. 14	179'-3"	184'-3"	43.1	35.2
	B.R. 15	184'-3"	189'-3"	44.7	33.2
	B.R. 16	189'-3"	194'-3"	51.6	24.5
	B.R. 17	194'-3"	199'-3"	29.9	56.3
	B.R. 18	199'-3"	204'-3"	16.8	75.0
	B.R. 19	204'-3"	209'-3"	26.8	55.8
	B.R. 20	209'-3"	216'-8"	47.8	23.78
DDH. B.R. 3	B.R. 21	57'-0"	61'-0"	17.9	72.4
	B.R. 22	61'-0"	66'-0"	10.8	83.3
	B.R. 23	66'-0"	71'-0"	28.8	57.0
	B.R. 24	71'-0"	76'-0"	20.2	70.1
	B.R. 25	76'-0"	87'-10"	10.2	82.1
	B.R. 26	87'-10"	93'-10"	18.2	72.1
	B.R. 27	93'-10"	98'-0"	25.4	61.8
	B.R. 28	98'-0"	103'-0"	16.6	70.7
	B.R. 29	103'-0"	108'-0"	9.9	86.1
	B.R. 30	108'-0"	113'-0"	17.1	73.9
	B.R. 31	113'-0"	118'-0"	19.1	69.5
	B.R. 32	118'-0"	123'-0"	36.0	48.0
	B.R. 33	123'-0"	128'-0"	55.2	20.9
	B.R. 34	128'-0"	133'-0"	54.9	21.1
	B.R. 35	133'-0"	136'-10"	49.0	29.9
	B.R. 36	136'-10"	141'-0"	45.6	34.1
	B.R. 37	141'-0"	146'-0"	30.6	55.4
	B.R. 38	146'-0"	152'-10"	31.3	53.7

AVERAGE ASSAYS

DDH. B.R. 1	A. 5	A. 6	A. 7	A. 8	A. 9	DDH. B.R. 3
						A. 10
						A. 11
						A. 12
						A. 13

COMPOSITE ASSAYS

HOLE N°	SAMPLE N°	FROM	TO	% Fe	% S ₁ O ₂	% P	% Al	% Mn	% S
DDH. B.R. 1	C1	124'-3"	216'-8"	40.7	36.6	0.08	0.2	0.02	0.05
DDH. B.R. 3	C2	57'-0"	152'-10"	26.6	57.6	0.06	0.09	0.02	0.02

UPPER TUNNEL SAMPLES (BOYD, GIBSON & YOUNG)

SAMPLE N°	FROM	TO	% Fe	% S ₁ O ₂
1	WEST LIMIT UP DRENDY	5'	51.33	25.29
2	5'	10'	55.73	17.42
3	10'	15'	45.67	32.69
4	15'	20'	50.63	26.09
5	20'	25'	49.06	28.55
6	25'	30'	47.76	28.58
7	30'	35'	49.59	27.35
8	35'	40'	49.40	28.58
9	40'	45'	59.16	15.33
10	45'	50'	58.80	14.70
11	50'	55'	60.33	11.17
12	55'	60'	59.42	13.72
13	60'	65'	58.91	13.62
14	65'	70'	50.92	25.74
15	70'	75'	53.20	24.00
16	75'	80'	48.83	29.60
17	80'	85'	25.47	62.40

AVERAGE ASSAYS

A. 1	WEST LIMIT UP DRENDY	40'	49.90	26.87
A. 2	40'	65'	59.33	13.71
A. 3	65'	80'	50.98	26.45
A. 4	WEST LIMIT	80'	53.05	22.68

DEPARTMENT OF MINES — TASMANIA
 DIAMOND DRILLING RESULTS
 CUPRONA IRON AREA
 BLYTHE RIVER

DATE:— FEBRUARY 1966
 FEET SCALE 0 40 80 120
 GEOLOGIST A. J. NOLDART SURVEYOR
 DRAUGHTSMAN P. B. NANKIVELL MAP SHEET & N° BURNIE 28
 REVISIONS FILE N° 2822.

Reduce to 14"