

3232

237

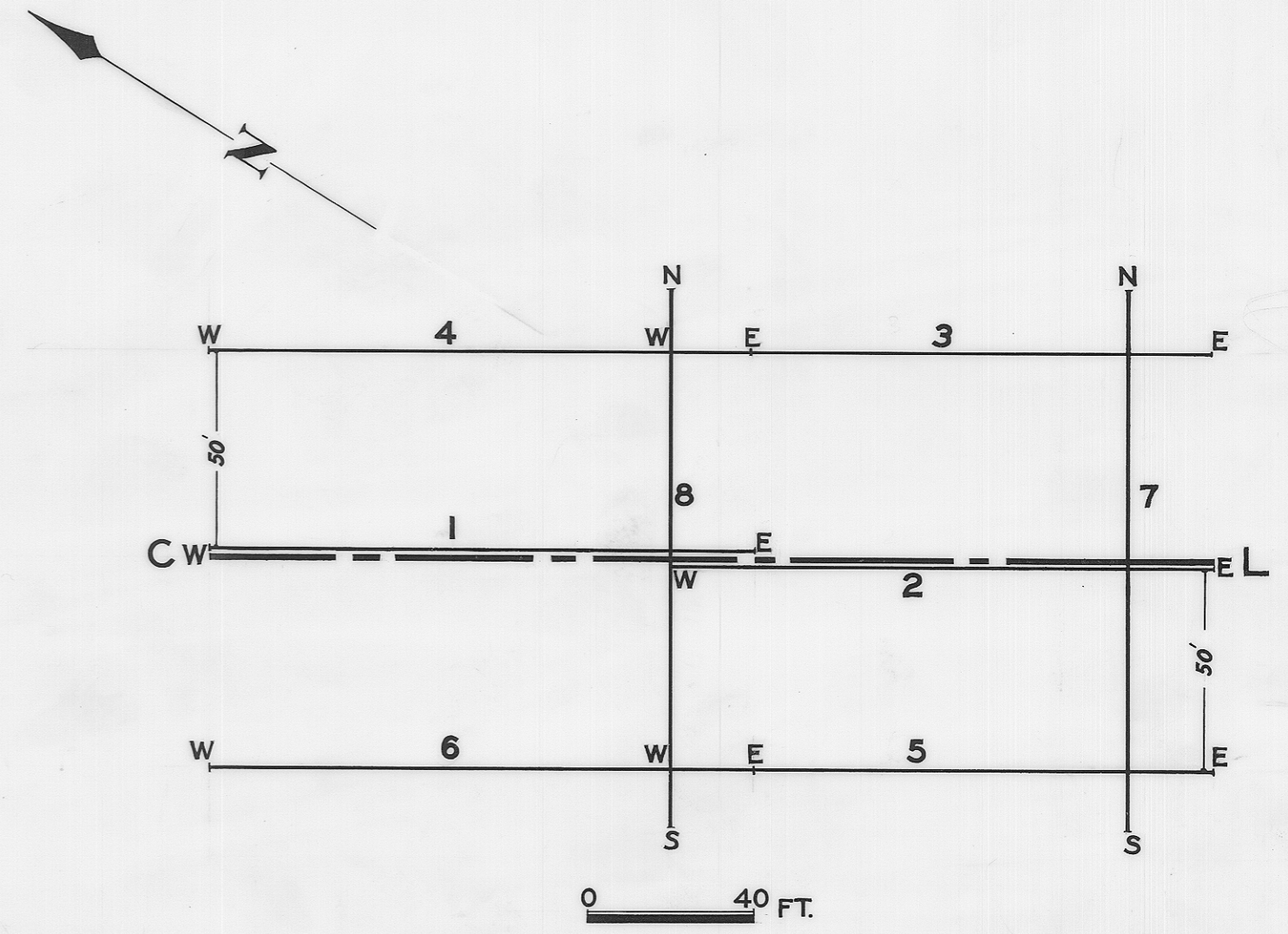
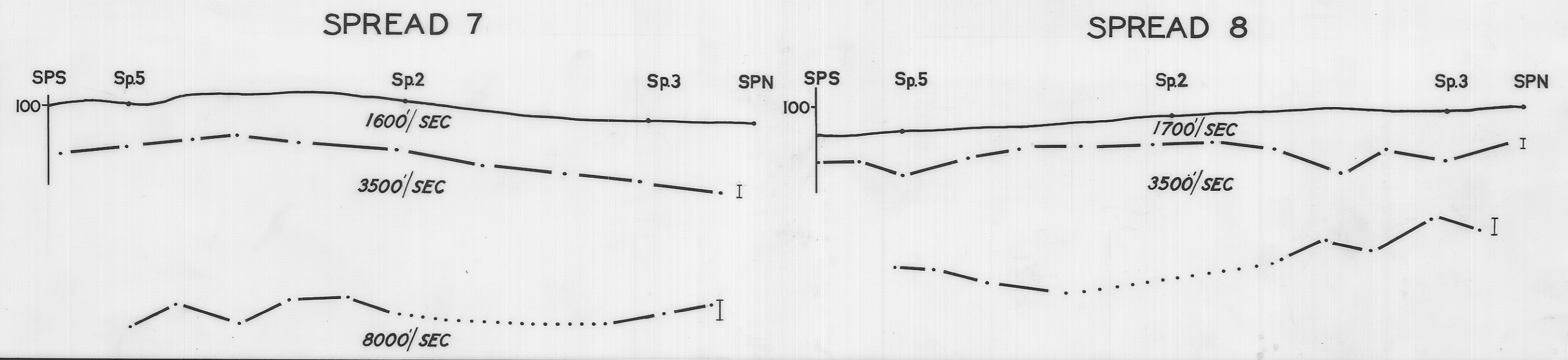
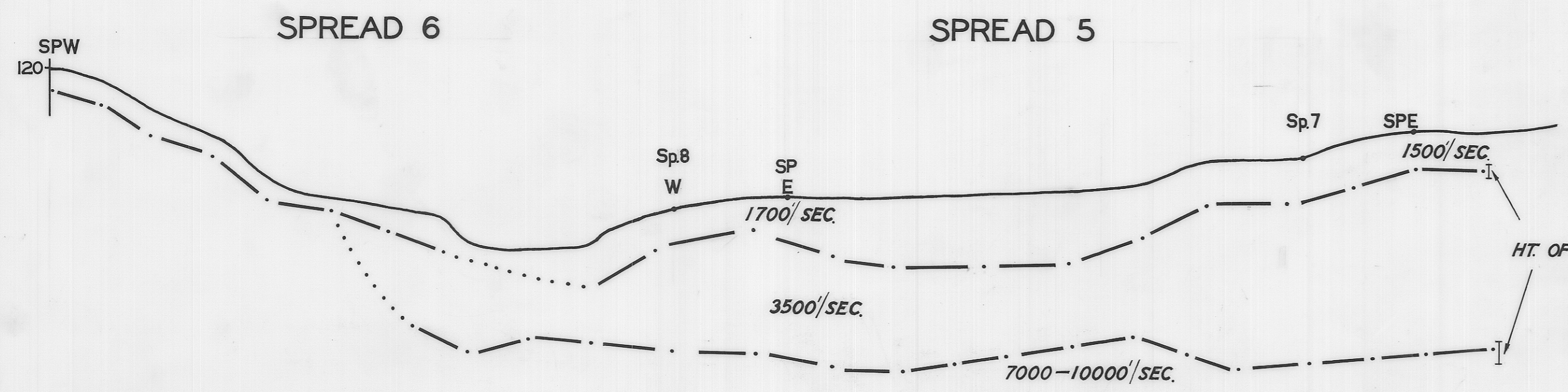
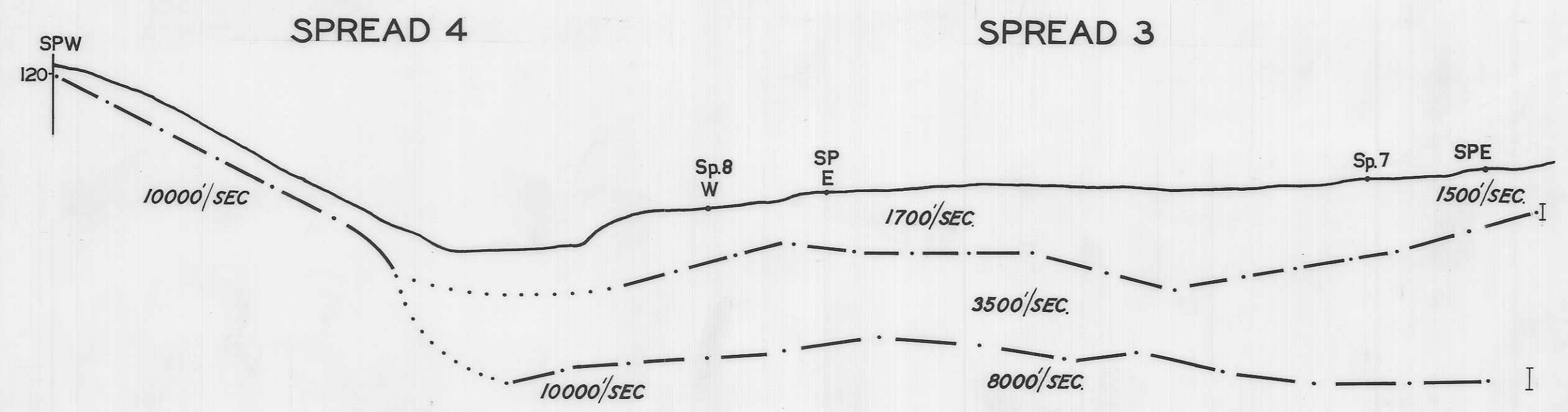
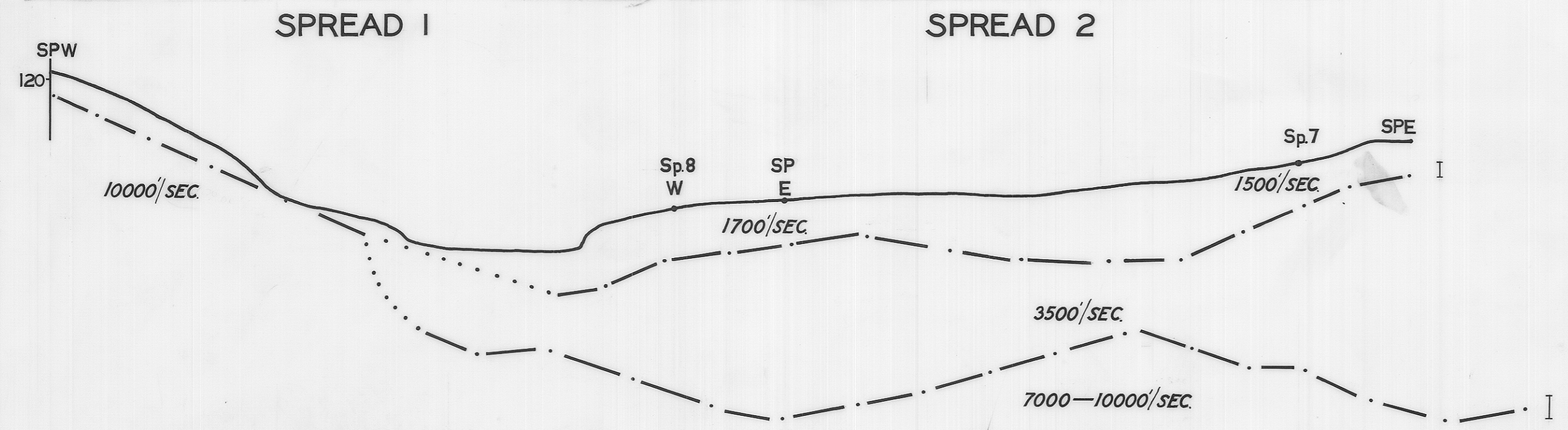

- - - - INTERFACES INDICATED BY SEISMIC REFRACTION
 POSTULATED INTERFACES
 SP SHOT POINT
 Sp SPREAD

HT. OF BAR INDICATES PROBABLE ERROR

5 cm

DEPARTMENT OF MINES — TASMANIA	
BRADY'S CREEK — TRIABUNNA	
LOCALITY PLAN & SEISMIC PROFILES	
DATE JANUARY 1969	0 20 40 60
GEOPHYSICIST P. STEVENSON	SCALE OF FEET
DRAUGHTSMAN H. MACKINNON	MAP SHEET & N° SWANSTON 69
REVISIONS	FILE N° 3232

Fig 33

Reduce to 5"