

5 cm

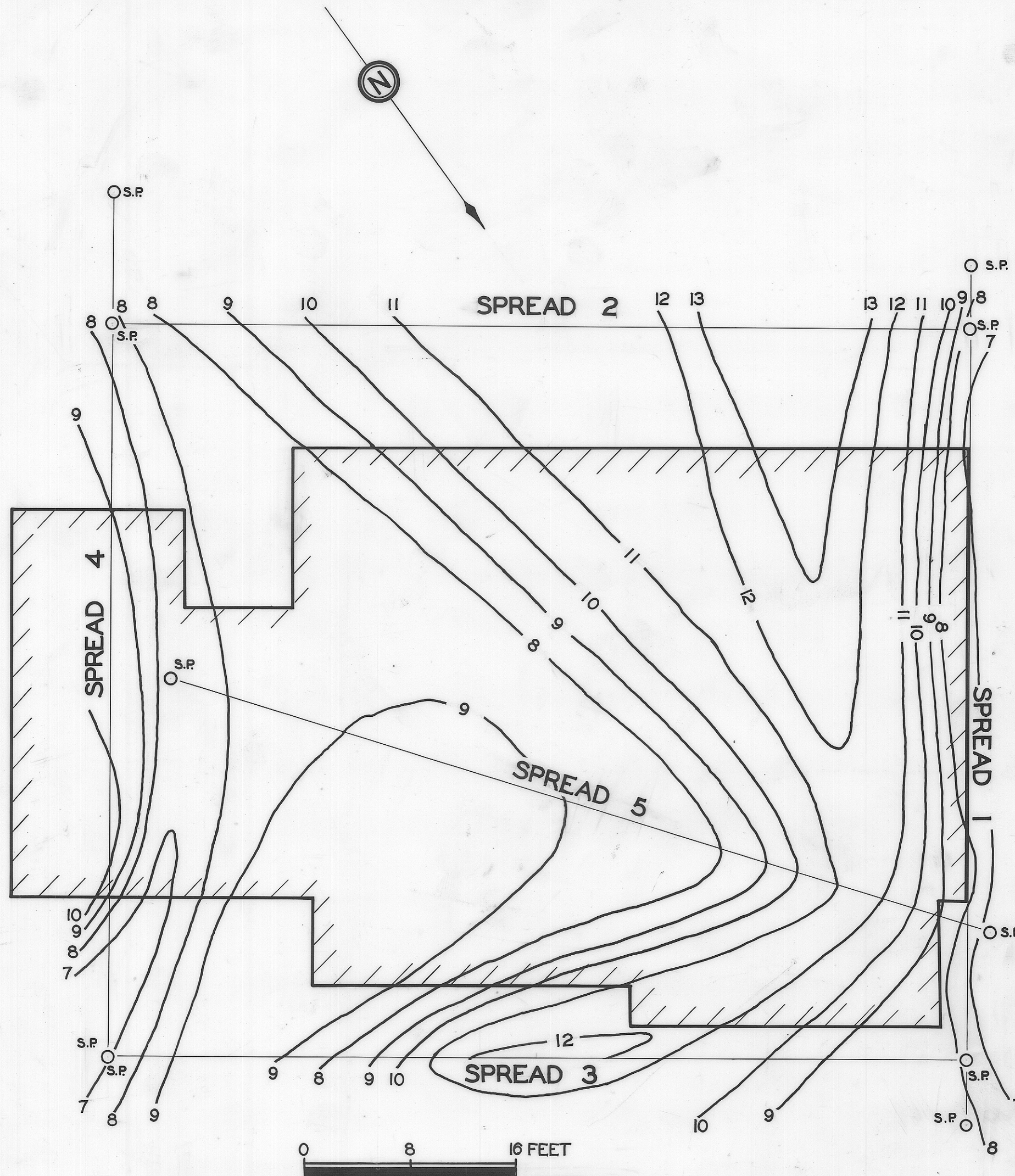
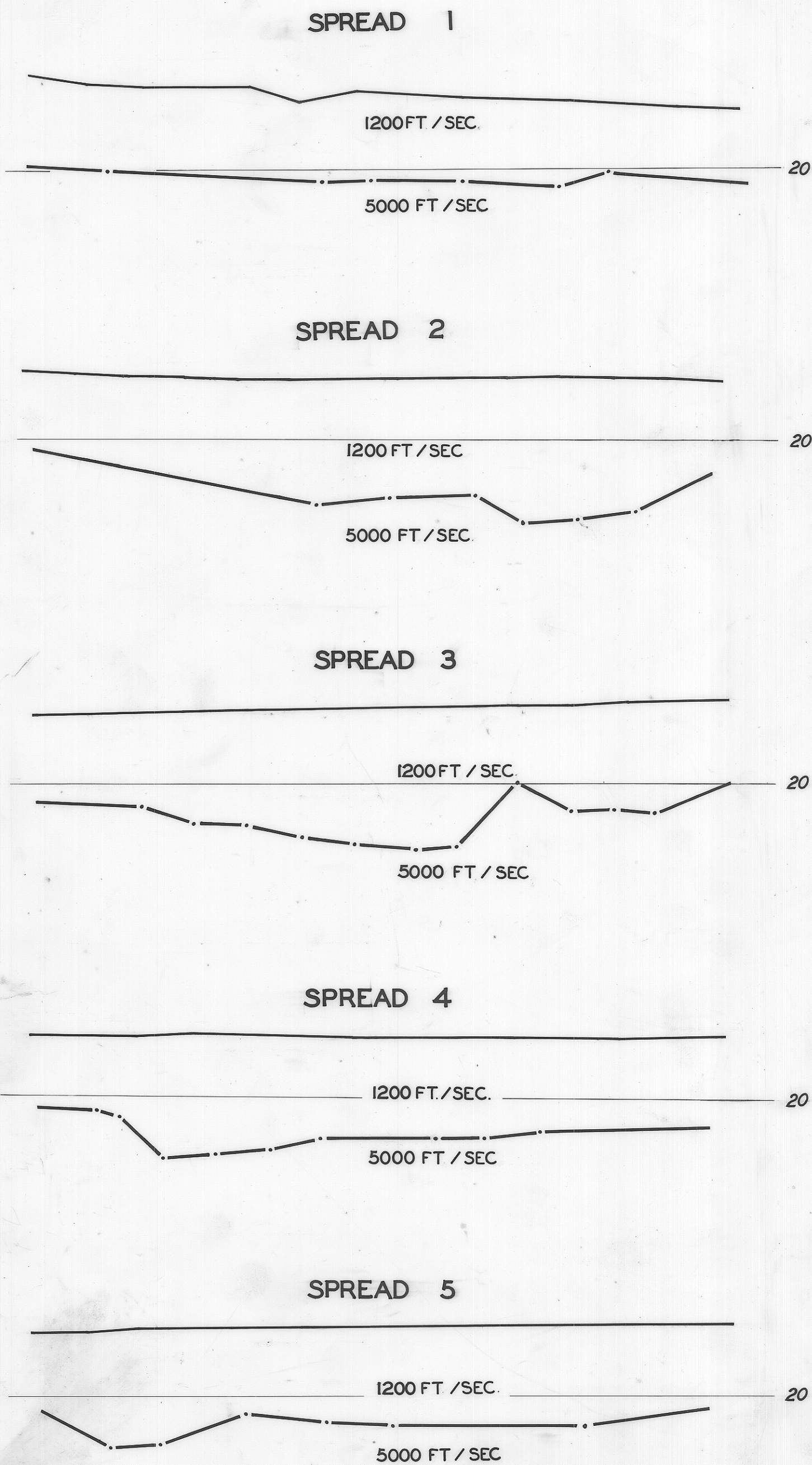

Reduce to 5"

| | |
|---|-------------------------------------|
| DEPARTMENT OF MINES — TASMANIA | |
| SEISMIC SURVEY PROPOSED POST OFFICE PENGUIN | |
| DATE FEBRUARY 1969 | SCALE OF FEET |
| SURVEYOR B. KNOX | 0 10 20 |
| DRAUGHTSMAN T.R. BELLIS | MAPSHEET & N ^o D'PORT 29 |
| REVISIONS | FILE N ^o 3235 |

fig 17.