

3287
(A)

248

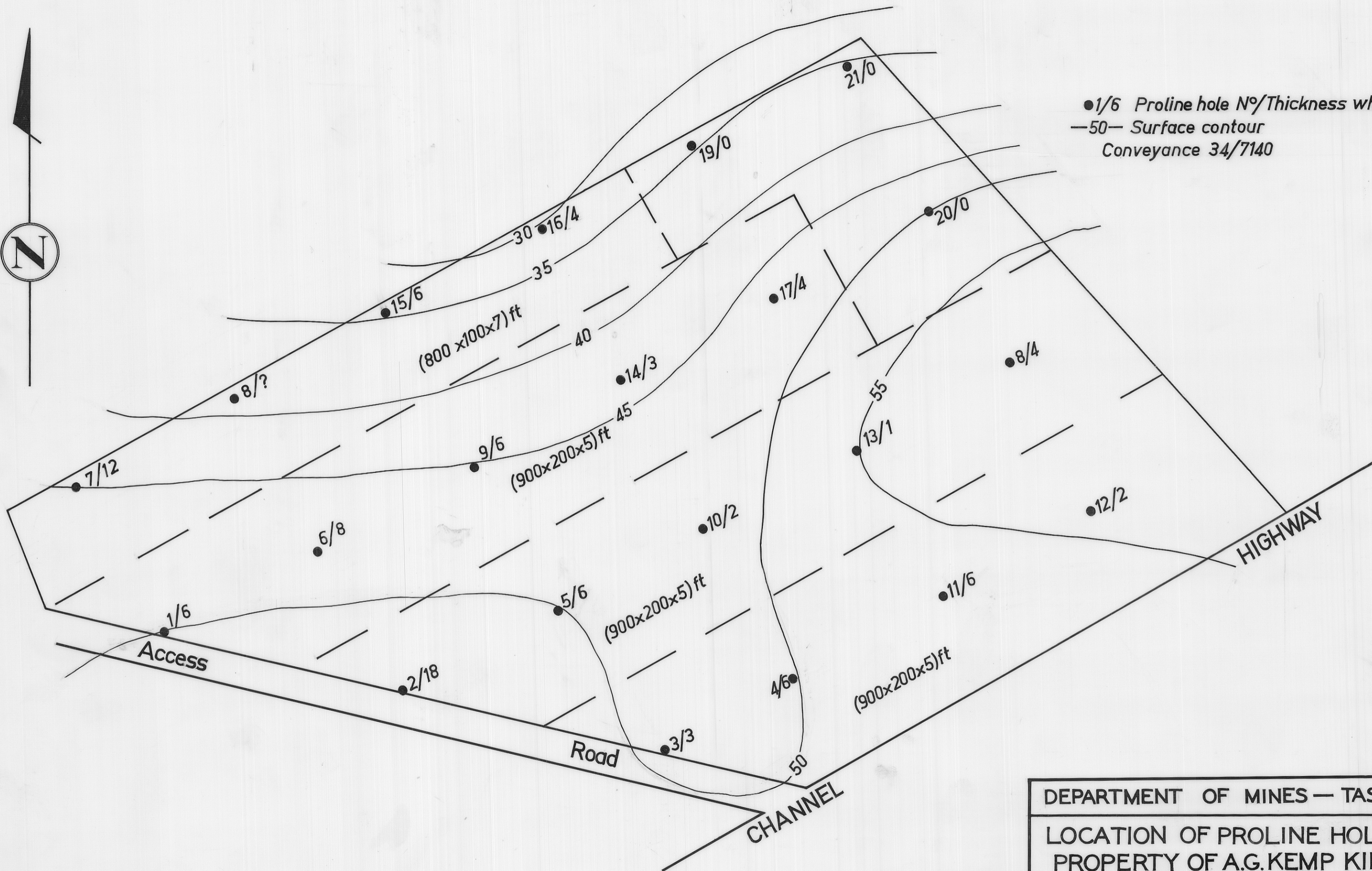

● 1/6 Proline hole N°/Thickness white clay
 -50- Surface contour
 Conveyance 34/7140

DEPARTMENT OF MINES — TASMANIA	
LOCATION OF PROLINE HOLES ON PROPERTY OF A.G. KEMP KINGSTON	
DATE <i>OCTOBER 1969</i>	0 100 200 FT.
GEOLOGIST <i>V. M. THREADER</i>	
DRAWN <i>H. MACKINNON</i>	MAP SHEET & N° <i>HOBART 82</i>
REVISIONS	FILE N° <i>3287 A</i>

5 cm