

674

5 cm

PROPOSED SUBDIVISION PRESERVATION BAY

0 200 400 600 FEET

GEOLOGIST : W.L.MATTHEWS

Drawn : P.J.Donnely

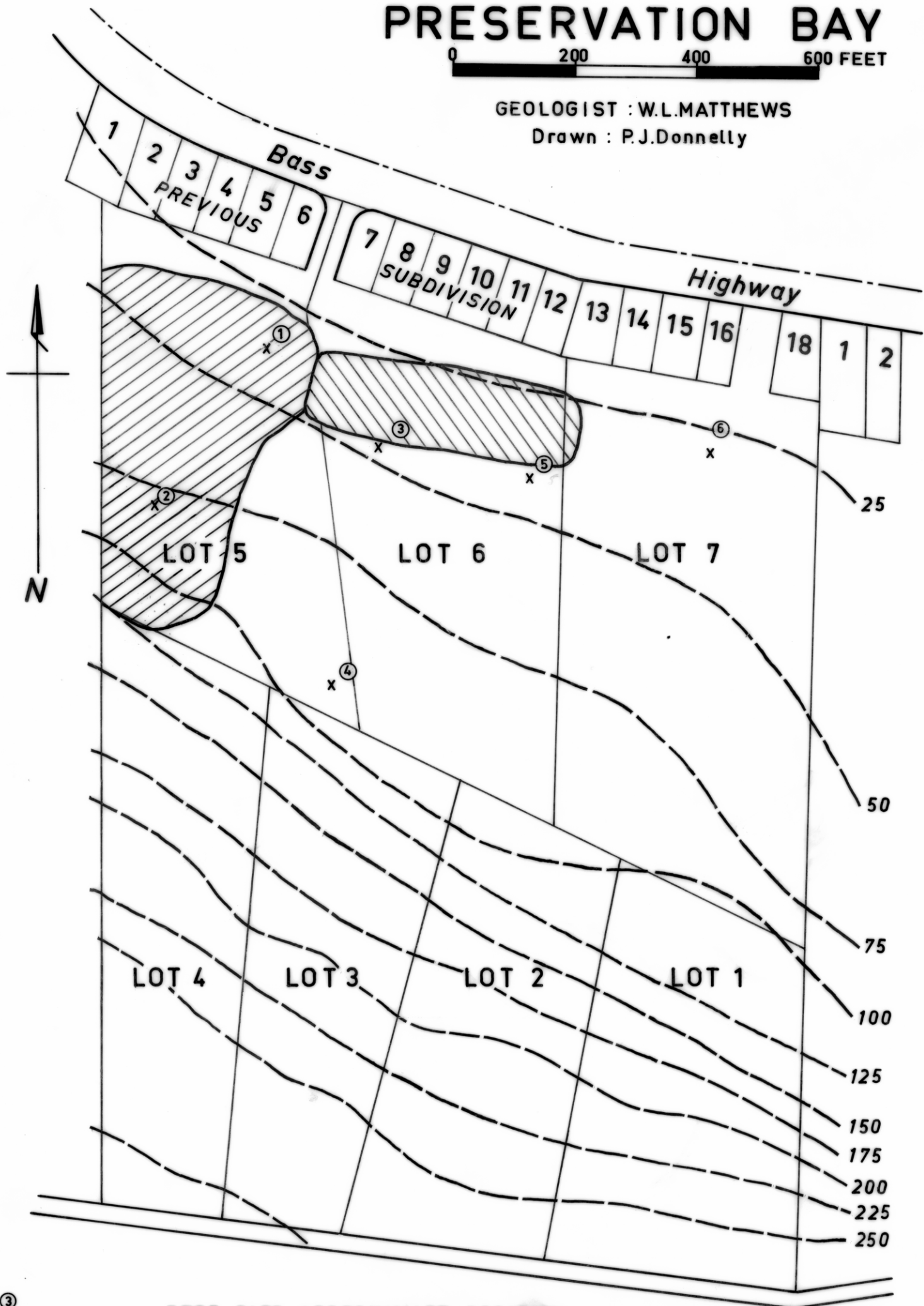

- TEST PITS APPROXIMATE POSITION
- AREA WITH SLOPE OF ABOUT 7 1/2° - 10°
- AREA WITH SLOPE OF ABOUT 10° - 15°