

See Sheet No. 1

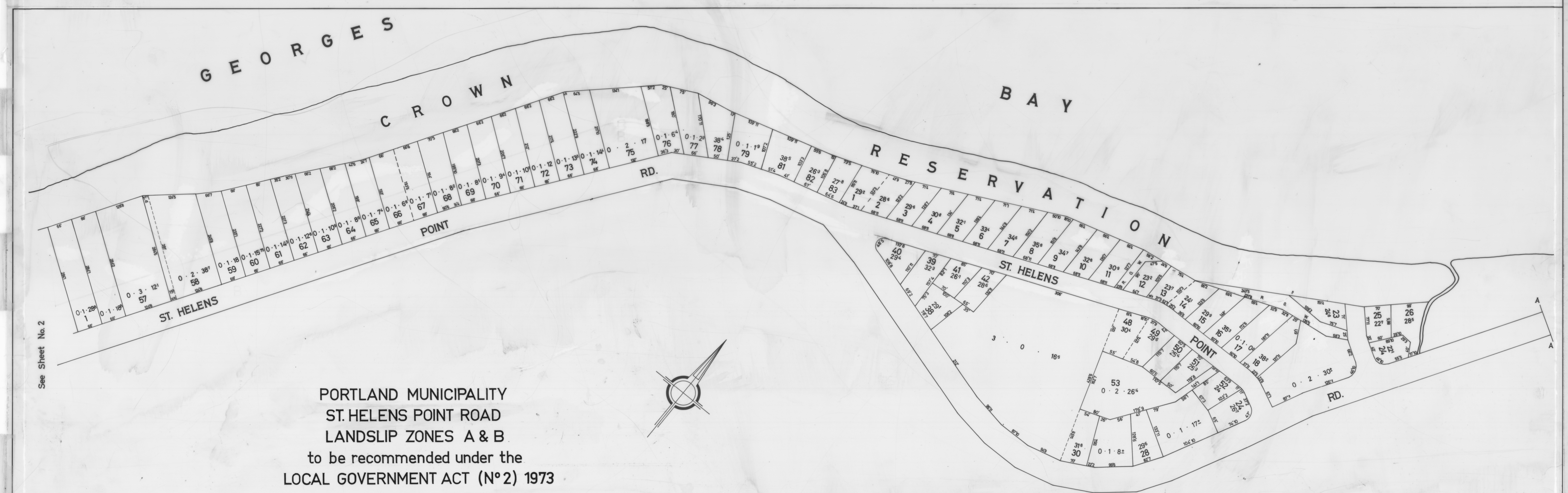

See Sheet No. 2

PORTLAND MUNICIPALITY
 ST. HELENS POINT ROAD
 LANDSLIP ZONES A & B
 to be recommended under the
 LOCAL GOVERNMENT ACT (N°2) 1973
 GEOLOGIST D.J.SLOANE JUNE 1980

7977