

LOCATION ORANA PLACE	SUBURB RIVERSIDE NORTH	GEOLOGIST D.J. Sloane
OWNER G. Walters	TOWN	DATE

● Approx Borehole Location
P1, P2 Drilled 1977
W1, W2 Drilled 1979

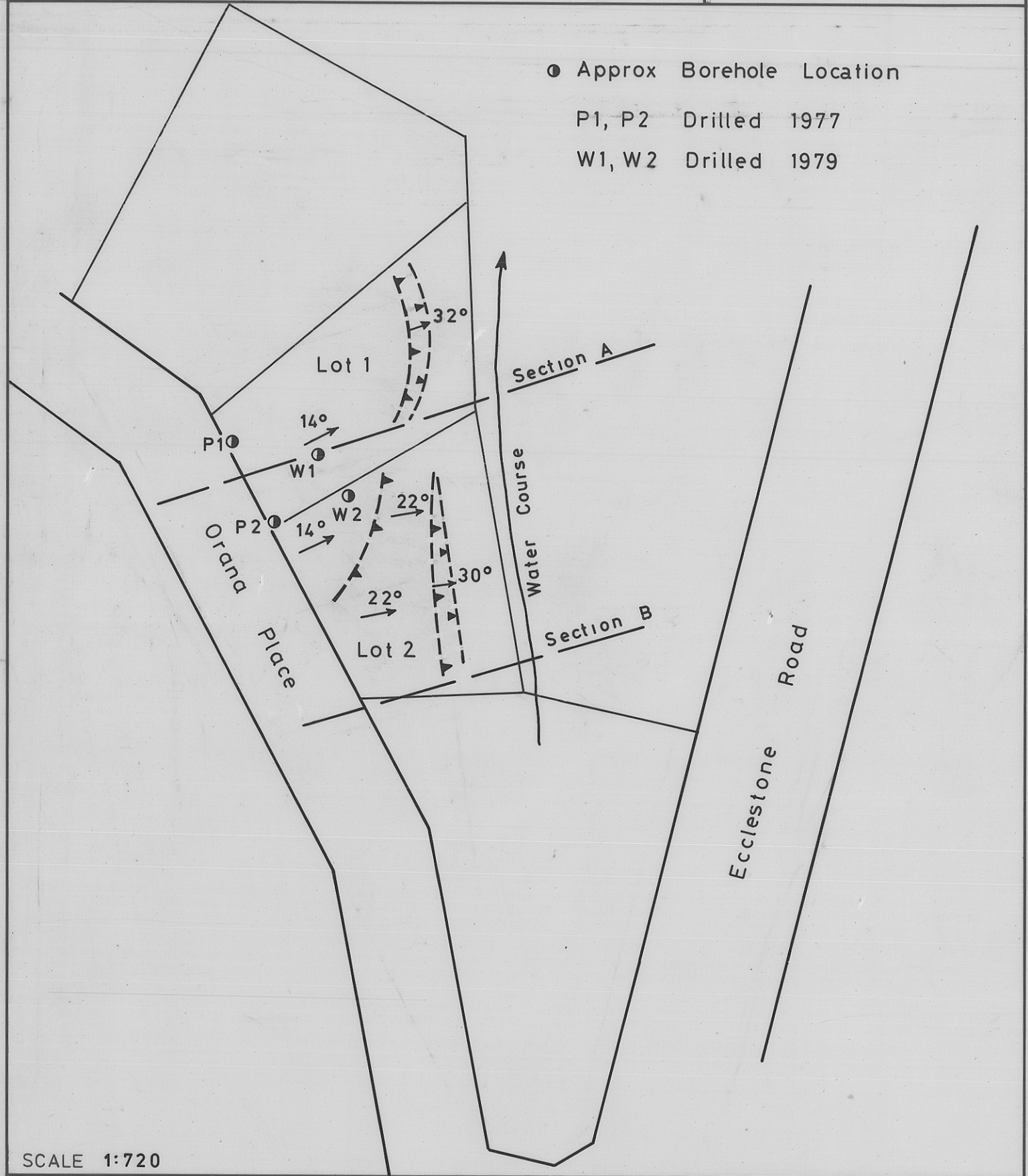

SCALE 1:720

LEGEND

- ↗^{20°} Slope angle and direction
- ↘ Change of slope - downslope side indicated
- ↗ Change of slope - upslope side indicated
- Area in which building advised
- " " " septic tank "

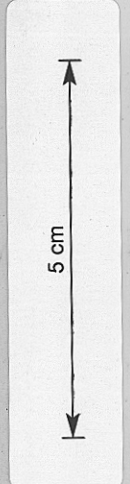

4667 A

350

FIG 1