

ORIGINAL

q3

5155 E  
1:50,000

\*\*\*\*\*  
\* VERTICALLY \*  
\* No.2 \*  
\*\*\*\*\*

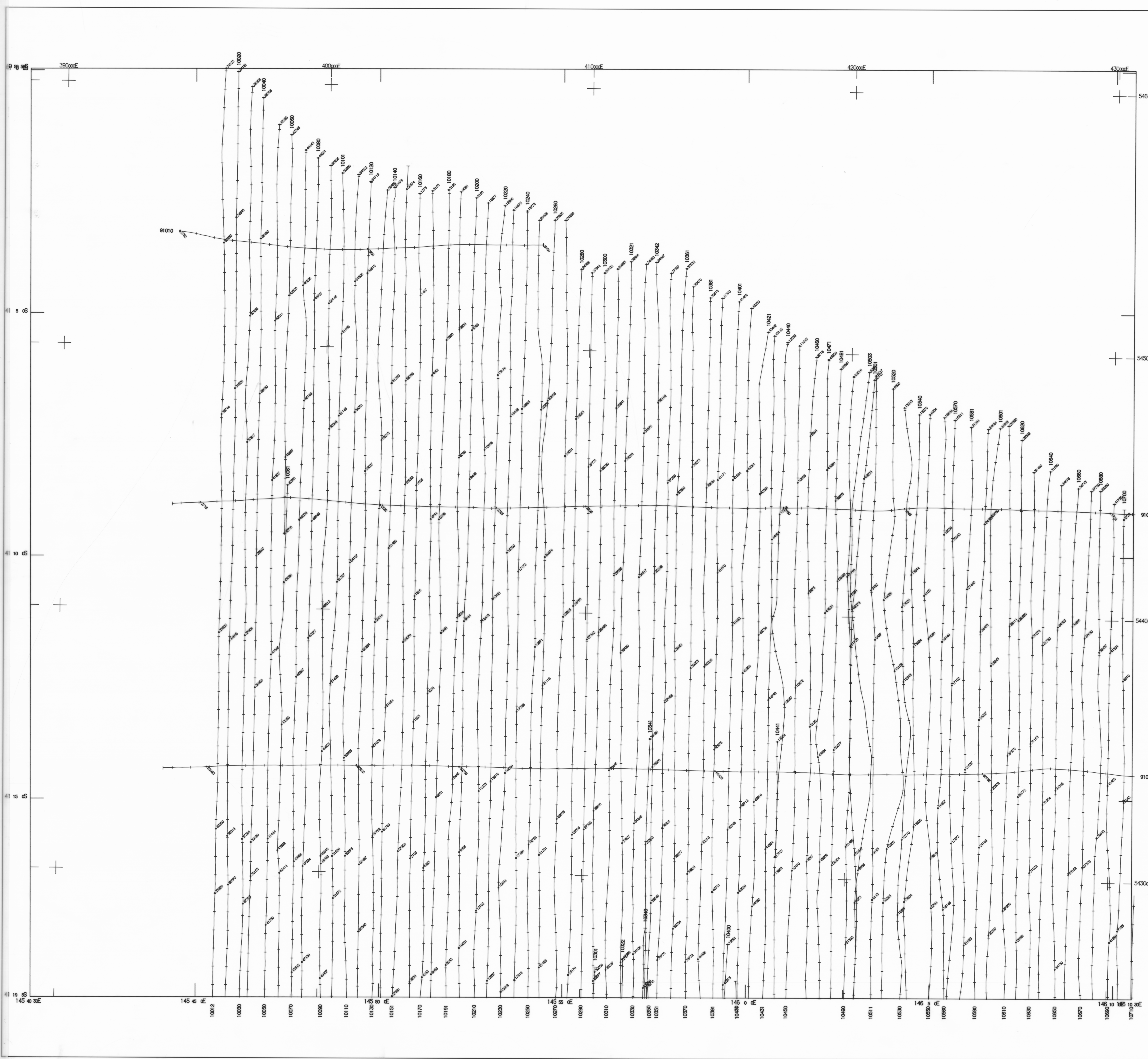

**AIRBORNE SURVEY SPECIFICATIONS**

**MAGNETOMETER :** 3 G-813 proton precession magnetometers in tail stinger and wing tips.  
Sensitivity : 0.2 nT  
30m sampling

**RECORDING INTERVAL :** 30m

**SPECTROMETER :** GR - 800 gamma ray spectrometer  
Volume : 16.8 litres  
C.S. - 3.00 MeV

**TOTAL COUNT WINDOW :** 1.36 - 1.56 MeV

**POTASSIUM WINDOW :** 1.66 - 1.86 MeV

**THORIUM WINDOW :** 2.42 - 2.82 MeV

**RECORDING INTERVAL :** 60m sampling

**DATA RECORDING :** Geometrics 714 acquisition system.  
Digital to magnetic tape.

**NOMINAL TERRAIN CLEARANCE :** All detectors in aircraft at 150m.

**NOMINAL LINE SPACING :** Traverse lines 500 metres.  
Tie lines 10 m.

**FLIGHT PATH RECORD :** continuous tracking colour video.

**FLIGHT LINE RECOVERY :** Visually to 1:100,000 mosaic

**FLIGHT PATH RECOVERY**  
Grid notation refers to Australian Map Grid Zone 55  
Digitized from mosaic at 1:100,000  
with Doppler interpolation between  
recovered points

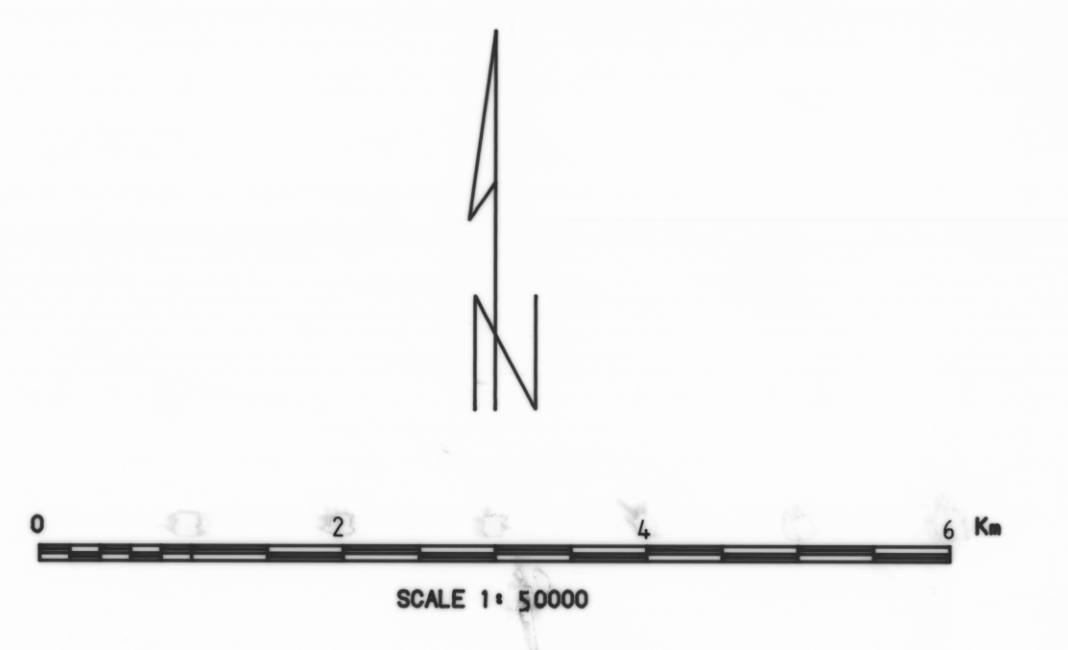
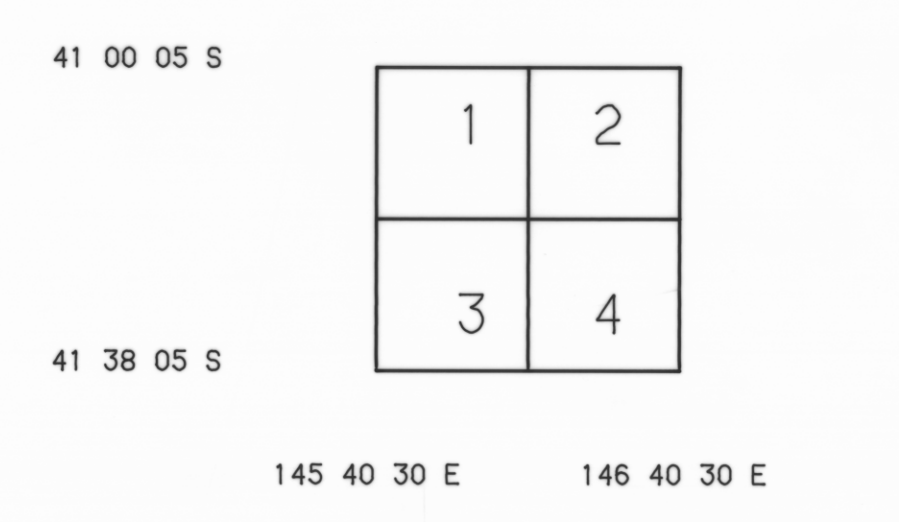

JOB NO : 9312  
Flown by Geometrics International Corporation  
November 1985  
Processed by Engineering Computer Services, Bowral

**TASMANIAN MINES DEPARTMENT**

**DEVONPORT AREA  
FLIGHT PATH RECOVERY  
SHEET ONE**

DATE: 30-APR-86