

AIRBORNE SURVEY SPECIFICATIONS

MAGNETOMETER * 3 G-813 proton precession magnetometers in tail stinger and wing tips.
Sensitivity ± 0.2 nT

RECORDING INTERVAL * 30m sampling

SPECTROMETER * GR - 800 gamma ray spectrometer
Volume * 16.8 litres
0.8 - 3.00 MeV

TOTAL COUNT WINDOW * 1.36 - 1.56 MeV

POTASSIUM WINDOW * 1.66 - 1.86 MeV

URANIUM WINDOW * 2.42 - 2.62 MeV

RECORDING INTERVAL * 60m sampling

DATA RECORDING * Geometrics 714 acquisition system.
Digital to magnetic tape.

NOMINAL TERRAIN CLEARANCE * All detectors in aircraft at 150m.

NOMINAL LINE SPACING * Traverse lines 500 metres.
Tie lines 10 m.

FLIGHT PATH RECORD * continuous tracking colour video.

FLIGHT LINE RECOVERY * Visually to 1:50,000 topographic maps

SHEET ONE
GRADIENT ENHANCED MAGNETIC CONTOURS
Grid notation refers to Australian Map Grid Zone 55
Digitized from colour photos at 1:50000
Magnetic * gradient enhanced
* from transverse gradient derived
* from 3 total field sensors
Altitude corrections have not been applied to gradients. This may account for some line dependent features in hilly areas
IGRF (1980) * Updated to December 1985
IGRF (1980) * Removed. Datum 2000 at added
Grid mesh size * 100 x 100 metres
Grid filter * Polynomial, radius 150 metres
Contour interval * 5, 10, 50, 100 and 250 nT

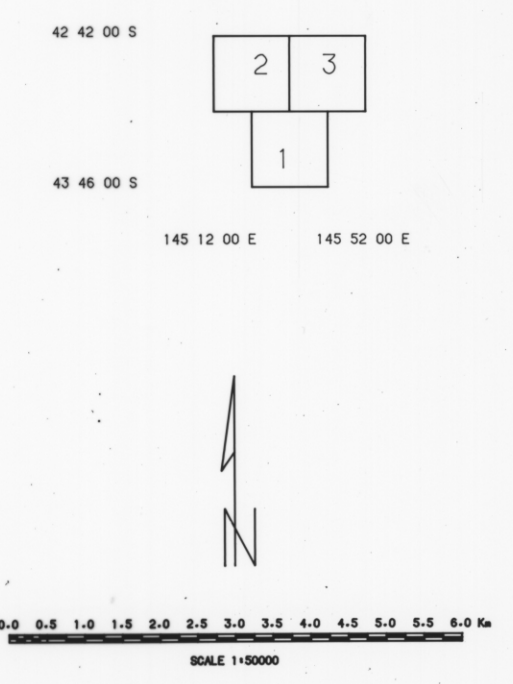

JOB NO * 9312
Flown by Geometrics International Corporation
November 1985
Processed by Engineering Computer Services, Boreal

TASMANIAN MINES DEPARTMENT

WESTERN TASMANIA
GRADIENT ENHANCED MAGNETIC CONTOURS
SHEET ONE

DATE * 11-APR-86