

1:50,000 AIRBORNE GEOPHYSICAL SERIES

PIPERS RIVER SURVEY

FLIGHT PATH
MINERAL RESOURCES TASMANIA

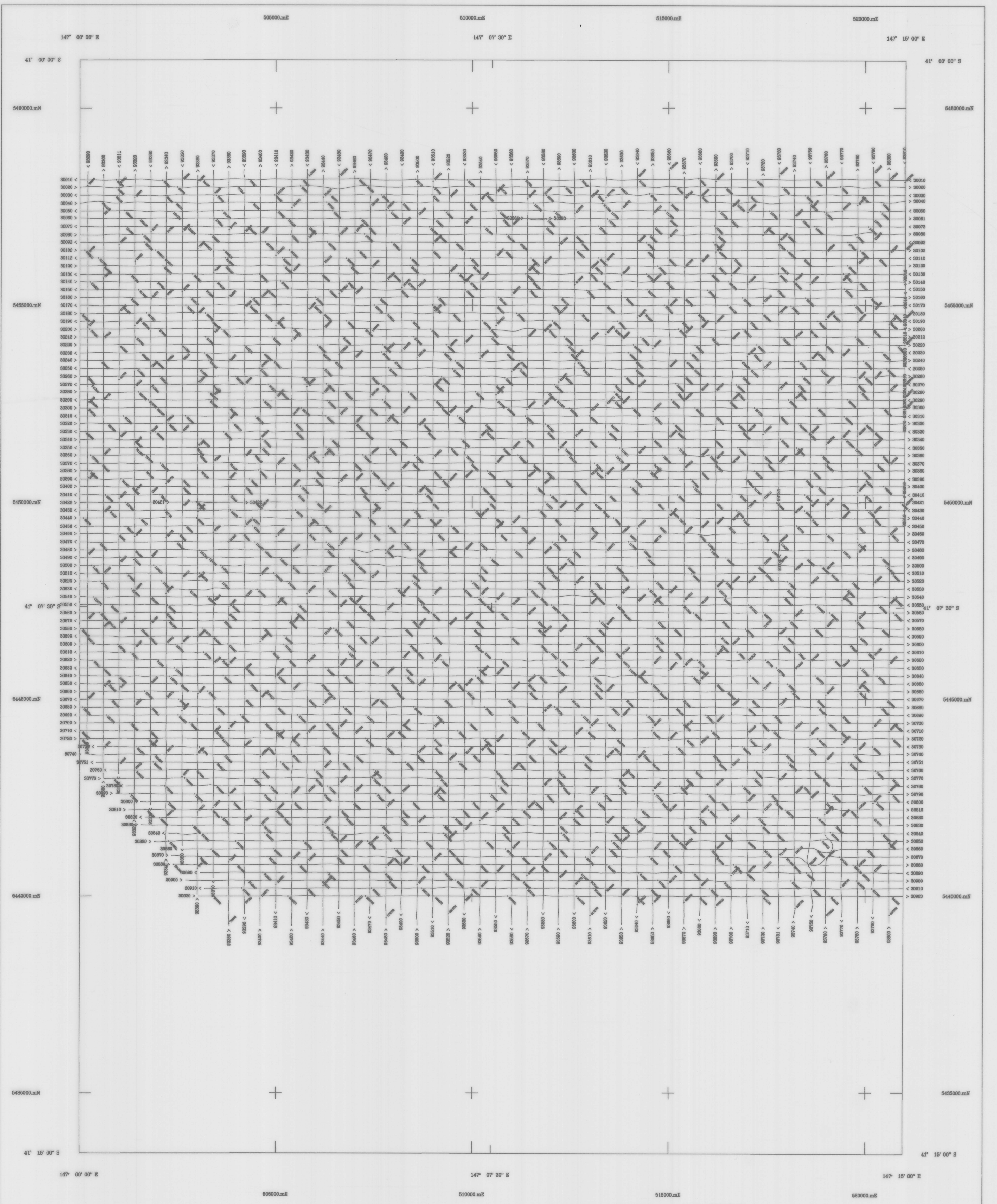

AIRBORNE SURVEY EQUIPMENT

Aircraft
Magnetometer
Magnetometer Resolution
Magnetometer Sample Interval
Data Acquisition
Data Recording
Spectrometer
Crystal Size
Spectrometer Sample Interval
Flight Path Record
GPS Navigation System

Bell 206 - 3 VH-FHI
Geometrics G833 Helium Vapour
0.01 nT
0.20 seconds
Geo Instruments Model 2000
1.44 Mb floppy disks
Exploranium G8820
16.8M downward array
1.0 Seconds (approx 55 metres)
VHS Colour Video System
Novatel GPS Receiver

AIRBORNE SURVEY SPECIFICATIONS

Flight Line Direction
Flight Line Separation
Tie Line Direction
Tie Line Separation
Terrain Clearance

090 - 270 degrees
200 metres
090 - 150 degrees
400 metres
80 metres (MTC)

FLIGHT PATH PROCESSING

Flight path calculated from differentially corrected GPS data using a Novatel GPS Receiver
GPS navigation data differentially corrected in real time.
GPS Base Station Base at S 41.1' 28.017\"/>

Pipers River Aeromagnetic Survey
Tasmania Development and Resources
Minerals Resources Tasmania
Surveyed and compiled Geo Instruments Pty. Ltd
Processed by Kevron Geophysics Pty. Ltd.
October - November 1993

Mineral Resources Tasmania Reserved
Project Supervision by Mineral Resources Tasmania

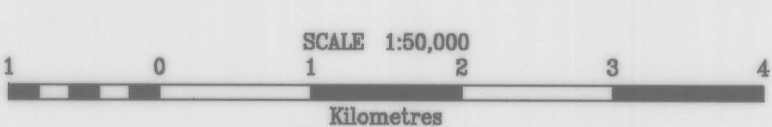

SPHEROID : Australian National
PROJECTION : Universal Transverse Mercator

1:50,000 SHEET LOCATION

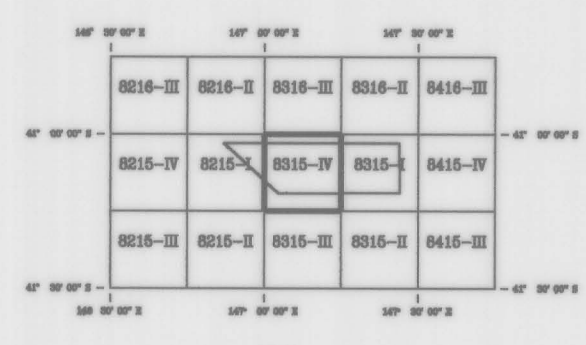

8315-IV

