

1:50,000 AIRBORNE GEOPHYSICAL SERIES

PIPERS RIVER SURVEY

TOTAL MAGNETIC INTENSITY PROFILES
MINERAL RESOURCES TASMANIA

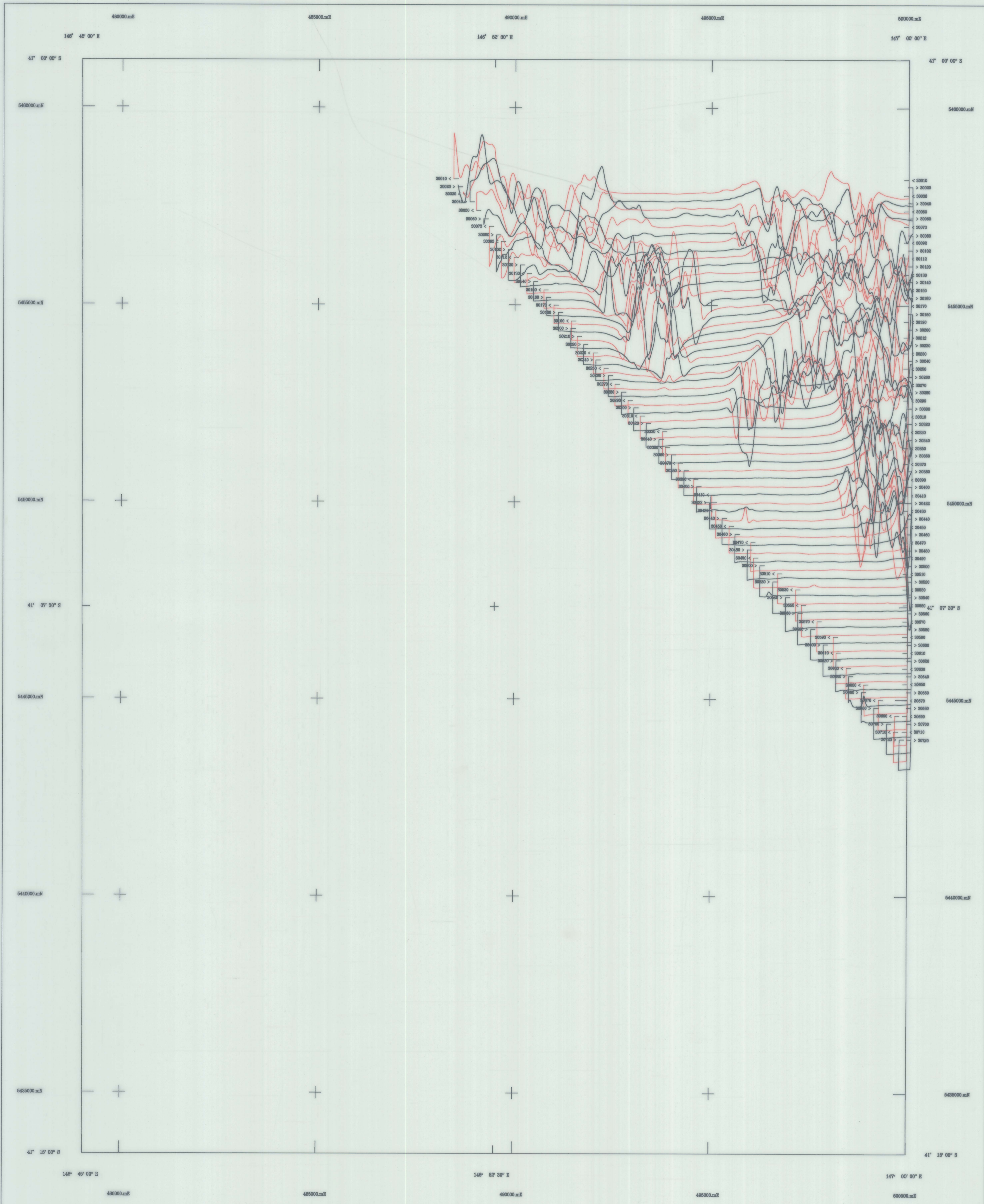

AIRBORNE SURVEY EQUIPMENT

Aircraft	Bell 206 - 3 VH-FKH
Magnetometer	Geometrics G533 Ballium Vapor
Magnetometer Resolution	0.01 nT
Magnetometer Sample Interval	0.20 seconds
Data Acquisition	Geo Instruments Model 2000
Data Recording	1.44 Mb floppy disks
Spectrometer	Explosumin GR250
Crystal Size	18.00 diameter array
Spectrometer Sample Interval	1.0 Seconds (approx 35 metres)
Flight Path Record	VHS Colour Video System
GPS Navigation System	Novatel GPS Receiver

AIRBORNE SURVEY SPECIFICATIONS

Flight Line Direction	090 - 270 degrees
Flight Line Separation	200 metres
Tie Line Direction	000 - 180 degrees
Tie Line Separation	400 metres
Terrain Clearance	80 metres (MFL)

TOTAL MAGNETIC INTENSITY STACKED PROFILES

Diurnal variations removed
ICRP(1990) updated to 1983.8 removed
Average survey base station value added to datum
Datum Base Value 5000 nT
Vertical Scale 50 nT / cm

Pipers River Aeromagnetic Survey
Tasmania Development and Resources
Minerals Resources Tasmania
Surveyed and compiled Geo Instruments Pty. Ltd
Processed by Kevron Geophysics Pty. Ltd.
October - November 1993

Mineral Resources Tasmania Reserved
Project Supervision by Mineral Resources Tasmania

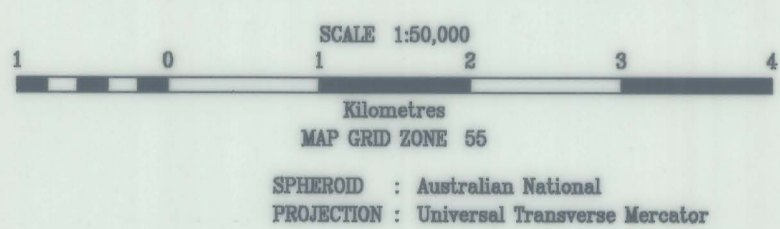

1:50,000 SHEET LOCATION

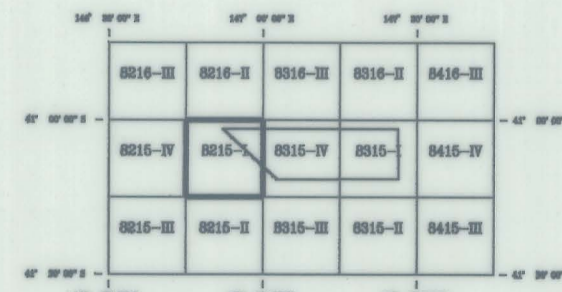

8215-1

