

1:50,000 AIRBORNE GEOPHYSICAL SERIES

PIPERS RIVER SURVEY

TOTAL MAGNETIC INTENSITY PROFILES
MINERAL RESOURCES TASMANIA

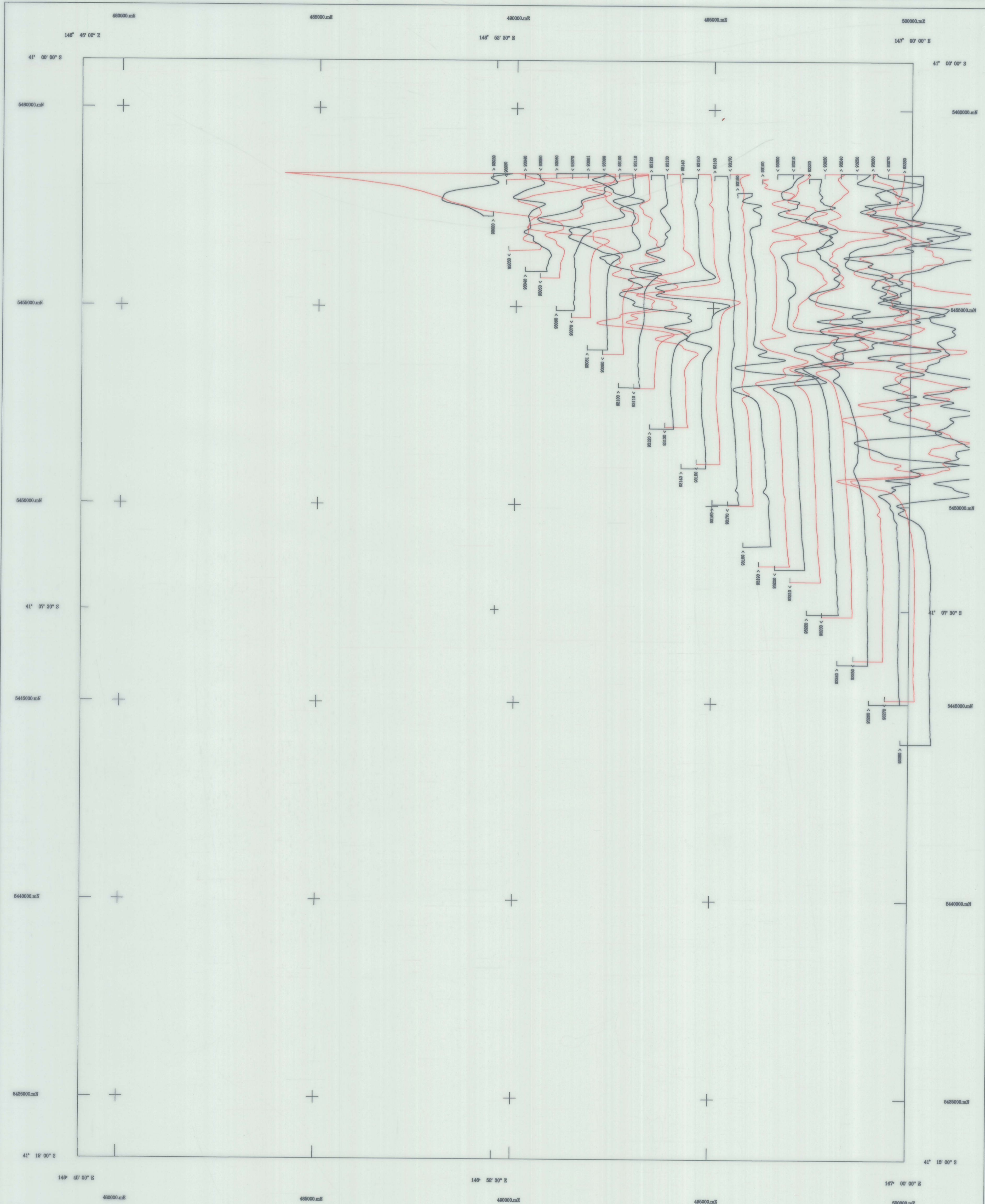

AIRBORNE SURVEY EQUIPMENT

Aircraft: Bell 206 - 3 VII-FHE
 Magnetometer: Geometrics G85 Helium Vector
 Magnetometer Resolution: 0.01 nT
 Magnetometer Sample Interval: 0.20 seconds
 Data Acquisition: Geo Instruments Model 2000
 Data Recording: 1.44 MB floppy disks
 Spectrometer: Exploration G850
 Crystal Size: 18.0mm downward array
 Spectrometer Sample Interval: 1.0 Second (approx 35 metres)
 Flight Path Record: VHS Colour Video System
 GPS Navigation System: Novatel GPS Receiver

AIRBORNE SURVEY SPECIFICATIONS

Flight Line Direction: 090 - 270 degrees
 Flight Line Separation: 200 metres
 Tie Line Direction: 000 - 180 degrees
 Tie Line Separation: 400 metres
 Terrain Clearance: 60 metres (MVC)

TOTAL MAGNETIC INTENSITY STACKED PROFILES

Diurnal variations removed
 IGRF(1980) updated to 1993.8 removed
 Average survey base station value added to datum
 Datum Base Value: 5000 nT
 Vertical Scale: 50 nT / cm

Pipers River Aeromagnetic Survey
 Tasmania Development and Resources
 Minerals Resources Tasmania
 Surveyed and compiled Geo Instruments Pty. Ltd
 Processed by Kevron Geophysics Pty. Ltd.
 October - November 1993

Mineral Resources Tasmania Reserved
 Project Supervision by Mineral Resources Tasmania

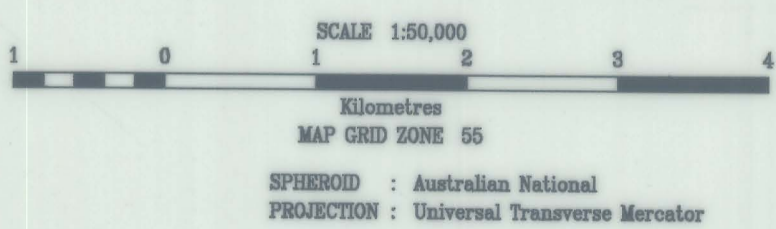

1:50,000 SHEET LOCATION

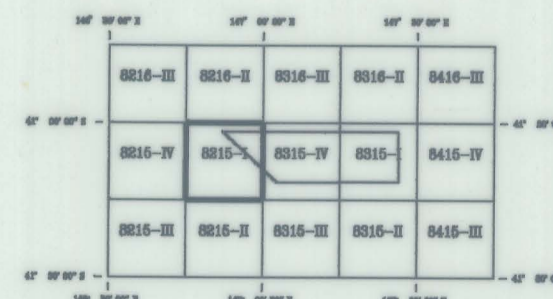

8215-I

