

1:50,000 AIRBORNE GEOPHYSICAL SERIES

PIPERS RIVER SURVEY

TOTAL MAGNETIC INTENSITY PROFILES
MINERAL RESOURCES TASMANIA

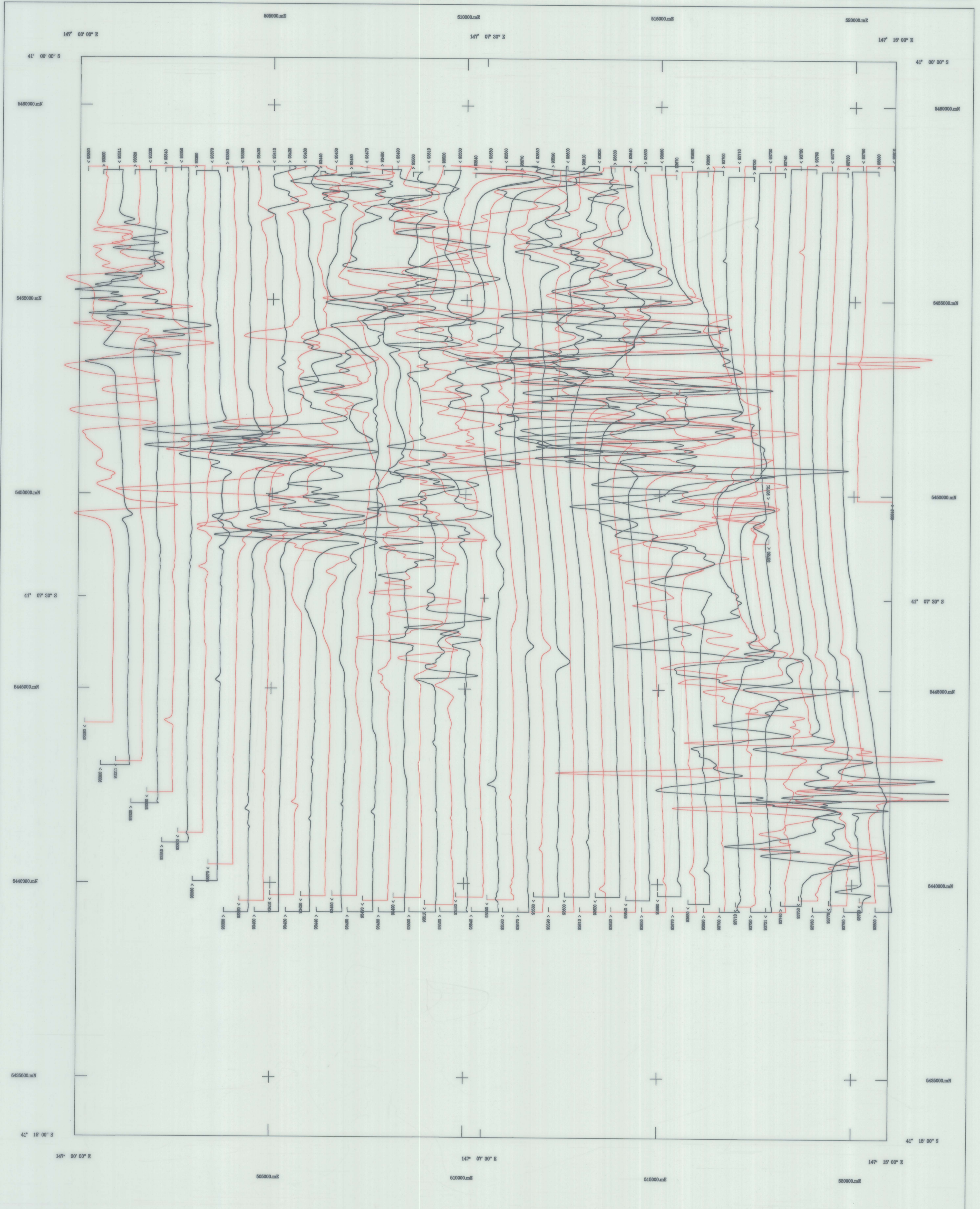

AIRBORNE SURVEY EQUIPMENT

Aircraft
Magnetometer
Magnetometer Resolution
Magnetometer Sample Interval
Data Acquisition
Data Recording
Spectrometer
Crystal Size
Spectrometer Sample Interval
Flight Path Record
GPS Navigation System

Bull 308 - 3 WI-YHE
Geometrics G833 Helium Vapour
0.01 nT
0.50 seconds
Geo Instruments Model 2000
1.44 MB floppy disks
Explosionless CDS50
18.0M downward array
1.0 Seconds (approx 50 metres)
VHS Colour Video System
Novatel GPS Receiver

AIRBORNE SURVEY SPECIFICATIONS

Flight Line Direction
Flight Line Separation
Line Direction
Line Separation
Terrain Clearance

090 - 270 degrees
200 metres
000 - 180 degrees
400 metres
80 metres (MTC)

TOTAL MAGNETIC INTENSITY STACKED PROFILES

Normal variations removed
IGMF(1990) updated to 1993.8 removed
Average survey base station value added to datum
Datum Base Value 5000 nT
Vertical Scale 50 nT/cm

Pipers River Aeromagnetic Survey
Tasmania Development and Resources
Minerals Resources Tasmania
Surveyed and compiled Geo Instruments Pty. Ltd
Processed by Kevron Geophysics Pty. Ltd.
October - November 1993

Mineral Resources Tasmania Reserved
Project Supervision by Mineral Resources Tasmania

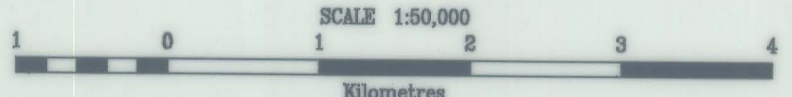

MAP GRID ZONE 56
SPHEROID : Australian National
PROJECTION : Universal Transverse Mercator

1:50,000 SHEET LOCATION

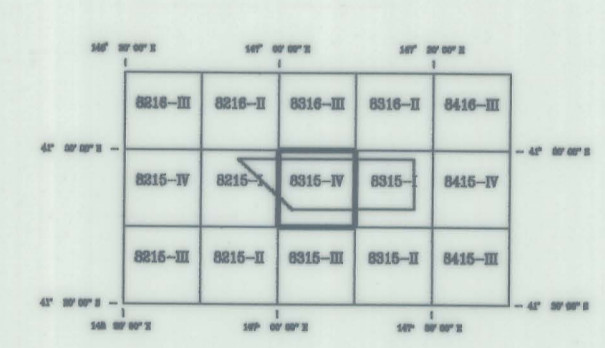

8315-IV

