

1:50,000 AIRBORNE GEOPHYSICAL SERIES

PIPERS RIVER SURVEY

TOTAL MAGNETIC INTENSITY PROFILES  
MINERAL RESOURCES TASMANIA

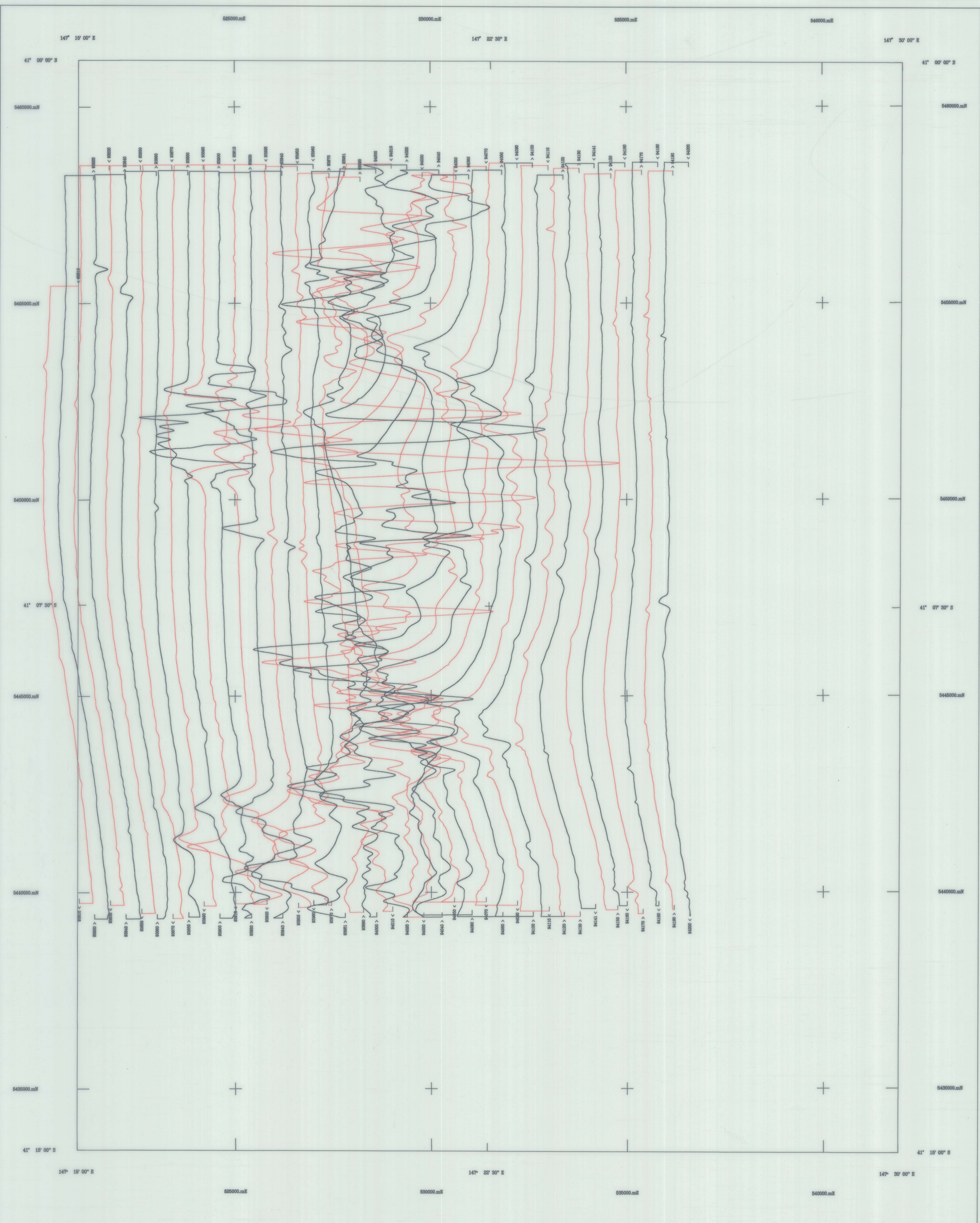

**AIRBORNE SURVEY EQUIPMENT**

Aircraft: Bell 206 - 3 VH-FBH  
 Magnetometer: Geometrics G833 Helium Vapor  
 Magnetometer Resolution: 0.01 nT  
 Magnetometer Sample Interval: 0.20 seconds  
 Data Acquisition: Geo Instruments Model 2000  
 Data Recording: 1.44 MB floppy disks  
 Spectrometer: Euphemism G2050  
 Crystal Size: 16.81 downward array  
 Spectrometer Sample Interval: 1.0 seconds (approx 20 metres)  
 Flight Path Record: WIS Colour Video System  
 GPS Navigation System: Novatel GPS Receiver

**AIRBORNE SURVEY SPECIFICATIONS**

Flight Line Direction: 090 - 270 degrees  
 Flight Line Separation: 320 metres  
 Tie Line Direction: 000 - 180 degrees  
 Tie Line Separation: 400 metres  
 Terrain Clearance: 60 metres (MVC)

**TOTAL MAGNETIC INTENSITY STACKED PROFILES**

Diurnal variations removed  
 IGRF(1990) updated to 1995.8 removed  
 Average survey base station value added to datum  
 Datum Base Value: 2000 nT  
 Vertical Scale: 50 nT / cm

Pipers River Aeromagnetic Survey  
 Tasmania Development and Resources  
 Minerals Resources Tasmania  
 Surveyed and compiled Geo Instruments Pty. Ltd  
 Processed by Kevron Geophysics Pty. Ltd.  
 October - November 1993

Mineral Resources Tasmania Reserved  
 Project Supervision by Mineral Resources Tasmania

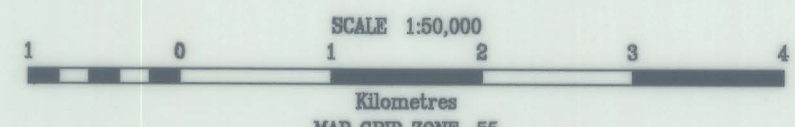

SPHEROID: Australian National  
 PROJECTION: Universal Transverse Mercator

1:50,000 SHEET LOCATION

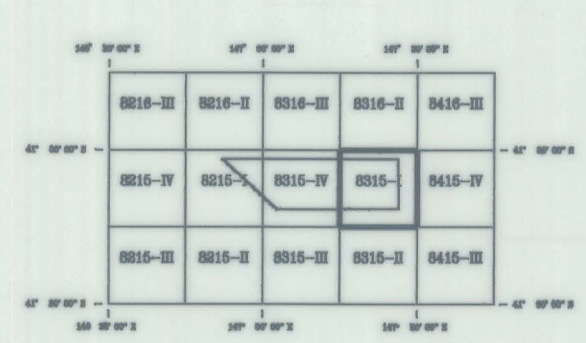

8315-I

