

1:50,000 AIRBORNE GEOPHYSICAL SERIES

FINGAL SURVEY

TOTAL MAGNETIC INTENSITY PROFILES
MINERAL RESOURCES TASMANIA

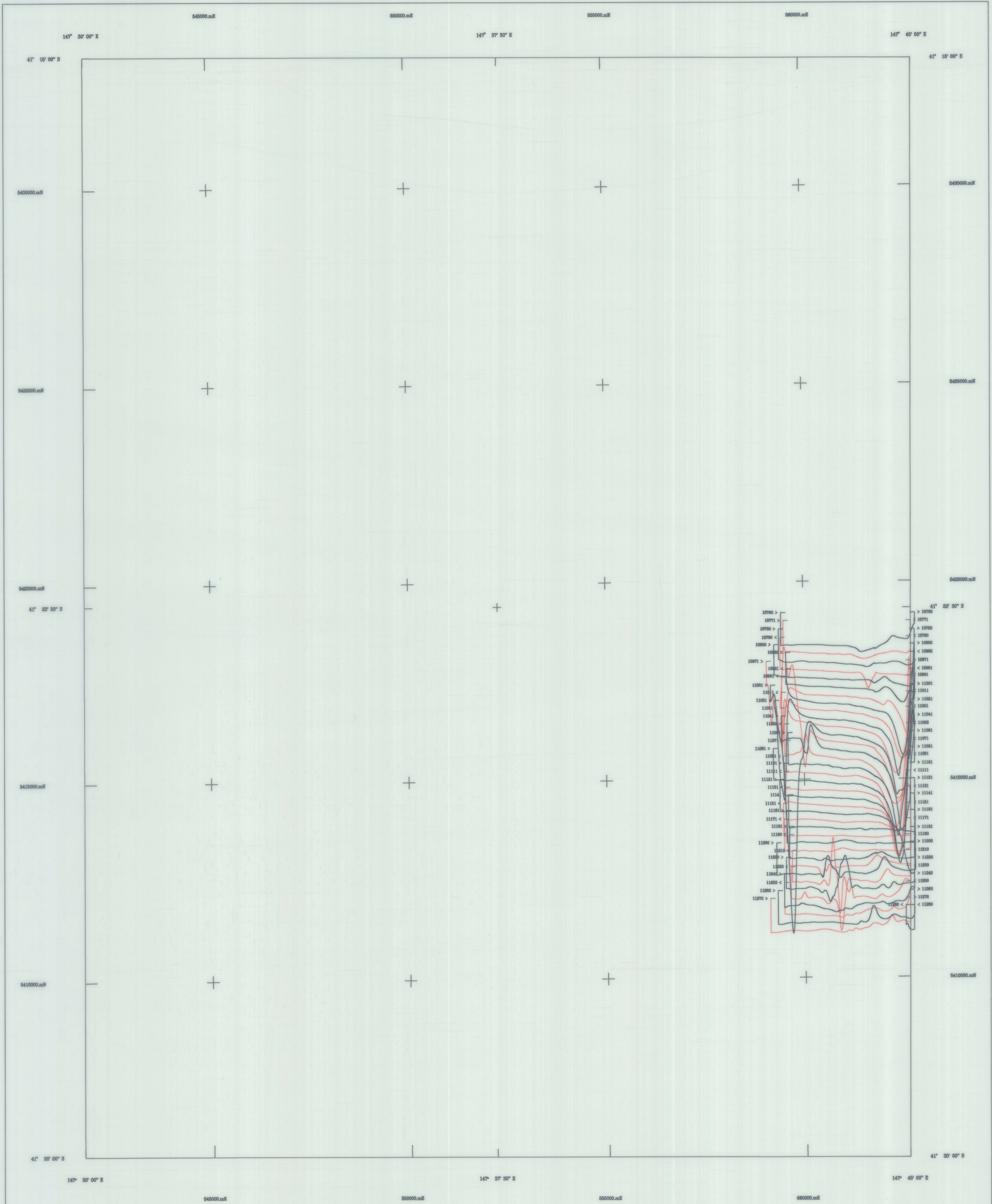

AIRBORNE SURVEY EQUIPMENT

Aircraft	Bell 206 - 3 VH-FHE
Magnetometer	Geomatrix G83 Helium Vapor
Magnetometer Resolution	0.01 nT
Magnetometer Sample Interval	0.20 seconds
Data Acquisition	Geo Instruments Model 2000
Data Recording	1.44 Mb floppy disks
Speedometer	Exploranium G2820
Crystal Size	16.0M downward array
Spectrometer Sample Interval	1.0 Second (approx 35 metres)
Flight Path Record	VHS Colour Video System
GPS Navigation System	Novatel GPS Receiver

AIRBORNE SURVEY SPECIFICATIONS

Flight Line Direction	090 - 270 degrees
Flight Line Separation	200 metres
Tie Line Direction	000 - 180 degrees
Tie Line Separation	400 metres
Terrain Clearance	60 metres (MTC)

TOTAL MAGNETIC INTENSITY STACKED PROFILES

Magnetic variations removed
 IGRF(1990) updated to IGRF(0) removed
 Average survey base station value added to datum
 Datum Base Value 5000 nT
 Vertical Scale 50 nT / cm

Fingal Aeromagnetic Survey
 Tasmania Development and Resources
 Minerals Resources Tasmania
 Surveyed and compiled Geo Instruments Pty. Ltd
 Processed by Kevron Geophysics Pty. Ltd.
 October - November 1993

Mineral Resources Tasmania Reserved
 Project Supervision by Mineral Resources Tasmania

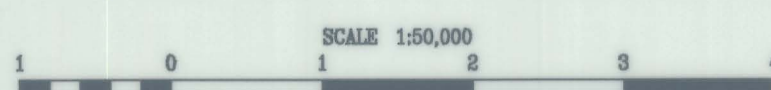

MAP GRID ZONE 55
 SPHEROID : Australian National
 PROJECTION : Universal Transverse Mercator

1:50,000 SHEET LOCATION

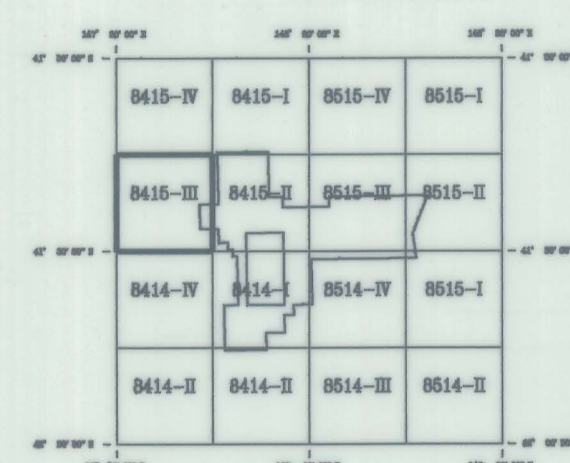

8415-III

