

5 cm

1:50,000 AIRBORNE GEOPHYSICAL SERIES

FINGAL SURVEY

TOTAL MAGNETIC INTENSITY PROFILES
MINERAL RESOURCES TASMANIA

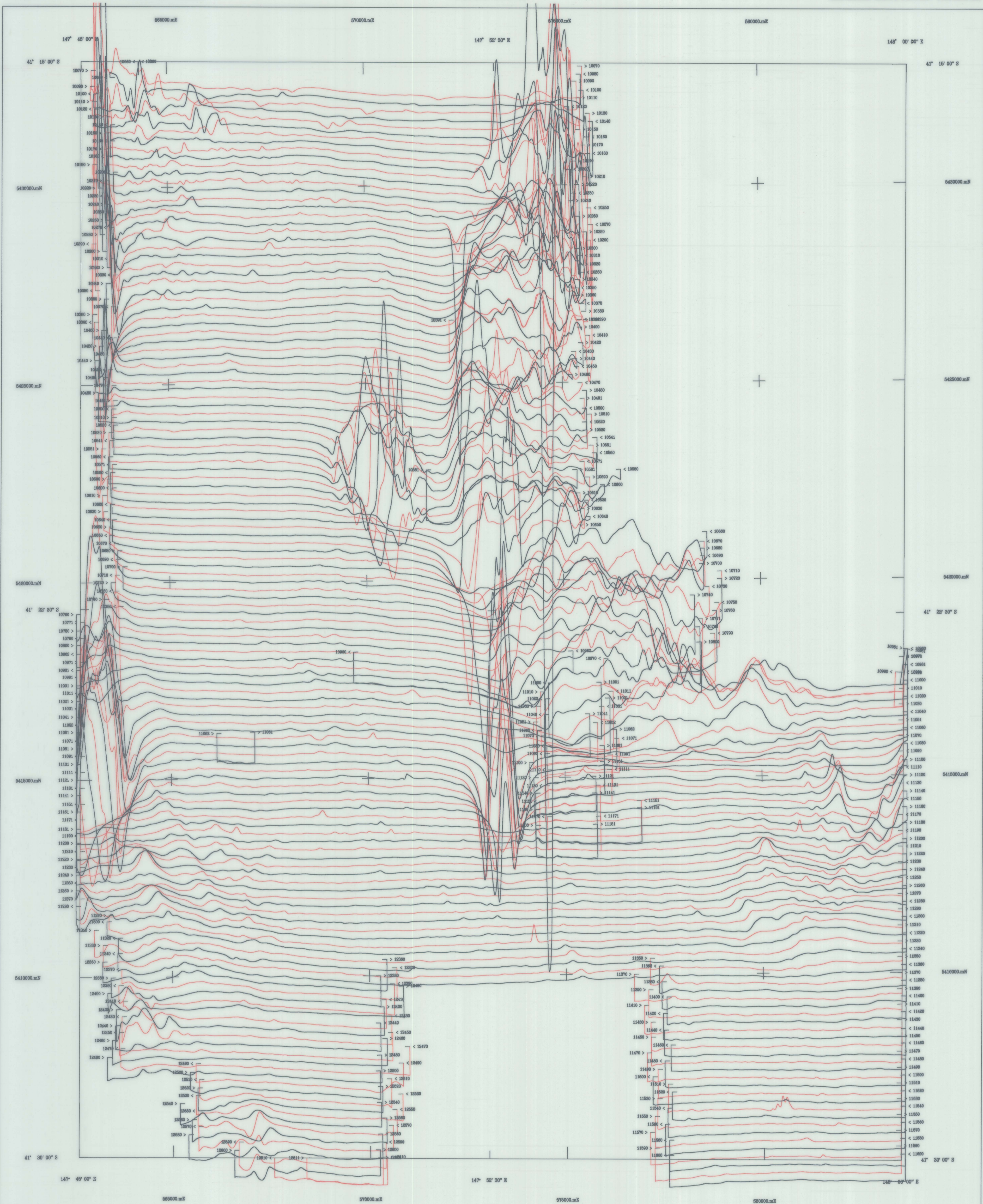

AIRBORNE SURVEY EQUIPMENT

Aircraft: Bell 206 - S VJ-FHE
 Magnetometer: Geometrics G833 Helium Vapour
 Magnetometer Resolution: 0.01 nT
 Magnetometer Sample Interval: 0.20 seconds
 Data Acquisition: Geo Instruments Model 2000
 Data Recording: 1.44 MB floppy disks
 Spectrometer: Epirometric G2050
 Crystal Size: 18.88 diameter array
 Spectrometer Sample Interval: 1.0 Seconds (approx 50 metres)
 Flight Path Record: VHS Colour Video System
 GPS Navigation System: Novatel GPS Receiver

AIRBORNE SURVEY SPECIFICATIONS

Flight Line Direction: 090 - 270 degrees
 Flight Line Separation: 500 metres
 Line Direction: 000 - 180 degrees
 Line Separation: 400 metres
 Terrain Clearance: 80 metres (MFL)

TOTAL MAGNETIC INTENSITY STACKED PROFILES

Diurnal variations removed
 IGRF(1980) updated to 1985B removed
 Average survey base station value added to datum
 Datum Base Value: 5000 nT
 Vertical Scale: 50 nT/cm

Fingal Aeromagnetic Survey
 Tasmania Development and Resources
 Minerals Resources Tasmania
 Surveyed and compiled Geo Instruments Pty. Ltd
 Processed by Kevron Geophysics Pty. Ltd.
 October - November 1993

Mineral Resources Tasmania Reserved
 Project Supervision by Mineral Resources Tasmania

SCALE 1:50,000
 Kilometres
 MAP GRID ZONE 55

SPHEROID : Australian National
 PROJECTION : Universal Transverse Mercator

1:50,000 SHEET LOCATION

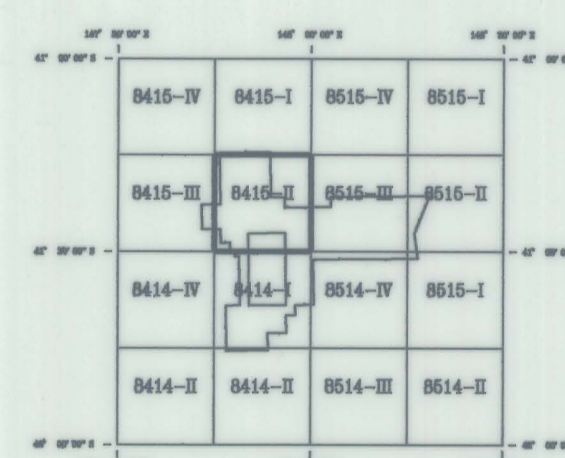

8415-II



Grid North