

1:50,000 AIRBORNE GEOPHYSICAL SERIES

FINGAL SURVEY

TOTAL MAGNETIC INTENSITY PROFILES
MINERAL RESOURCES TASMANIA

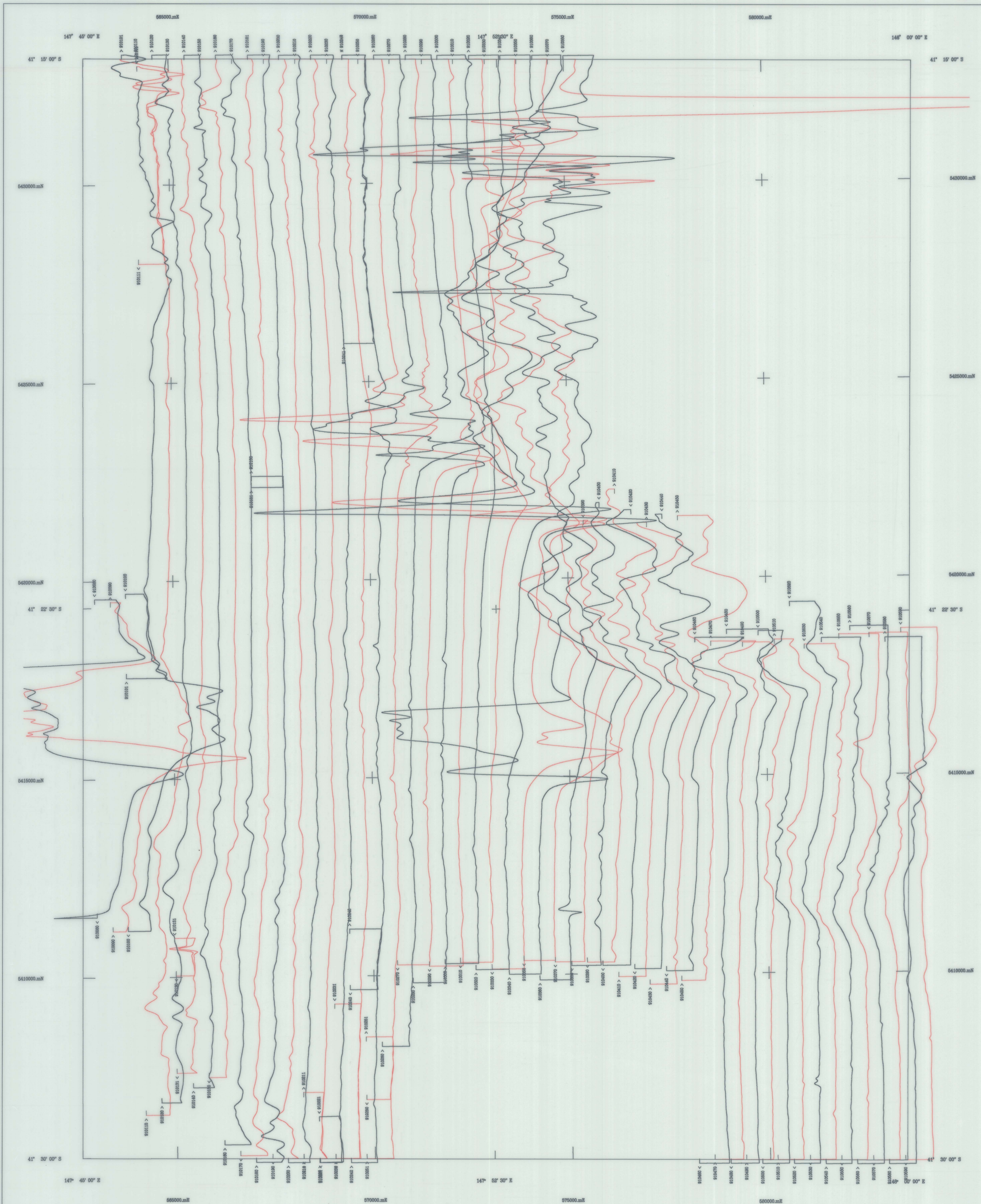

AIRBORNE SURVEY EQUIPMENT

Aircraft: Bell 206 - 3 YF-FSH
Magnetometer: Geometrics G850 Helium Vapor
Magnetometer Resolution: 0.01 nT
Magnetometer Sample Interval: 0.25 seconds
Data Acquisition: Geo Instruments Model 2000
Data Recording: 1.44 MB floppy disks
Spectrometer: RepRap/Amis G850
Crystal Size: 18.0mm diameter array
Spectrometer Sample Interval: 1.0 Seconds (approx 50 metres)
Flight Path Record: VHS Colour Video System
GPS Navigation System: Novatel GPS Receiver

AIRBORNE SURVEY SPECIFICATIONS

Flight Line Direction: 090 - 270 degrees
Flight Line Separation: 200 metres
Tie Line Direction: 000 - 180 degrees
Tie Line Separation: 400 metres
Terrain Clearance: 80 metres (MTC)

TOTAL MAGNETIC INTENSITY STACKED PROFILES

Diurnal variations removed
IGMF(1960) updated to 1963.8 removed
Average survey base station value added to datum
Datum Base Value: 5000 nT
Vertical Scale: 50 nT / cm

Fingal Aeromagnetic Survey
Tasmania Development and Resources
Minerals Resources Tasmania
Surveyed and compiled Geo Instruments Pty. Ltd
Processed by Kevron Geophysics Pty. Ltd.
October - November 1993

Mineral Resources Tasmania Reserved
Project Supervision by Mineral Resources Tasmania

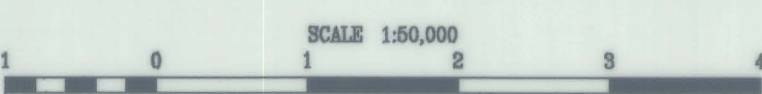

SPHEROID: Australian National
PROJECTION: Universal Transverse Mercator

1:50,000 SHEET LOCATION

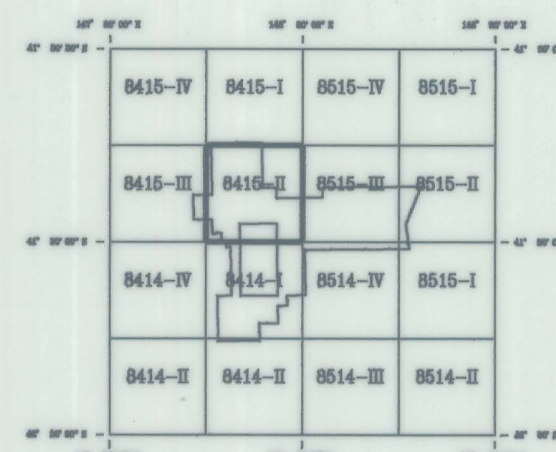

8415-II