

1:50,000 AIRBORNE GEOPHYSICAL SERIES

FINGAL SURVEY

TOTAL MAGNETIC INTENSITY PROFILES
MINERAL RESOURCES TASMANIA

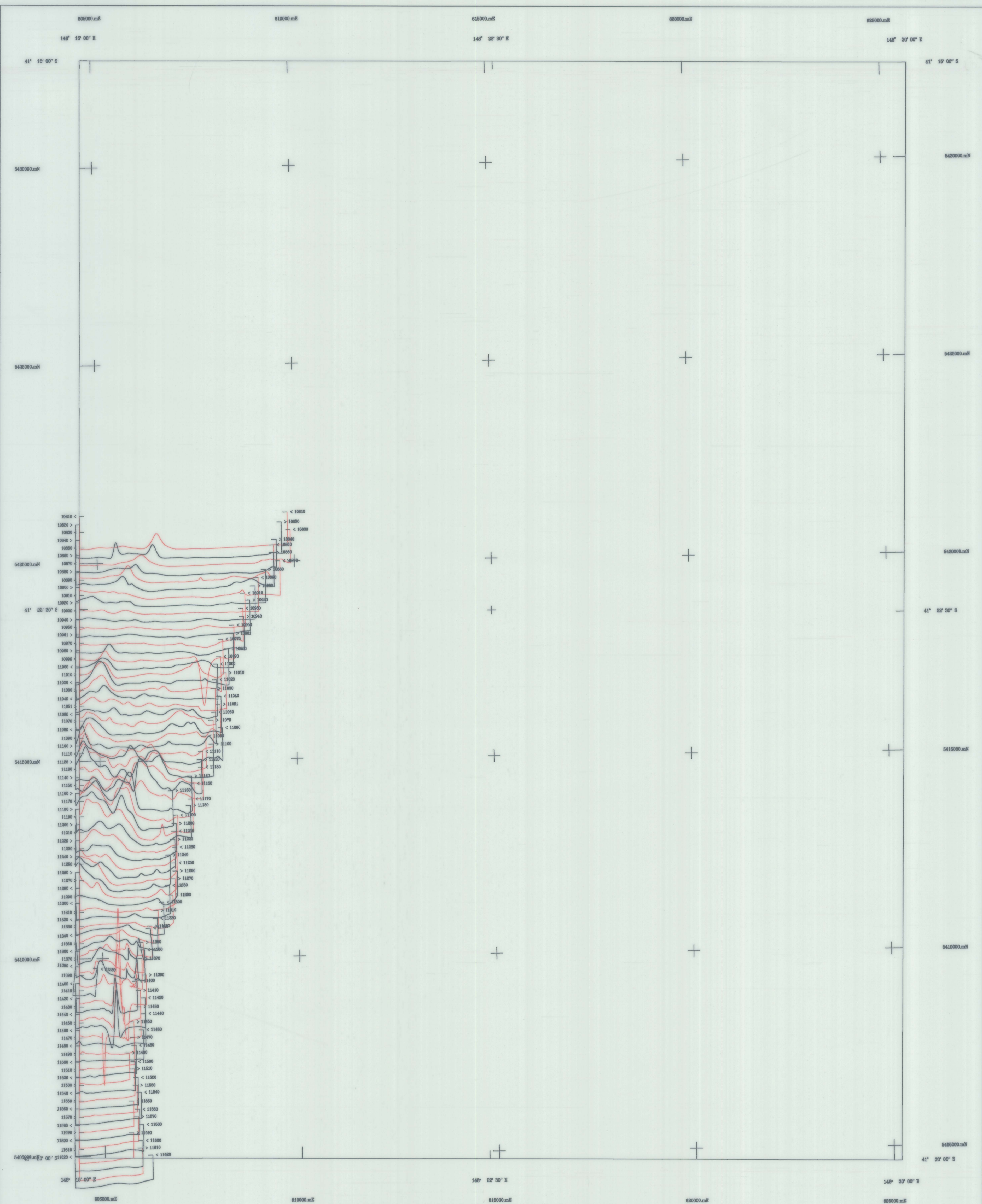

AIRBORNE SURVEY EQUIPMENT

Aircraft	Bell 206 - 3 YH-YEH
Magnetometer	Geometrics G833 Helium Vapour
Magnetometer Resolution	0.01 nT
Magnetometer Sample Interval	0.20 seconds
Data Acquisition	Geo Instruments Model 2000
Data Recording	1.44 Mb floppy disks
Spectrometer	Exploranium GS220
Crystal Size	18.00 downward array
Spectrometer Sample Interval	1.0 Seconds (approx 35 metres)
Flight Path Record	VHS Colour Video System
GPS Navigation System	Kernal GPS Receiver

AIRBORNE SURVEY SPECIFICATIONS

Flight Line Direction	090 - 270 degrees
Flight Line Separation	200 metres
The Line Direction	000 - 180 degrees
The Line Separation	400 metres
Terrain Clearance	60 metres (MTC)

TOTAL MAGNETIC INTENSITY STACKED PROFILES

Diurnal variations removed
IGRF(1990) updated to 1993.6 removed
Average survey base station value added to datum
Datum Base Value 62000 nT
Vertical Scale 50 nT / cm

Fingal Aeromagnetic Survey

Tasmania Development and Resources
Minerals Resources Tasmania
Surveyed and compiled Geo Instruments Pty. Ltd
Processed by Kevron Geophysics Pty. Ltd.
October - November 1993

Mineral Resources Tasmania Reserved
Project Supervision by Mineral Resources Tasmania

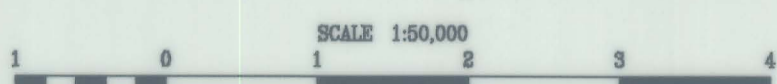

SPHEROID : Australian National
PROJECTION : Universal Transverse Mercator

1:50,000 SHEET LOCATION

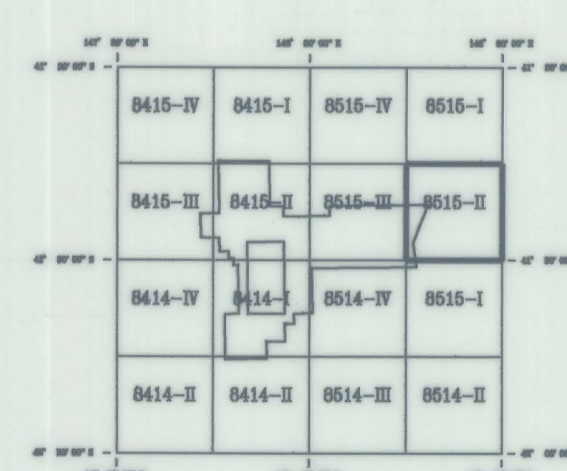

8515-II