

1:50,000 AIRBORNE GEOPHYSICAL SERIES

FINGAL SURVEY

TOTAL MAGNETIC INTENSITY PROFILES  
MINERAL RESOURCES TASMANIA



AIRBORNE SURVEY EQUIPMENT

Aircraft: Bell 206 - 3 VH-FHE  
Magnetometer: Geometrics GSS3 Helium Vapor  
Magnetometer Resolution: 0.01 nT  
Magnetometer Sample Interval: 0.20 seconds  
Data Acquisition: Geo Instruments Model 2000  
Data Recording: 1.44 MB floppy disks  
Spectrometer: Exploration GR200  
Crystal Size: 14.000 downwards array  
Spectrometer Sample Interval: 1.0 seconds (approx 35 metres)  
Flight Path Record: VIS Colour Video System  
GPS Navigation System: Kovalid GPS Receiver

AIRBORNE SURVEY SPECIFICATIONS

Flight Line Direction: 000 - 270 degrees  
Flight Line Separation: 500 metres  
To Line Direction: 000 - 180 degrees  
To Line Separation: 400 metres  
Terrain Clearance: 80 metres (MFC)

TOTAL MAGNETIC INTENSITY STACKED PROFILES

Diurnal variations removed  
MRF(1990) updated to 1983.8 removed  
Average survey base station value added to datum  
Datum Base Value: 5000 nT  
Vertical Scale: 50 nT / cm

Fingal Aeromagnetic Survey  
Tasmania Development and Resources  
Minerals Resources Tasmania  
Surveyed and compiled Geo Instruments Pty. Ltd  
Processed by Kevron Geophysics Pty. Ltd.  
October - November 1993

Mineral Resources Tasmania Reserved  
Project Supervision by Mineral Resources Tasmania

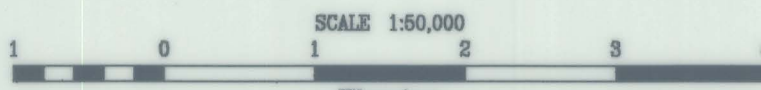

MAP GRID ZONE 56  
SPHEROID: Australian National  
PROJECTION: Universal Transverse Mercator

1:50,000 SHEET LOCATION

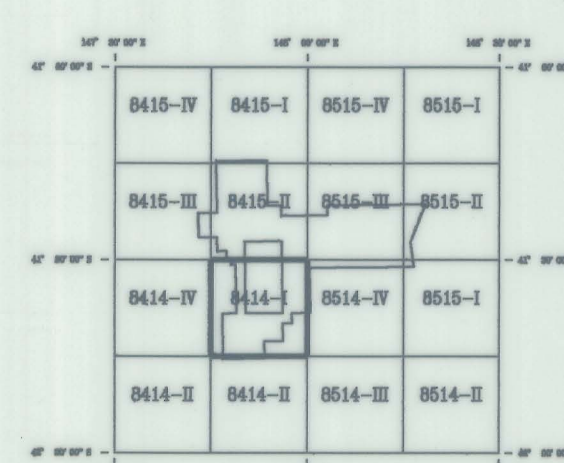

8414-I

