

1:50,000 AIRBORNE GEOPHYSICAL SERIES

FINGAL SURVEY

TOTAL MAGNETIC INTENSITY PROFILES
MINERAL RESOURCES TASMANIA

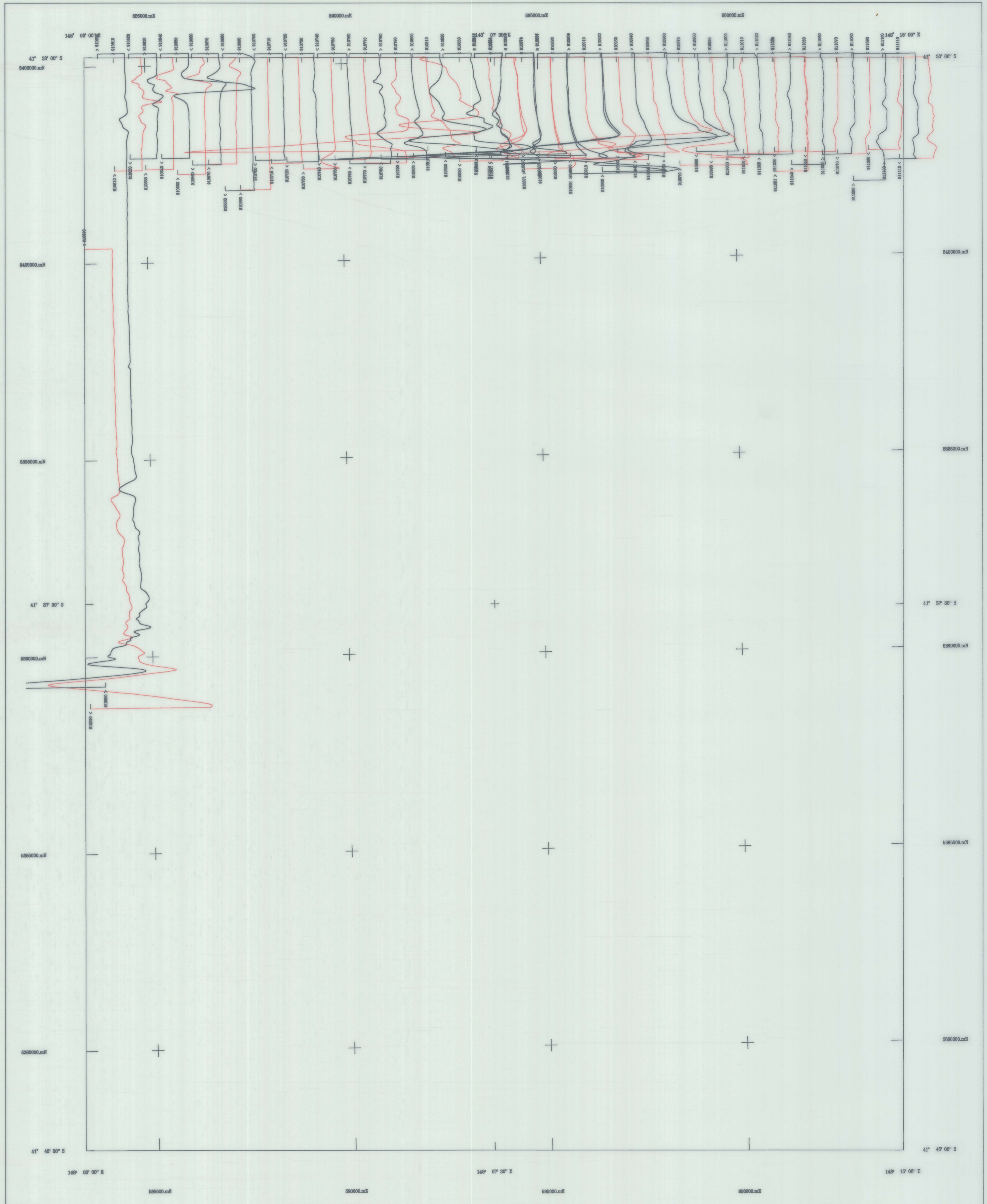

AIRBORNE SURVEY EQUIPMENT

Aircraft	Bell 206 - 3 VII-FH
Magnetometer	Geometrics G833 Helium Vapor
Magnetometer Resolution	0.01 nT
Magnetometer Sample Interval	0.20 seconds
Data Acquisition	Geo Instruments Model 2000
Data Recording	1.44 MB floppy disks
Spectrometer	Exploremat G8500
Crystal Size	18.816 frequency array
Spectrometer Sample Interval	1.0 Seconds (approx 55 metres)
Flight Path Record	VHS Colour Video System
GPS Navigation System	Novatel GPS Receiver

AIRBORNE SURVEY SPECIFICATIONS

Flight Line Direction	000 - 270 degrees
Flight Line Separation	400 metres
Line Direction	000 - 180 degrees
The Line Separation	400 metres
Terrain Clearance	60 metres (MTC)

TOTAL MAGNETIC INTENSITY STACKED PROFILES

Diurnal variations removed
IGSF(1990) updated to 1993.8 removed
Average survey base station value added to datum
Datum Base Value 5000 nT
Vertical Scale 50 nT / cm

Fingal Aeromagnetic Survey
Tasmania Development and Resources
Minerals Resources Tasmania
Surveyed and compiled Geo Instruments Pty. Ltd
Processed by Kevron Geophysics Pty. Ltd.
October - November 1993

Mineral Resources Tasmania Reserved
Project Supervision by Mineral Resources Tasmania

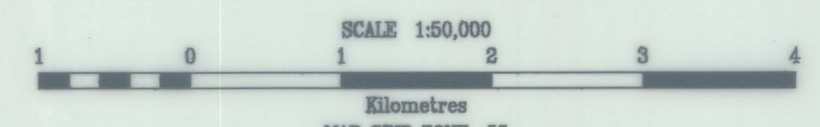

SPHEROID : Australian National
PROJECTION : Universal Transverse Mercator

1:50,000 SHEET LOCATION

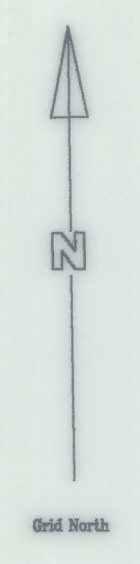
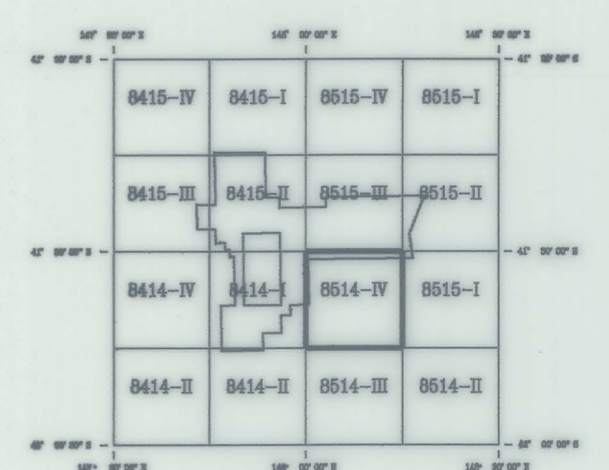

8514-IV