

1:50,000 AIRBORNE GEOPHYSICAL SERIES

FINGAL SURVEY

TOTAL MAGNETIC INTENSITY PROFILES  
MINERAL RESOURCES TASMANIA

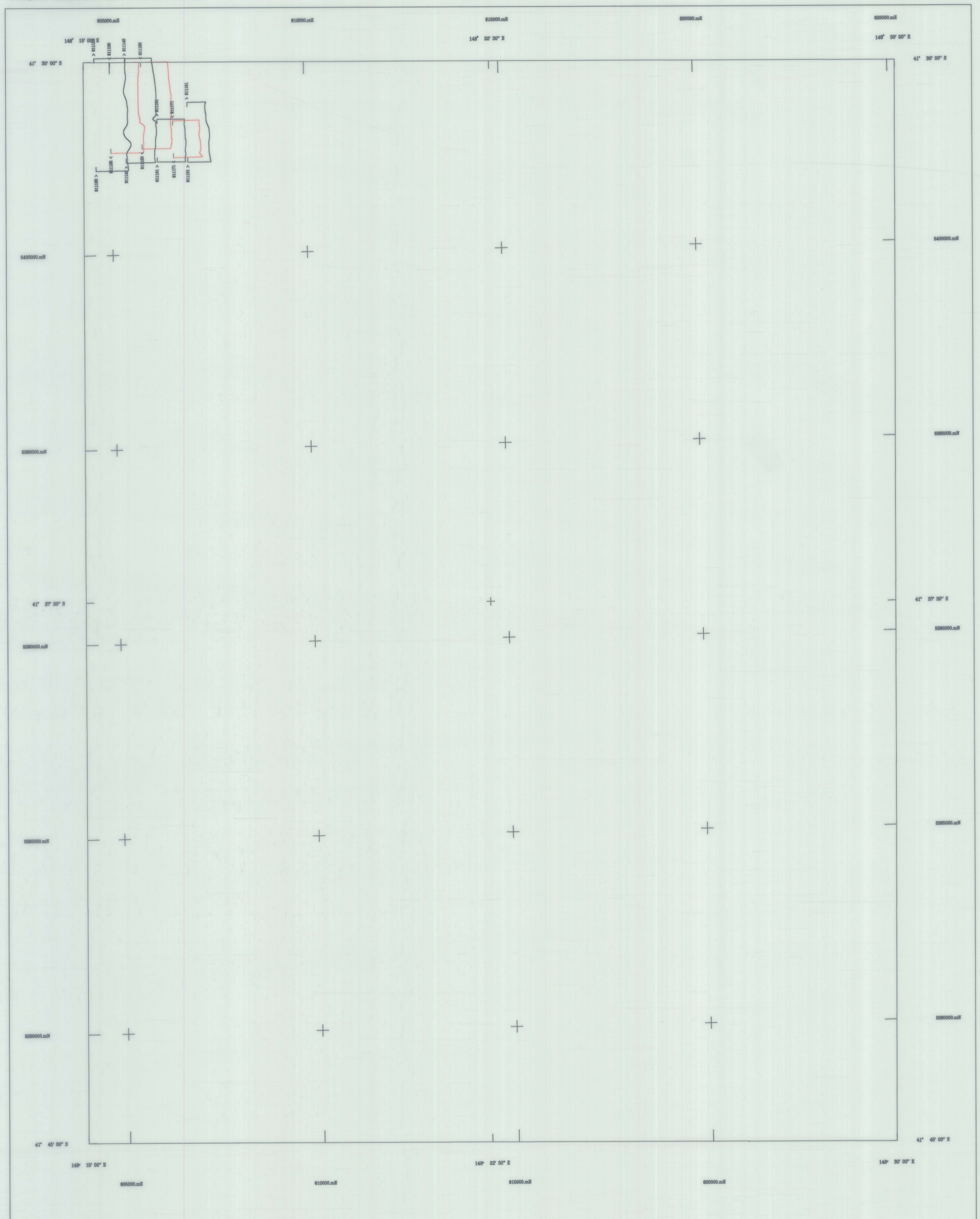

**AIRBORNE SURVEY EQUIPMENT**

Aircraft  
Magnetometer  
Magnetometer Resolution  
Magnetometer Sample Interval  
Data Acquisition  
Data Recording  
Spectrometer  
Crystal Size  
Spectrometer Sample Interval  
Flight Path Record  
GPS Navigation System

Dall 208 - 3 VII-FHE  
Geomatrix GRS3 Helium Vapour  
0.01 nT  
0.20 seconds  
Geo Instruments Model 2000  
1.44 Mb floppy disks  
Exploremat GRS20  
18/18 downward array  
1.0 Seconds (approx 30 metres)  
VHS Colour Video System  
Novatel GPS Receiver

**AIRBORNE SURVEY SPECIFICATIONS**

Flight Line Direction  
Flight Line Separation  
Line Direction  
Line Separation  
Terrain Clearance

090 - 270 degrees  
200 metres  
000 - 180 degrees  
400 metres  
60 metres (MTC)

**TOTAL MAGNETIC INTENSITY STACKED PROFILES**

Diurnal variations removed  
1987(1990) updated to 1983.3 removed  
Average survey base station value added to datum  
Datum Base Value 5000 nT  
Vertical Scale 50 nT / cm

**Fingal Aeromagnetic Survey**  
Tasmania Development and Resources  
Minerals Resources Tasmania  
Surveyed and compiled Geo Instruments Pty. Ltd  
Processed by Kevron Geophysics Pty. Ltd.  
October - November 1993

Mineral Resources Tasmania Reserved  
Project Supervision by Mineral Resources Tasmania

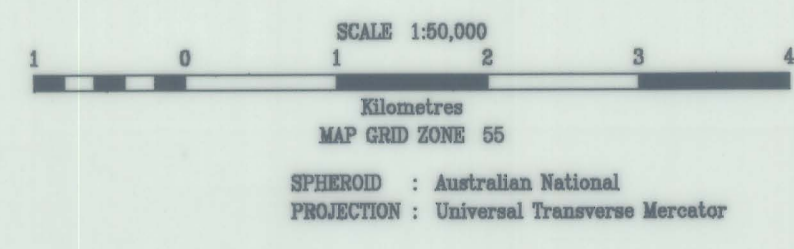

1:50,000 SHEET LOCATION

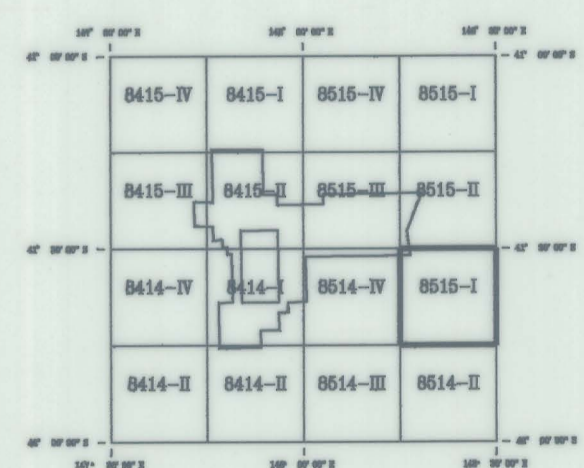

8515-I