

5 cm

1:50,000 AIRBORNE GEOPHYSICAL SERIES

FINGAL SURVEY

FLIGHT PATH  
MINERAL RESOURCES TASMANIA

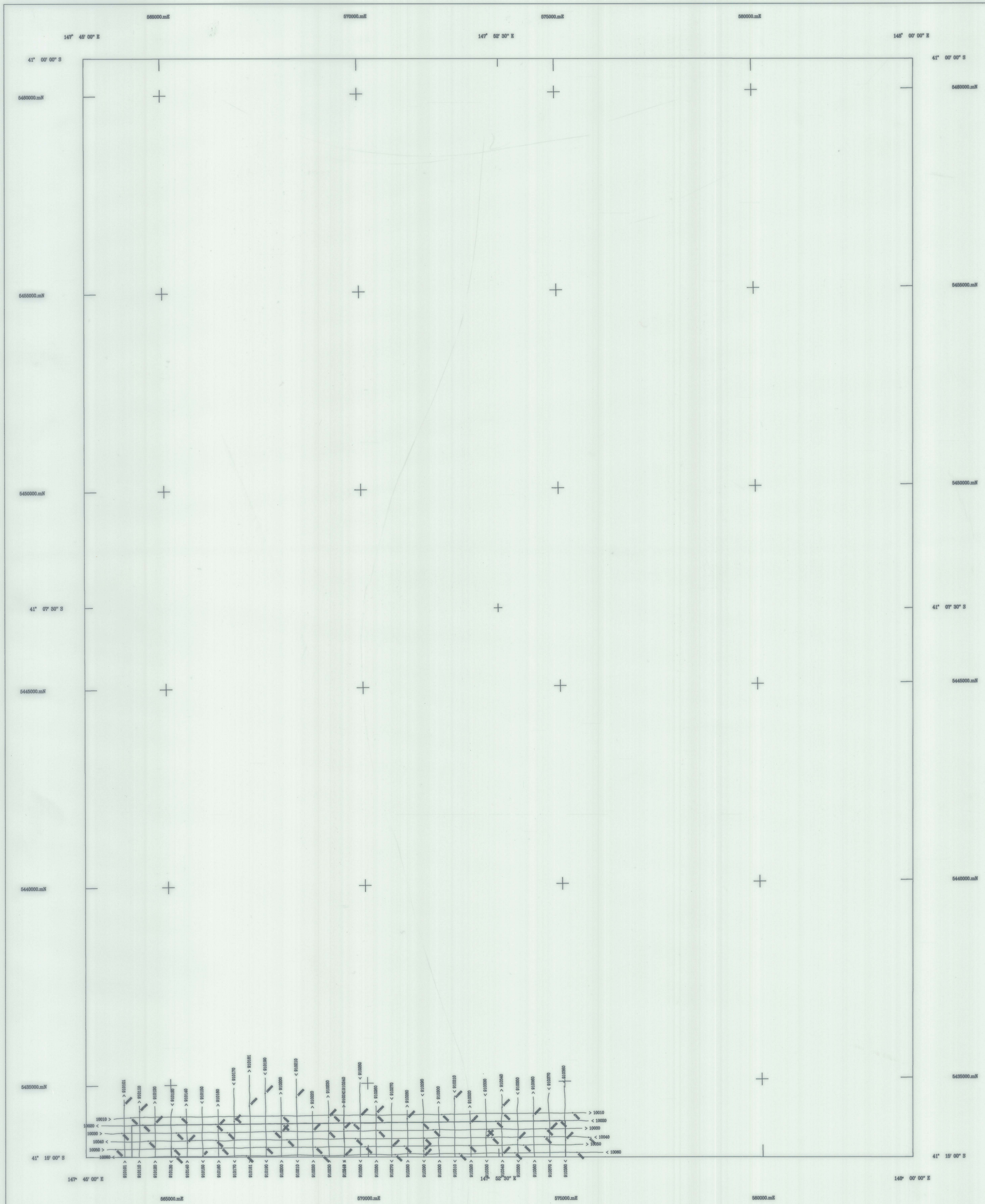

**AIRBORNE SURVEY EQUIPMENT**

Aircraft  
 Magnetometer  
 Magnetometer Resolution  
 Magnetometer Sample Interval  
 Data Acquisition  
 Data Recording  
 Spectrometer  
 Crystal Size  
 Spectrometer Sample Interval  
 Flight Path Record  
 GPS Navigation System

Bell 206 - 3 VI-PEH  
 Geometrics G530 Bellini Taper  
 0.01 uT  
 0.20 seconds  
 Geo Instruments Model 2000  
 1.44 Mb floppy disks  
 Spectrometer G2550  
 18.5M downward array  
 1.0 Seconds (approx 55 metres)  
 VHS Colour Video System  
 Novatel GPS Receiver

**AIRBORNE SURVEY SPECIFICATIONS**

Flight Line Direction  
 Flight Line Separation  
 Line Direction  
 Line Separation  
 Terrain Clearance

090 - 270 degrees  
 200 metres  
 000 - 180 degrees  
 400 metres  
 60 metres (MFC)

**FLIGHT PATH PROCESSING**

Flight path calculated from differentially corrected GPS data using a Novatel GPS Receiver  
 GPS navigation data differentially corrected in real time.  
 GPS Base Station Base at S 41 31' 00.248\"/>

**Fingal Aeromagnetic Survey**  
 Tasmania Development and Resources  
 Minerals Resources Tasmania  
 Surveyed and compiled Geo Instruments Pty. Ltd  
 Processed by Kevron Geophysics Pty. Ltd.  
 October - November 1993

Mineral Resources Tasmania Reserved  
 Project Supervision by Mineral Resources Tasmania

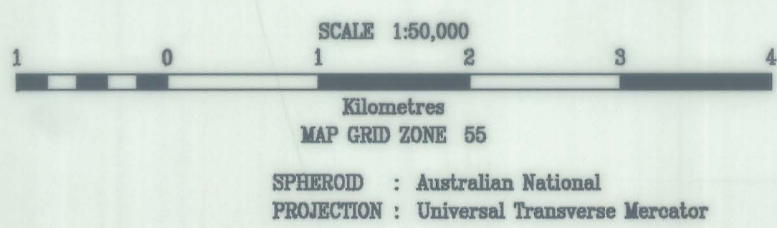

**1:50,000 SHEET LOCATION**

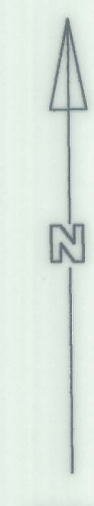
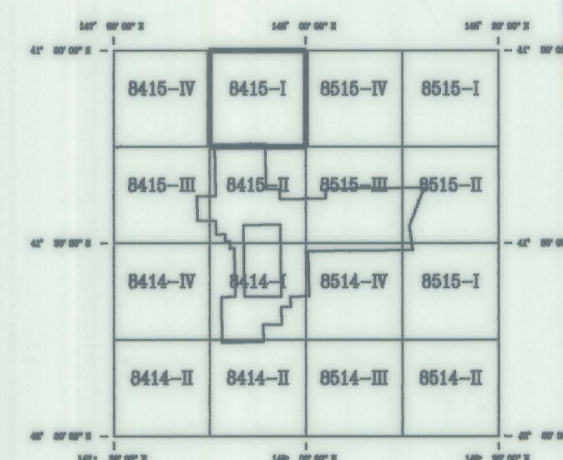

8415-I