

# 5482A

856

490000E

495000E

500000E

505000E

40°50'00"S

40°55'00"S

41°00'00"S

41°05'00"S

### AIRBORNE SURVEY SPECIFICATIONS

MAGNETOMETER : Cesium Vapour optical absorption  
Sensitivity : 0.001 nT

RECORDING INTERVAL : 0.1 sec (approx 7 m sampling)  
at mean ground speed of 250 km/hour

SPECTROMETER : Nuclear Data 256 channel ADC  
Volume : 33.5 litres

TOTAL COUNT WINDOW : 0.4 - 3.00 MeV

POTASSIUM WINDOW : 1.35 - 1.57 MeV

URANIUM WINDOW : 1.63 - 1.89 MeV

THORIUM WINDOW : 2.42 - 2.82 MeV

RECORDING INTERVAL : 1.0 sec (approx 70 m sampling)  
at mean ground speed of 250 km/hour

DATA RECORDING : Geotrex MADACS acquisition system  
Digital to magnetic tape

NOMINAL TERRAIN CLEARANCE : Both detectors in aircraft at 80 m

NOMINAL LINE SPACING : Traverse lines 400 m  
The lines 400 m

FLIGHT PATH NAVIGATION : SERCEL NDS100 Real time UHF Differential  
GPS system with SINGER KEARFOOT AN/ASN 128  
Doppler system with SPERRY C12 compass and  
VG14 vertical gyro

FLIGHT PATH RECORD : XY coordinates computed from WGS84 lat/long  
coordinates recorded by SERCEL NDS100 Real  
time UHF Differential GPS system

5475000N

### FLIGHT PATH

Grid notation refers to Australian Map Grid Zone 55  
Navigation Fix 32768

5470000N

5465000N

5460000N

5455000N

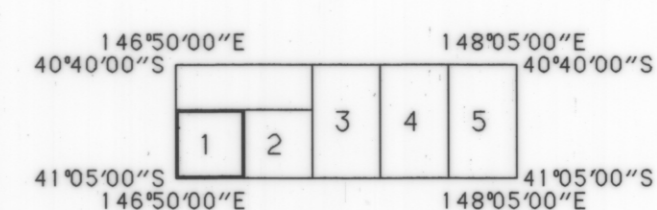
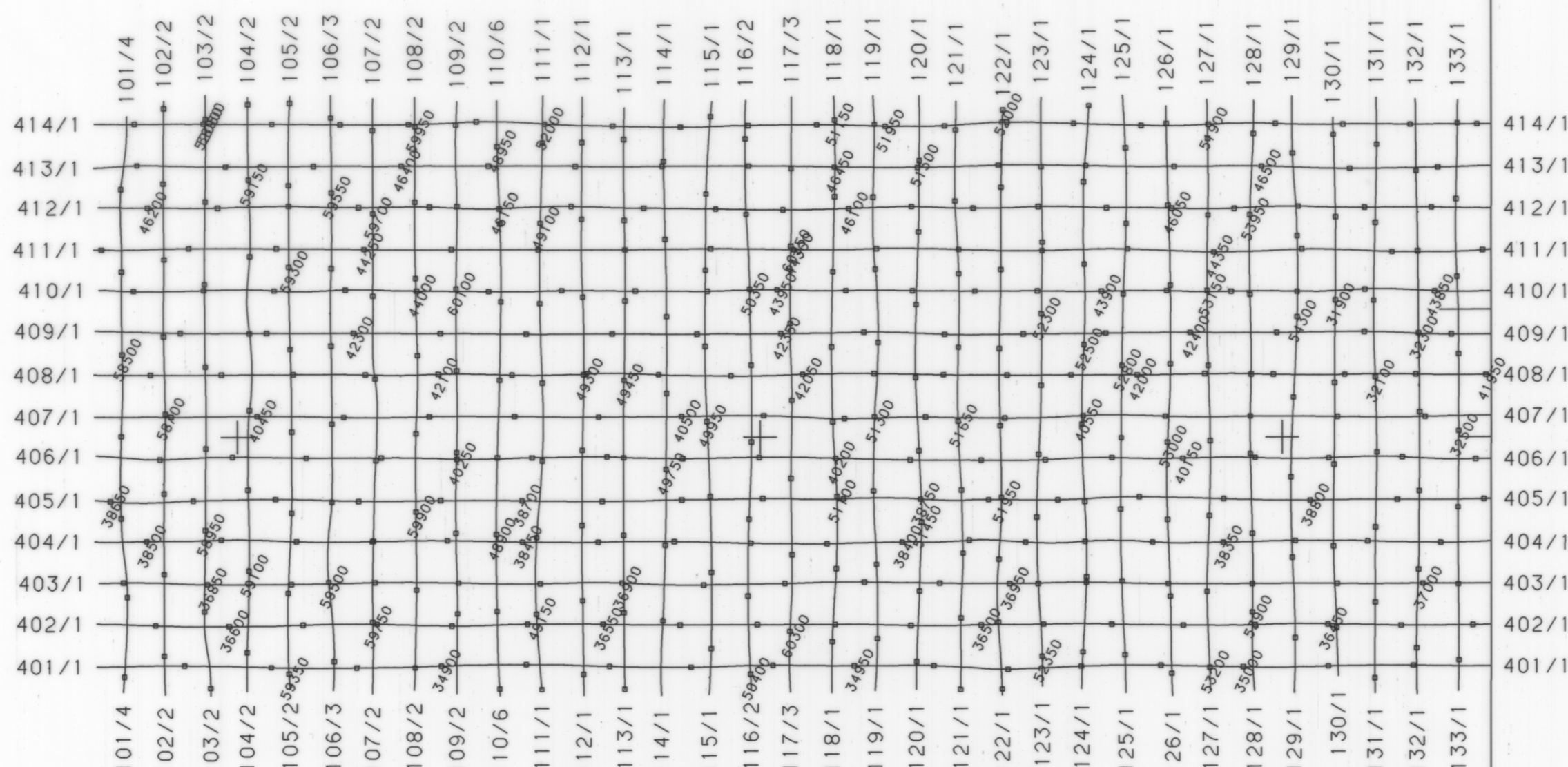

CROWN COPYRIGHT RESERVED

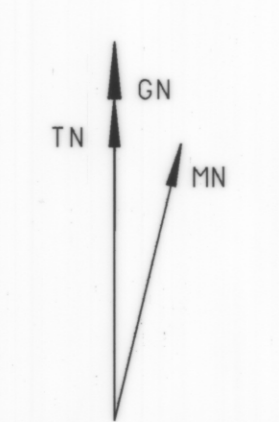

Grid Convergence = 0.03°  
Declination = 13.50°

SCALE 1:50000

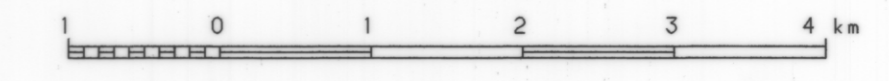

JOB NO : 1-451  
Surveyed by GEOTERREX PTY LTD : November 1993  
Compiled by GEOTERREX PTY LTD, SYDNEY  
Processed by GEOTERREX PTY LTD, SYDNEY

**MINERAL RESOURCES TASMANIA**  
**WEYMOUTH-TOMAHAWK ALL LINES**  
**FLIGHT PATH**  
**LAUNCESTON SK55-4**  
**SHEET 1 OF 5**

CREATED : MP  
CHECKED : HS

DRAWING NO :  
DATE : 21-JAN-1994

5482A

146°50'00"E

146°55'00"E

147°00'00"E

147°05'00"E