

510000E 515000E 520000E 525000E

40°50'00"S

40°55'00"S

41°00'00"S

41°05'00"S

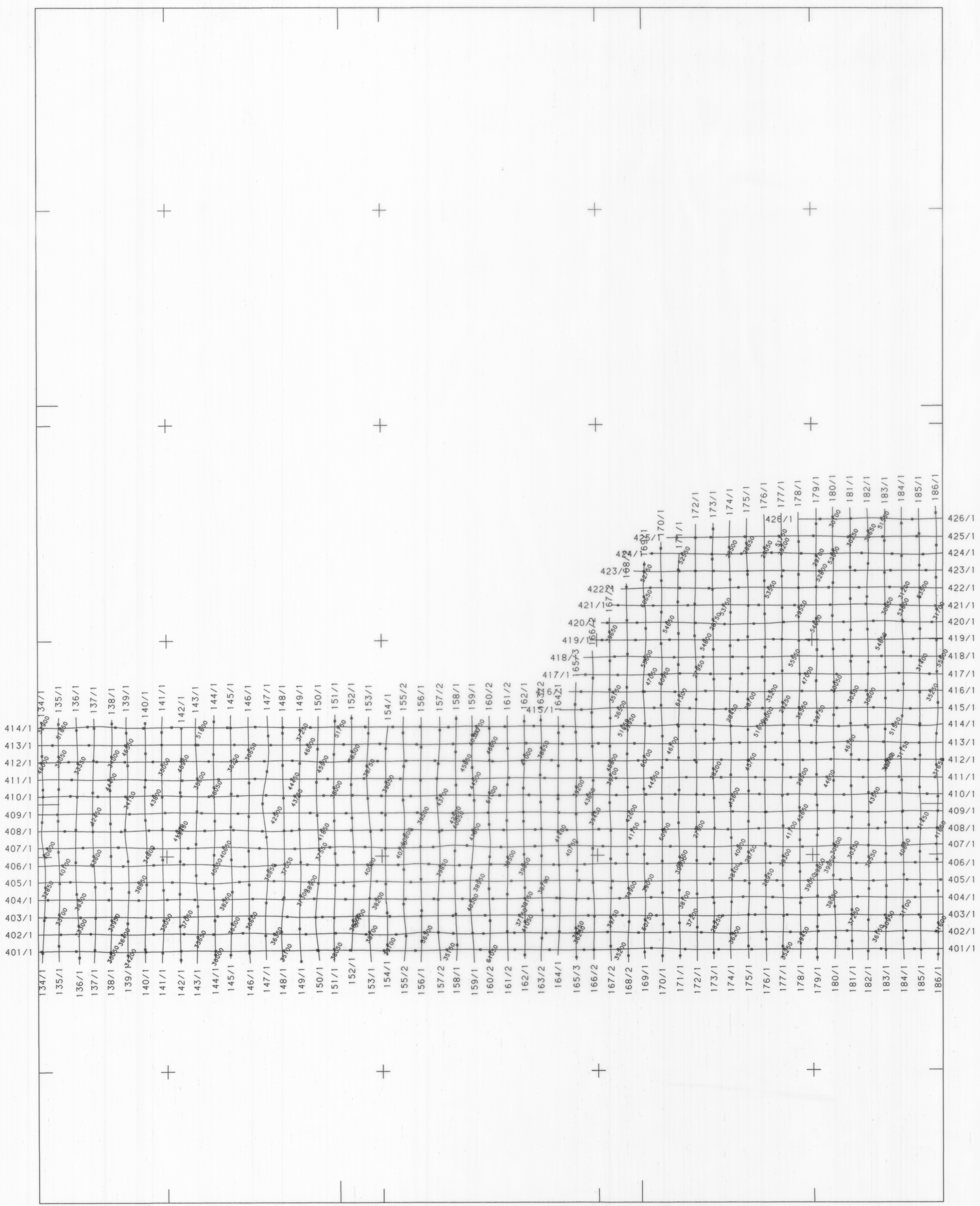

AIRBORNE SURVEY SPECIFICATIONS

MAGNETOMETER : Caesium Vapour optical absorption
Sensitivity : 0.001 nT

RECORDING INTERVAL : 0.1 sec (approx 7 m sampling)
at mean ground speed of 250 km/hour

SPECTROMETER : Nuclear Data 256 channel ADC
Volume : 33.5 litres
0.4 - 3.00 MeV

TOTAL COUNT WINDOW : 1.35 - 1.57 MeV

POTASSIUM WINDOW : 1.63 - 1.89 MeV

URANIUM WINDOW : 2.42 - 2.82 MeV

RECORDING INTERVAL : 1.0 sec (approx 70 m sampling)
at mean ground speed of 250 km/hour

DATA RECORDING : Geotrex MADACS acquisition system
Digital to magnetic tape

NOMINAL TERRAIN CLEARANCE : Both detectors in aircraft at 80 m

NOMINAL LINE SPACING : Traverse lines 400 m
Tie lines 400 m

FLIGHT PATH NAVIGATION : SERCEL NDS100 Real time UHF Differential
GPS system with SINGER KEARFOOT AN/ASN 128
Doppler system with SPERRY C12 compass and
VG14 vertical gyro

FLIGHT PATH RECORD : XY coordinates computed from WGS84 lat/long
coordinates recorded by SERCEL NDS100 Real
time UHF Differential GPS system

5475000N

5470000N

5465000N

5460000N

5455000N

FLIGHT PATH

Grid notation refers to Australian Map Grid Zone 55
Navigation fix 32768

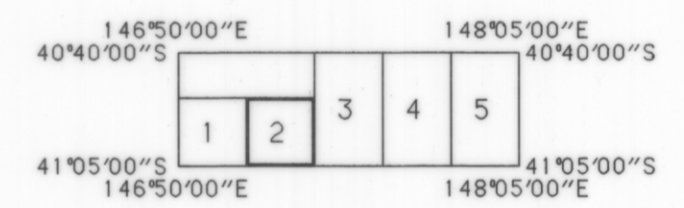

CROWN COPYRIGHT RESERVED

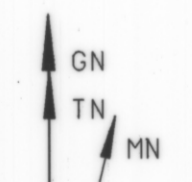

Grid Convergence = -0.14'
Declination = 13.50'

SCALE 1:50000

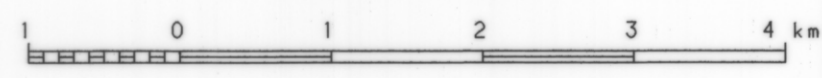

JOB NO : 1-451
Surveyed by GEOTERREX PTY LTD : November 1993
Compiled by GEOTERREX PTY LTD, SYDNEY
Processed by GEOTERREX PTY LTD, SYDNEY

MINERAL RESOURCES TASMANIA
WEYMOUTH-TOMAHAWK ALL LINES
FLIGHT PATH
LAUNCESTON SK55-4
SHEET 2 OF 5

CREATED : MP
CHECKED : MS
DRAWING NO :
DATE : 21-JAN-1994

147°05'00"E 147°10'00"E 147°15'00"E 147°20'00"E