

550000E 555000E 560000E 565000E 570000E

40°40'00"S

40°45'00"S

40°50'00"S

40°55'00"S

41°00'00"S

41°05'00"S

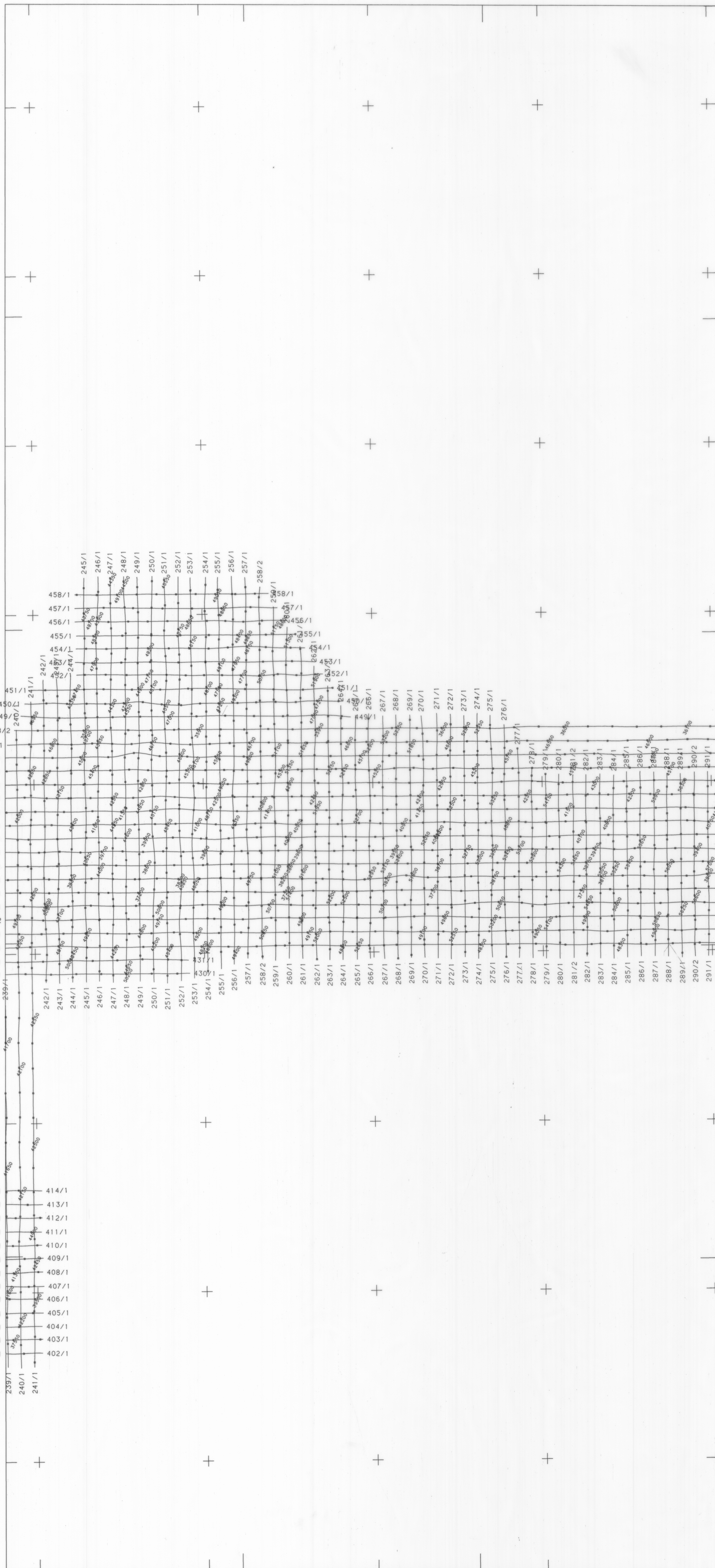

147°55'00"E

147°40'00"E

147°45'00"E

147°50'00"E

AIRBORNE SURVEY SPECIFICATIONS

MAGNETOMETER : Cesium Vapour optical absorption
Sensitivity : 0.001 at
RECORDING INTERVAL : 0.1 sec (approx 7 m sampling)
SPECTROMETER : at mean ground speed of 250 km/hour
Nuclear Data 256 channel ADC
Volume : 35.5 litres
TOTAL COUNT WINDOW : 0.4 - 3.00 MeV
POTASSIUM WINDOW : 1.35 - 1.57 MeV
URANIUM WINDOW : 1.63 - 1.89 MeV
THORIUM WINDOW : 2.42 - 2.62 MeV
RECORDING INTERVAL : 1.0 sec (approx 70 m sampling)
at mean ground speed of 250 km/hour
Geoterra MADACS acquisition system
Digital to magnetic tape
Both detectors in aircraft at 80 m
Traverse lines 400 m
FLIGHT PATH NAVIGATION : TRACER 400 R
SERCEL NDS100 Real time UHF Differential
GPS system with SINGER REARFOOT AN/ASN 128
Display system with SPERRY C12 compass and
VD14 vertical gyro
XT coordinates computed from WGS84 lat/long
coordinates recorded by SERCEL NDS100 Real
time UHF Differential GPS system

FLIGHT PATH

Grid notation refers to Australian Map Grid Zone 55
Navigation fix 32748

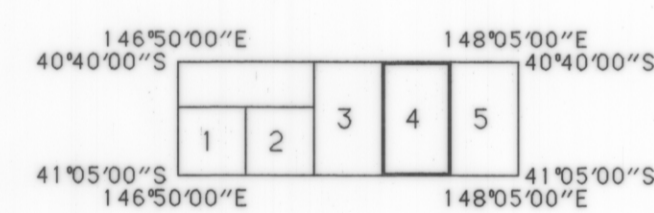

CROWN COPYRIGHT RESERVED

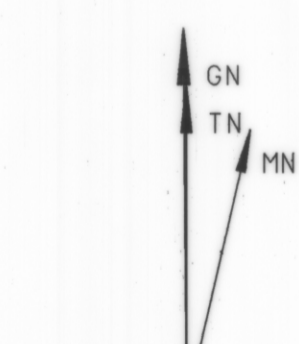

SCALE 1:50000

JOB NO : 1-451
Surveyed by GEOTERREX PTY LTD, November 1993
Compiled by GEOTERREX PTY LTD, SYDNEY
Processed by GEOTERREX PTY LTD, SYDNEY

MINERAL RESOURCES TASMANIA
WEYMOUTH-TOMAHAWK ALL LINES
FLIGHT PATH
LAUNCESTON SK55-4
SHEET 4 OF 5

CREATED : MP
CHECKED : MS
DRAWING NO :
DATE : 21-JAN-1994