

5 cm

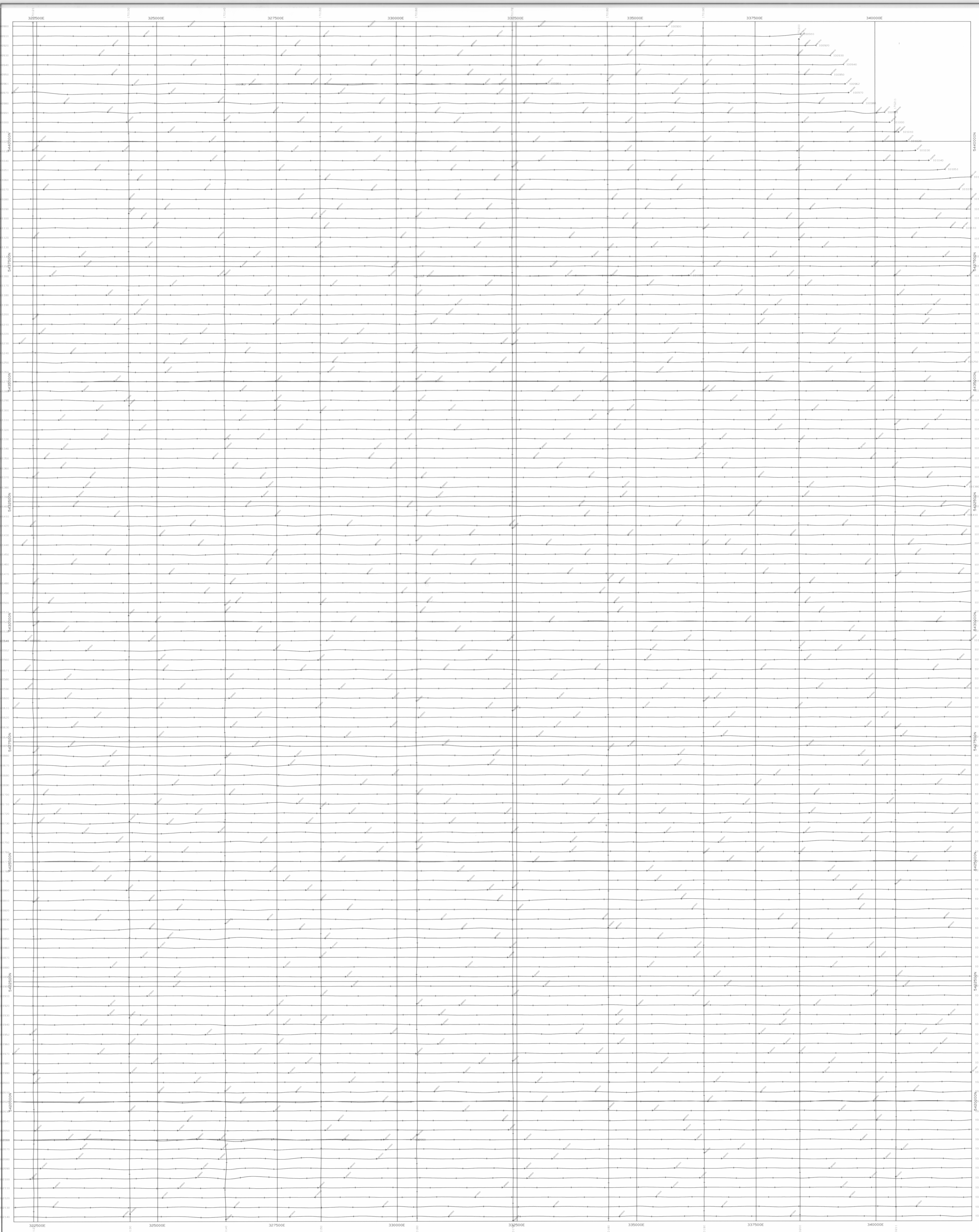

AIRBORNE SURVEY SPECIFICATIONS

ACQUISITION BY: **TESLA AIRBORNE GEOSCIENCE**

JOB No. 142234
 DATE OF SURVEY: April 1996
 MAGNETOMETER: Scintrex Desim Vapour Model 025
 Resolution 0.05nT
 SPECTROMETER: Epiromium GR800
 Crystal volume 33.5 litres
 RECORDING INTERVAL: Magnetometer 0.1 sec (approx 7s)
 Spectrometer 1.0 sec (approx 70s)
 TERRAIN CLEARANCE: 90m
 LINE SPACING: 200m flight lines, 2000m tie lines
 LINE DIRECTION: E-W flight lines, N-S tie lines
 NAVIGATION: Novatel GPS
 ACQUISITION SYSTEM: Differentially Post Processed
 Tesla TAG3

DATA PROCESSING

PROCESSING BY: **TESLA-10**

SYSTEM PARALLAX REMOVED

MAP PRESENTATION

PROJECTION: UTM
 GRID COORDINATES: AMG Zone 05
 COORDINATE DATUM: ADG 84

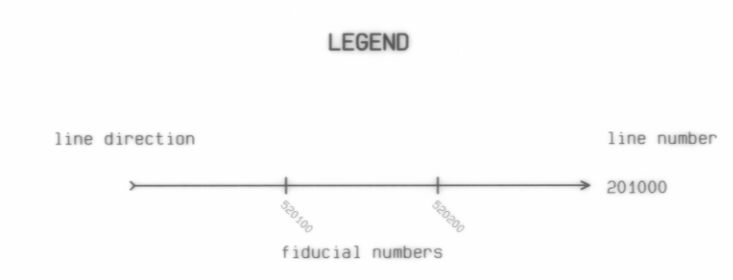

Scale 1:25000

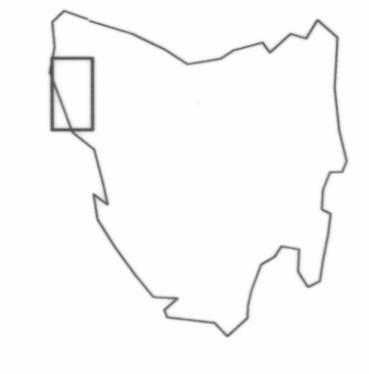
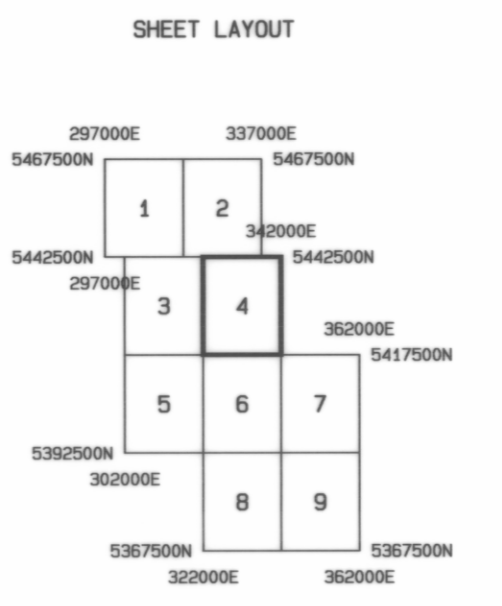

**MINERAL RESOURCES TASMANIA
 AUSTRALIAN GEOLOGICAL SURVEY ORGANISATION**

**NORTHWEST TASMANIA
 FLIGHT PATH**

DRAWN: TESLA-10 PTY LTD
 DATE: MAY 1996

SCALE 1:25000
 SHEET 4 of 9