

SHAFT W5 COVER - PLAN

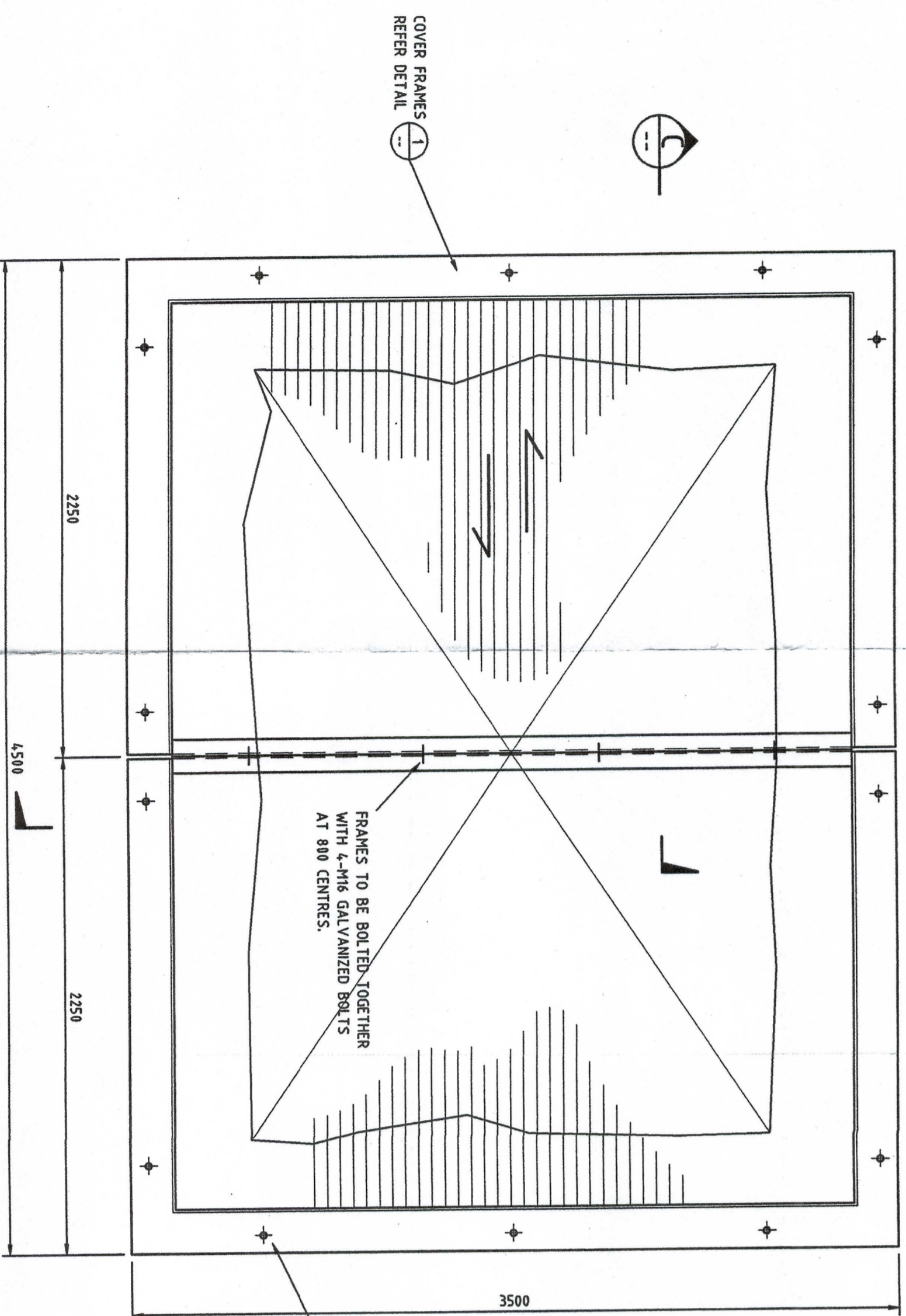

SHAFT W6 COVER - PLAN

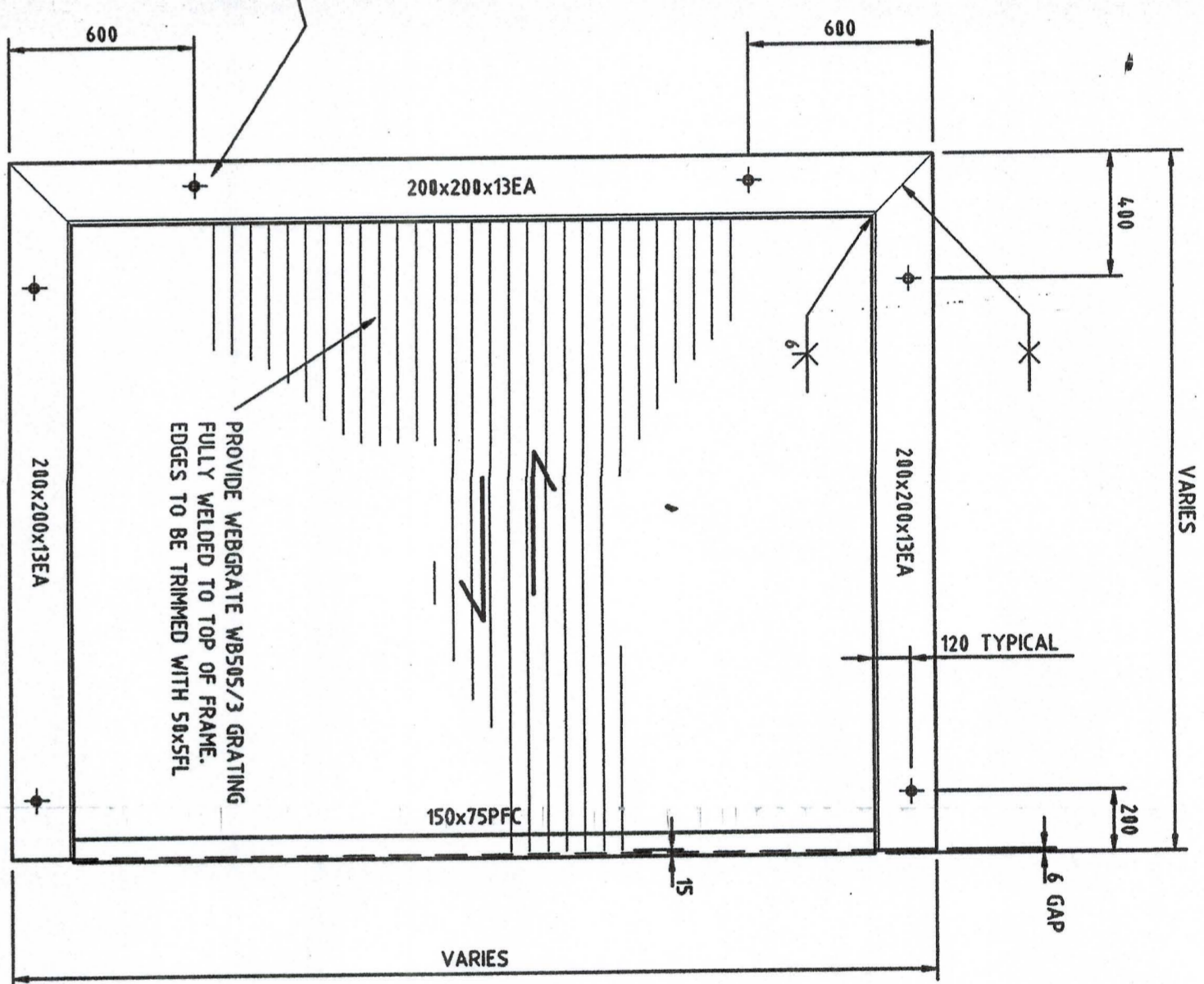

DETAIL 1-1
COVER FRAMES
GENERAL ARRANGEMENT

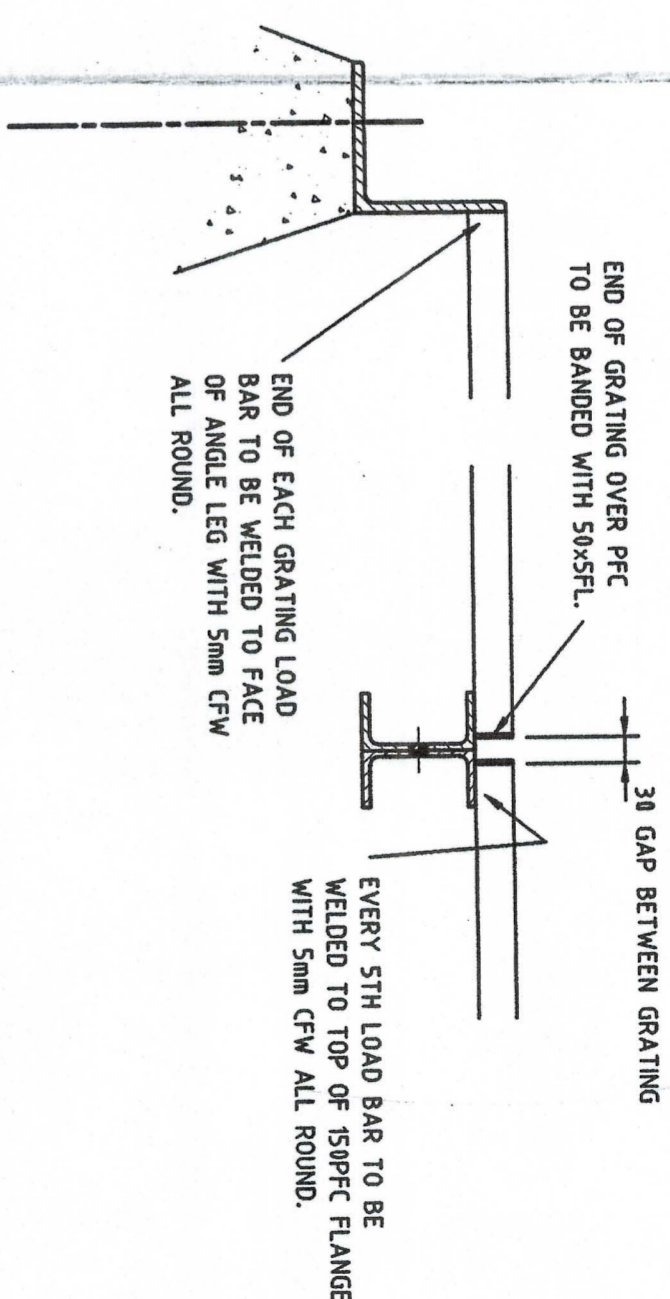

SECTION C
SCALE 1:10

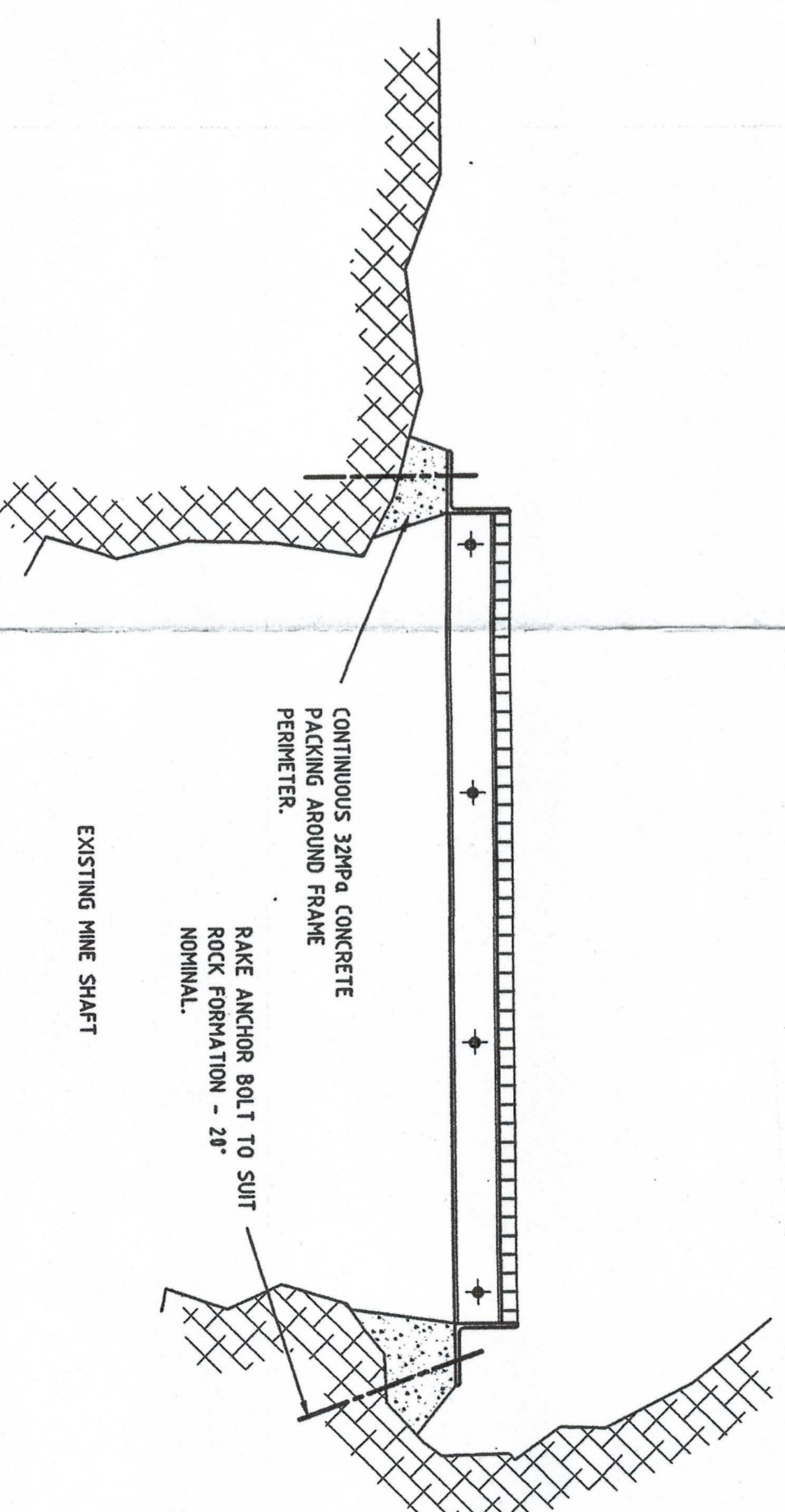

SECTION B

- NOTE:
1. CONCRETE STRENGTH - $f_c = 32MPa$ AT 28 DAYS.
 2. ALL WELDS TO BE 5mm CFW UNLESS NOTED OTHERWISE.
 3. ALL STEELWORK TO BE HOT DIP GALVANIZED AFTER FABRICATION.
 4. ALL BOLTS TO BE GALVANIZED M12/4.6/S UNLESS OTHERWISE NOTED.
 5. ALL BOLTS TO BE WELL BURRED AFTER INSTALLATION.

REV. No	Date	Description
P1	29/08/01	ISSUED FOR TENDER

Thompson & Brett Pty. Ltd.
Consulting Engineers
8 Boyfield Street
Reedy Park, 7018
Phone (08) 8244 6833
Fax: (08) 8244 6221
E-mail: tbb@tbrp.net.au

Design	Date	Scale	File	Issue
P.S.	AUG '01	1:20 UNO	MINE-S-13	A1
Drawn	Date	Controlled Document	Yes	No
B.T.S.	AUG '01	Yes	No	
Design Check	Date	Approved		
Director				



Client & Project
MINERAL RESOURCES TASMANIA
ARGENT SHAFT CAPPING
ZEEHAN

Drawing Title	Issue	Drawing No.	Rev.
MINE SHAFT COVERS CONCRETE AND STEELWORK DETAILS	Issue	01 - 2158 - 02	P1
Acad Name	Issue		
215802			
Geocomp No.			