

61D

193

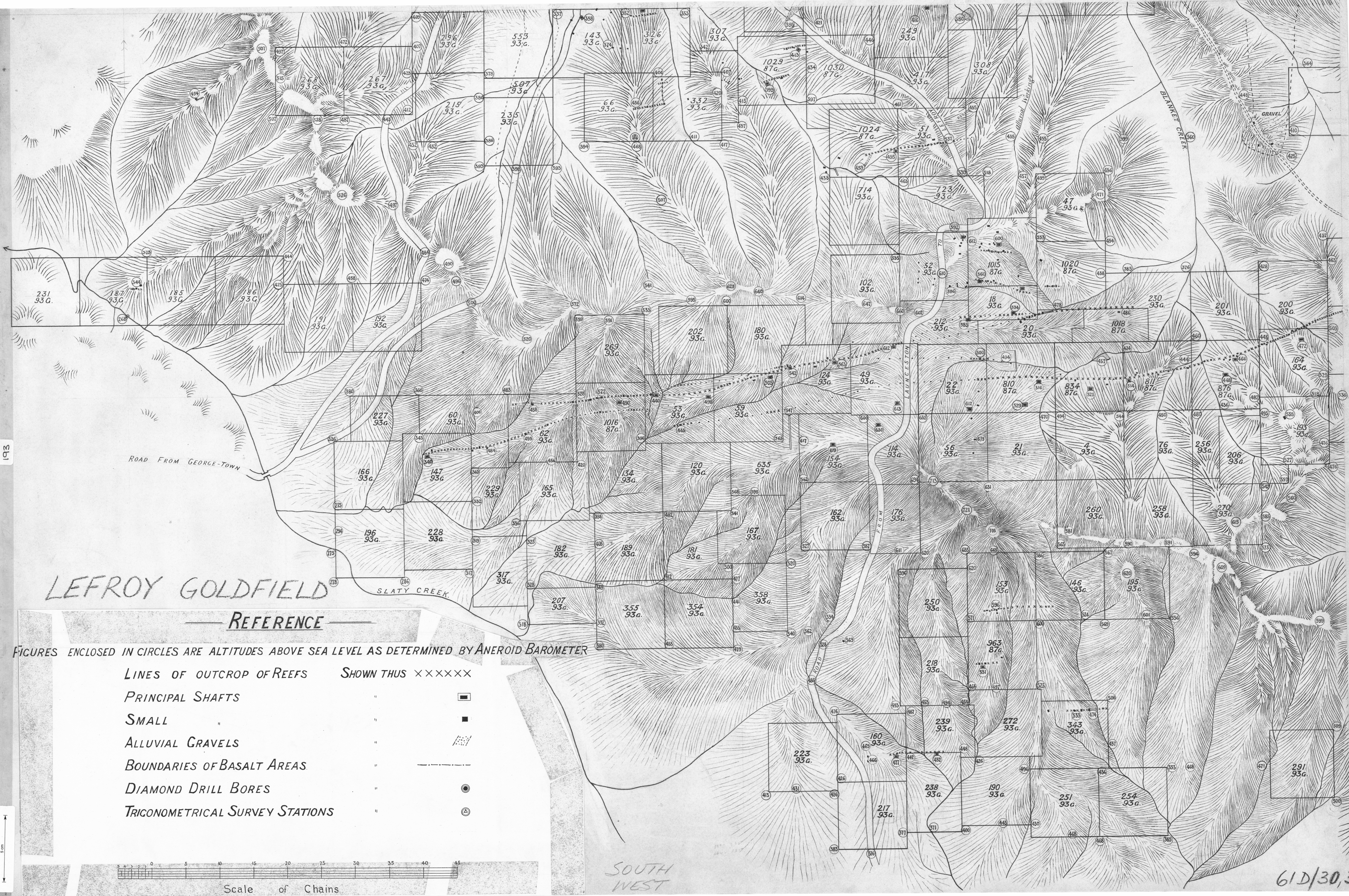

LEFROY GOLDFIELD

REFERENCE

FIGURES ENCLOSED IN CIRCLES ARE ALTITUDES ABOVE SEA LEVEL AS DETERMINED BY ANEROID BAROMETER

- LINES OF OUTCROP OF REEFS SHOWN THUS ××××××
- PRINCIPAL SHAFTS " ■
- SMALL " ■
- ALLUVIAL GRAVELS " [diagonal lines]
- BOUNDARIES OF BASALT AREAS " - - - - -
- DIAMOND DRILL BORES " ●
- TRIGONOMETRICAL SURVEY STATIONS " △

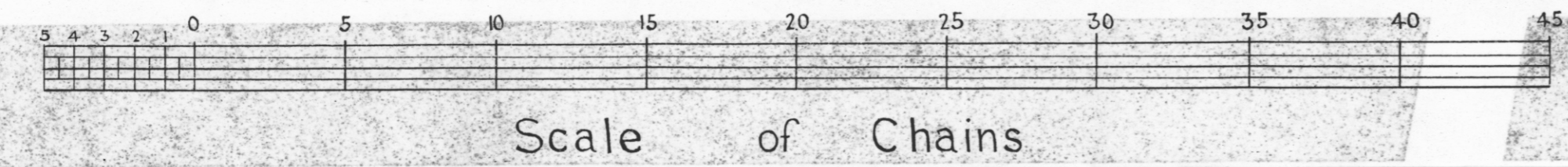

SOUTH WEST

61D/30,31