

5 cm

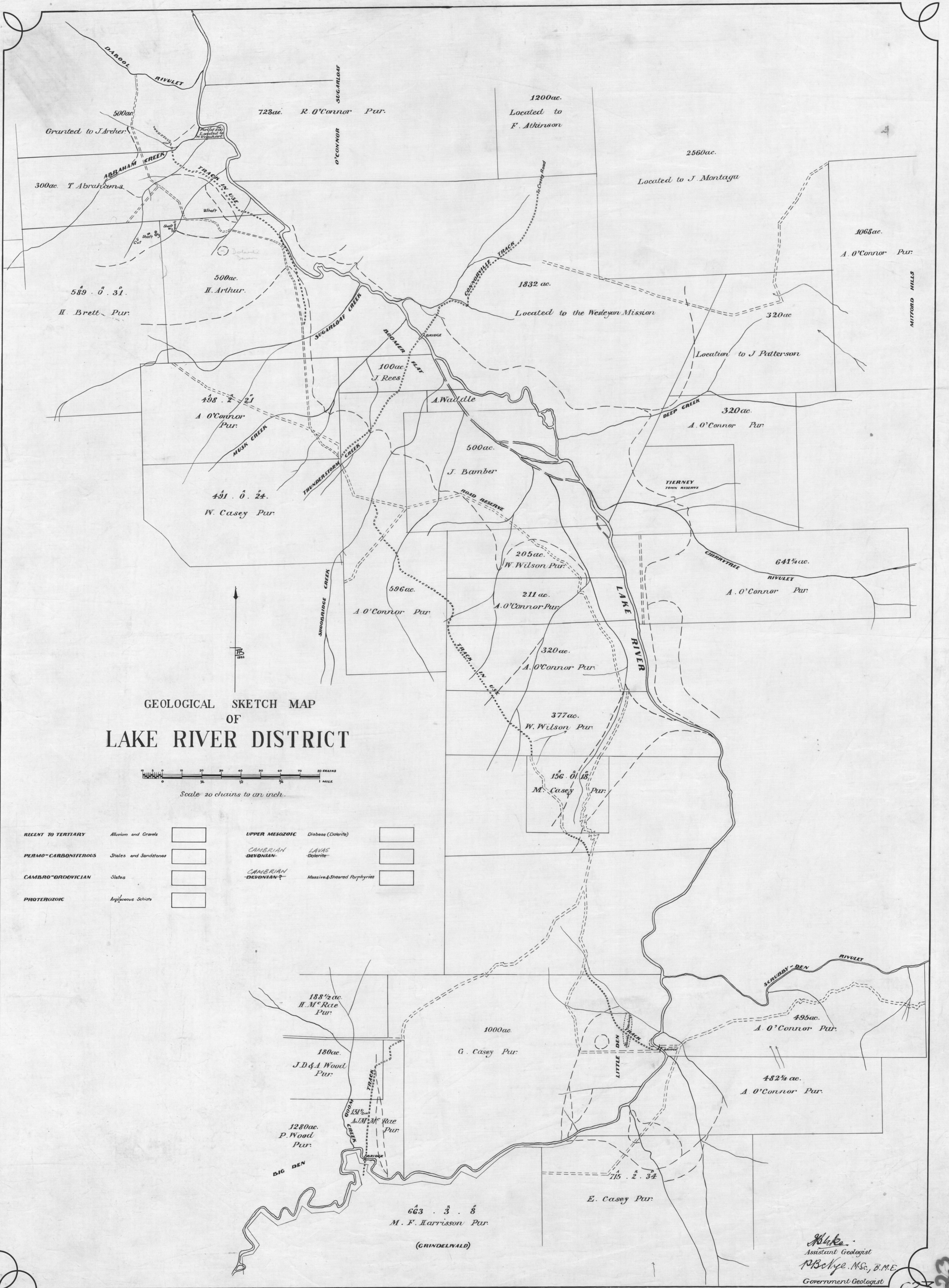

GEOLOGICAL SKETCH MAP  
OF  
LAKE RIVER DISTRICT

Scale 20 chains to an inch.

RECENT TO TERTIARY	Alluvium and Gravels		UPPER MESOZOIC	Diorite (Dolerite)	
PERMO-CARBONIFEROUS	Shales and Sandstones		CAMBRIAN	LAVAS	
			DEVONIAN	Dolerite	
CAMBRO-ORDOVICIAN	Slates		CAMBRIAN	Massive & Sheared Porphyries	
			DEVONIAN		
PROTEROZOIC	Argillaceous Schists				

*Blake*  
Assistant Geologist  
P. B. M. Sc., B. M. E.  
Government Geologist

32

623