

M.D.O. 1125-49
(REDUCTION)
S.47.

1" = 300'

1125

CONTOUR PLAN DALMAYNE COALFIELD

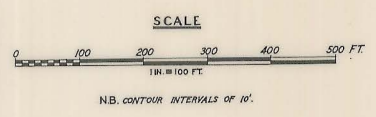

Neil Abbeaton A.O.S.M.
TECHNICAL & ADMINISTRATIVE ASST
OCT. 1948

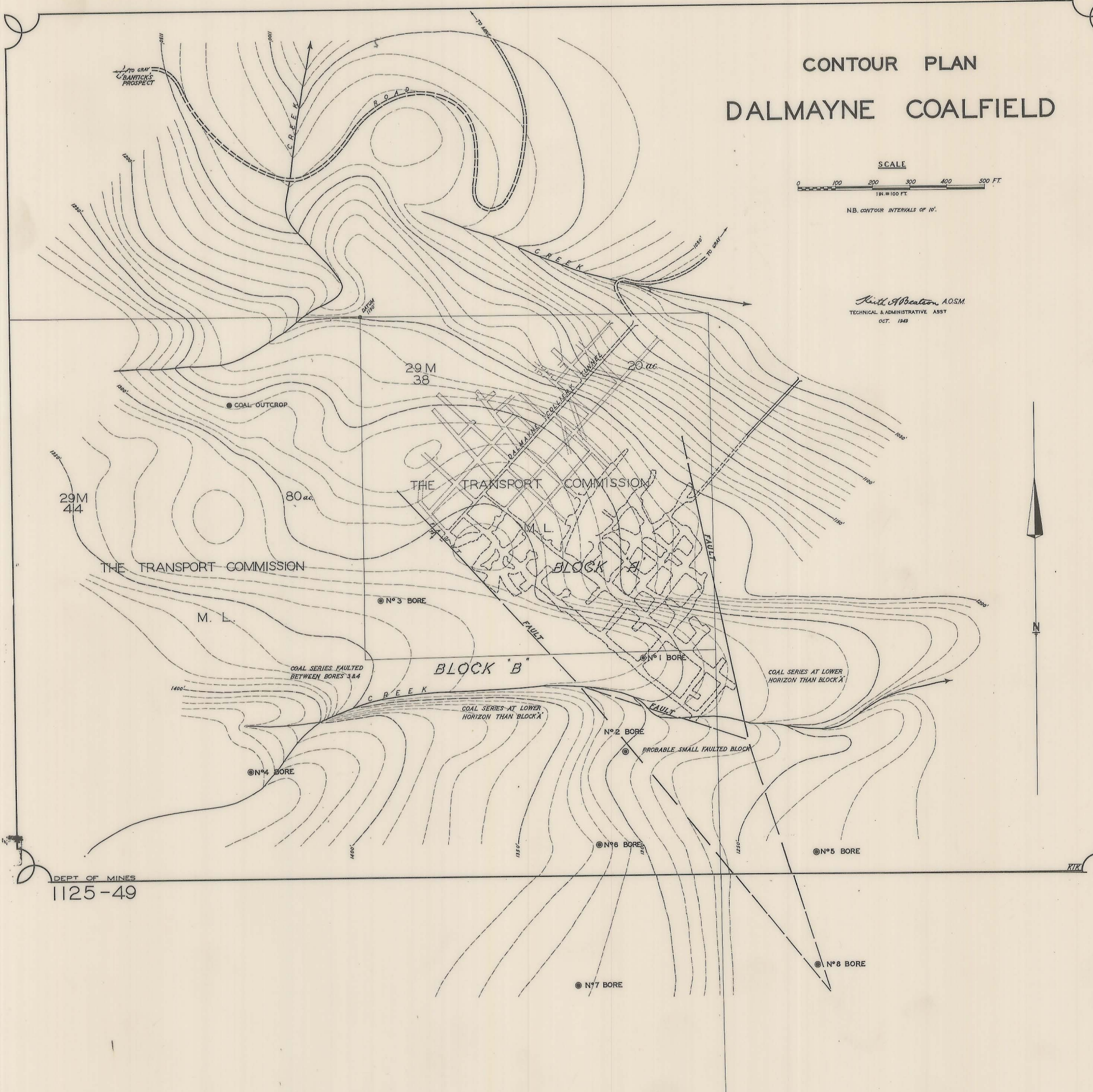

DEPT OF MINES
1125-49

5 cm

6465

● N°9 BORE

1" = 300 ft.