

661/10

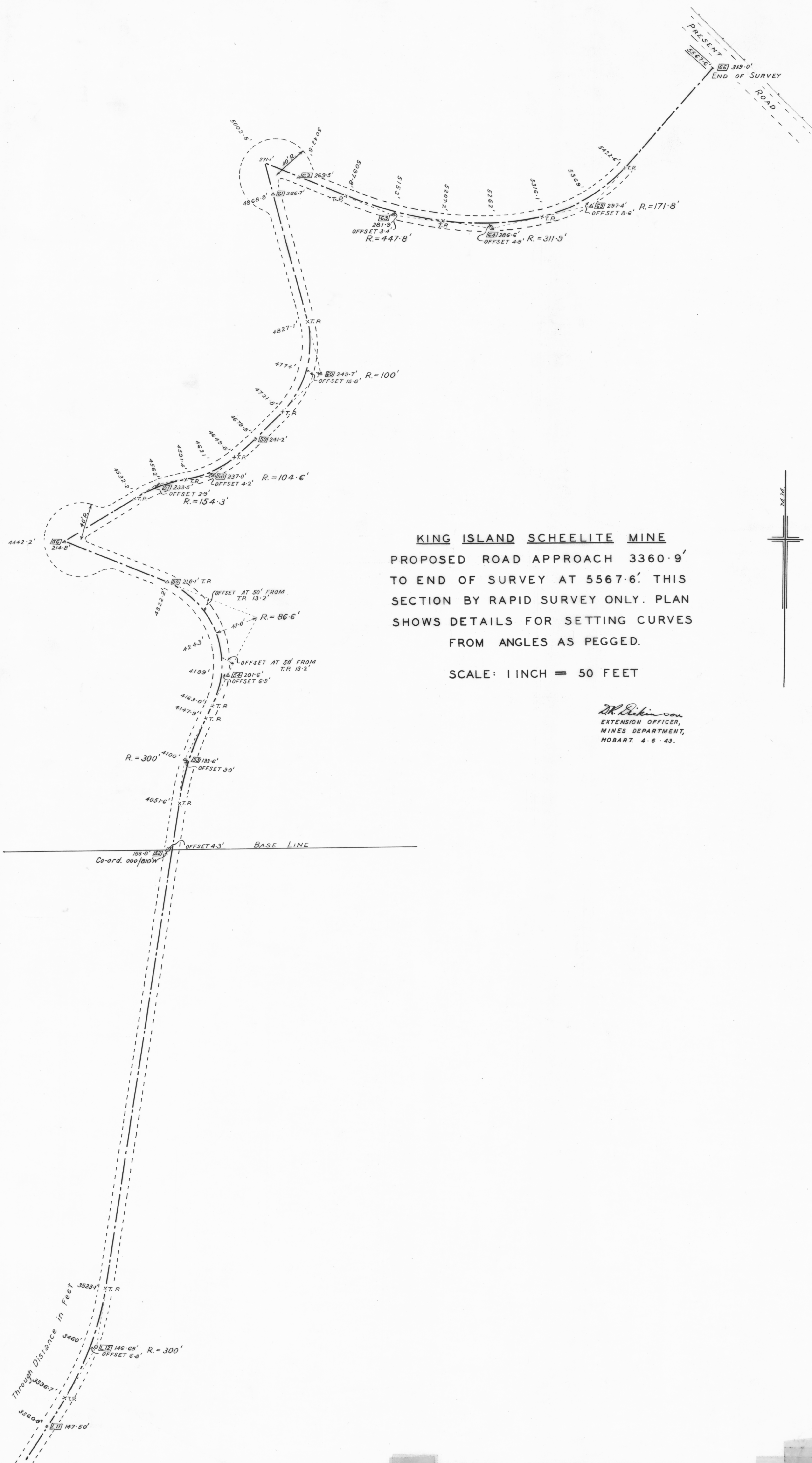

**KING ISLAND SCHEELITE MINE**  
 PROPOSED ROAD APPROACH 3360.9'  
 TO END OF SURVEY AT 5567.6'. THIS  
 SECTION BY RAPID SURVEY ONLY. PLAN  
 SHOWS DETAILS FOR SETTING CURVES  
 FROM ANGLES AS PEGGED.

SCALE: 1 INCH = 50 FEET

*H. Dickinson*  
 EXTENSION OFFICER,  
 MINES DEPARTMENT,  
 HOBART. 4.6.43.

