

BORING PLAN

BRANXHOLM LEAD  
(ARBA LEAD)

5 cm

674/32

NUMBER OF BORE	DEPTH TO BEDROCK	TIN CONTENT OZ. PER C.YD. OF 70%
1 1931	170 FEET	0.45
2	149	0.52
3	180	0.76
4	190	0.47
5	198	0.44
6	203	0.20
7	173	0.51
8	174	0.34
1 1937	148	1.25
2	142	2.91
3	99	2.01
4	144	2.22
5	102	1.29
6	54	0.64
7	54	1.33
8	138	2.89
9	146	1.64

SCALE  
4 CHAINS 1 INCH

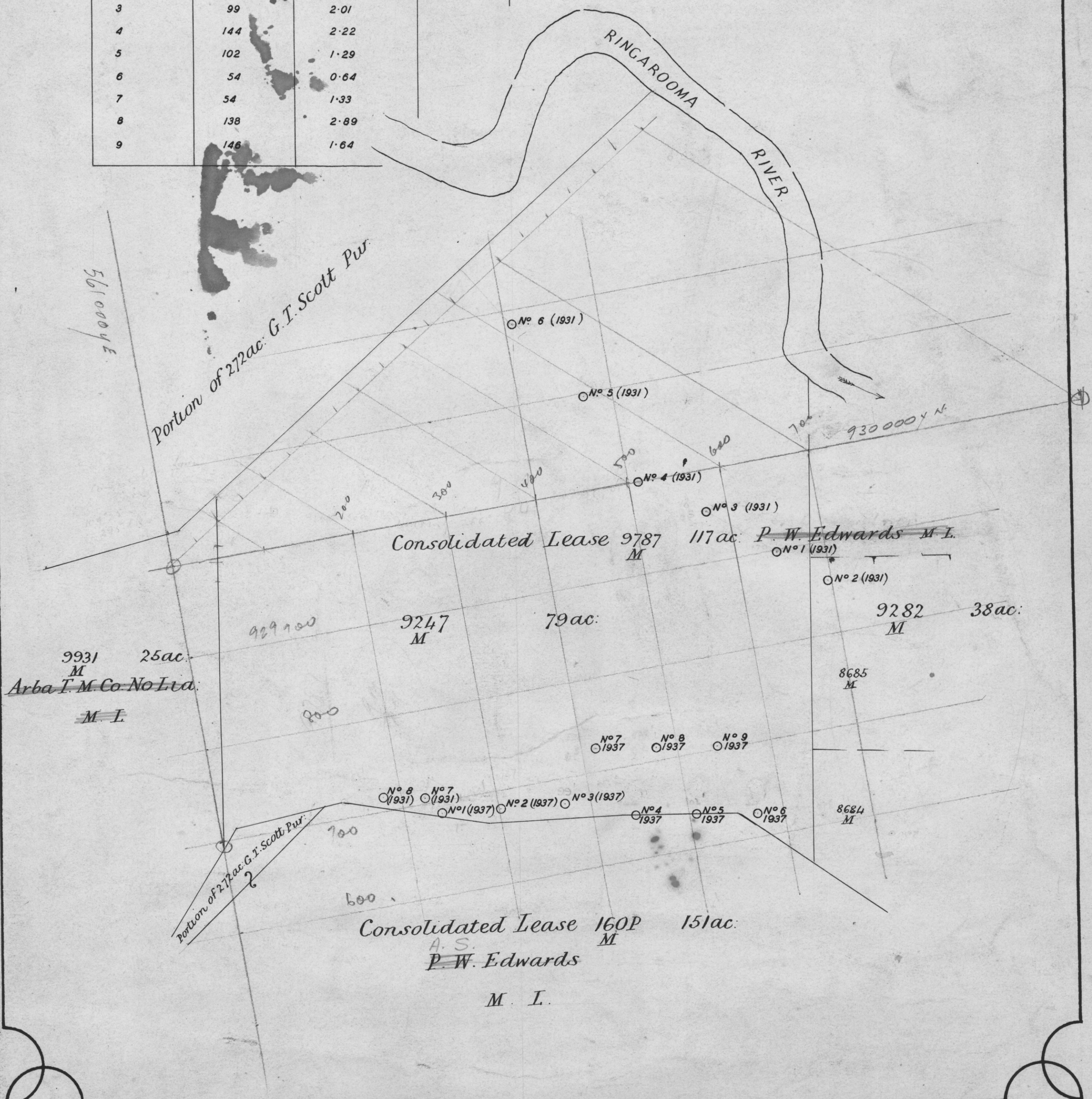
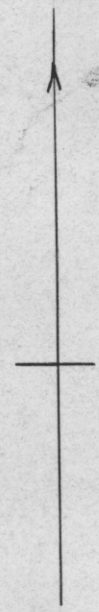

363

674

27.25

7-674