

696 E

393

PLATE V

5 cm

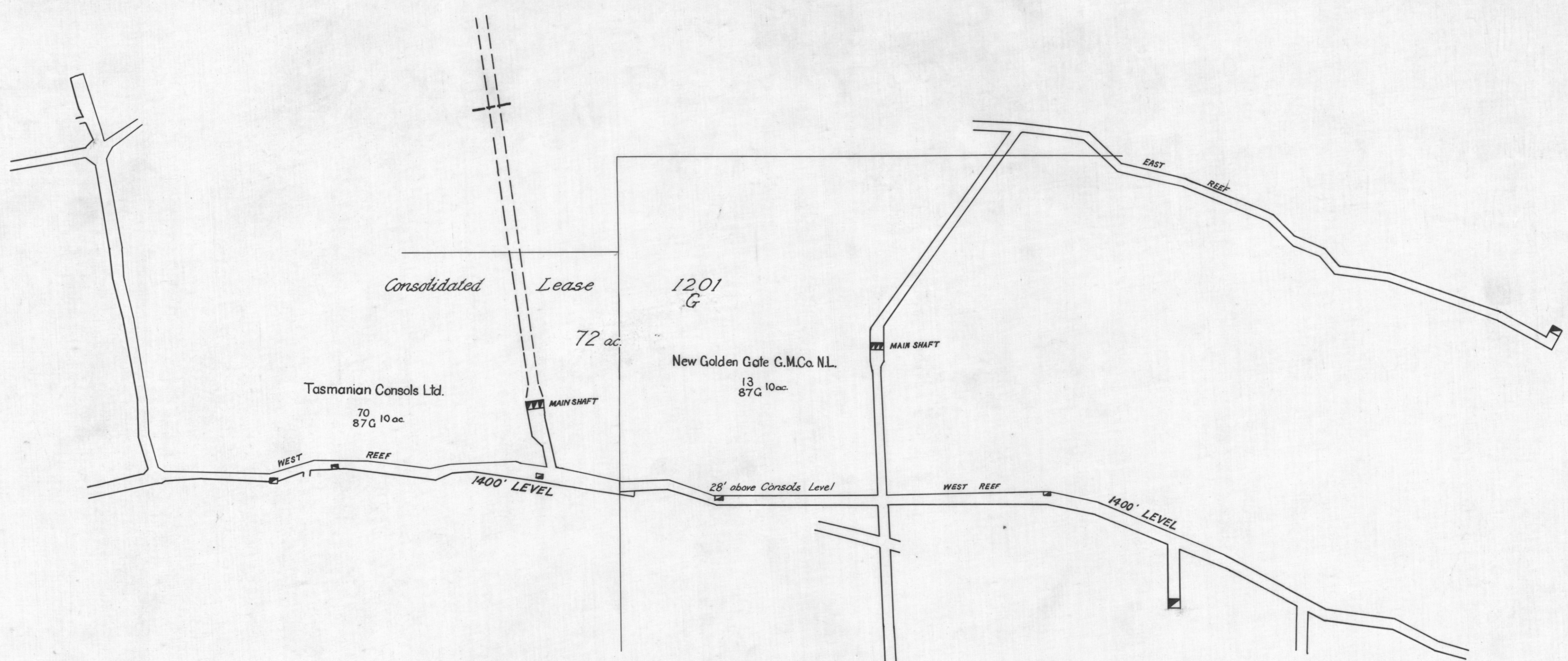

PLAN OF WORKINGS 1400FT. LEVEL
TASMANIAN CONSOLS-NEW GOLDEN GATE MINES

Scale 0 10 20 30 40 50 60 70 80 90 Feet

COMPILED FROM DEPARTMENTAL PLANS

K.J. Finckel M.Sc.
 Field Geologist.
 8-9-35

696E/40

Q.J.M.