

5 cm

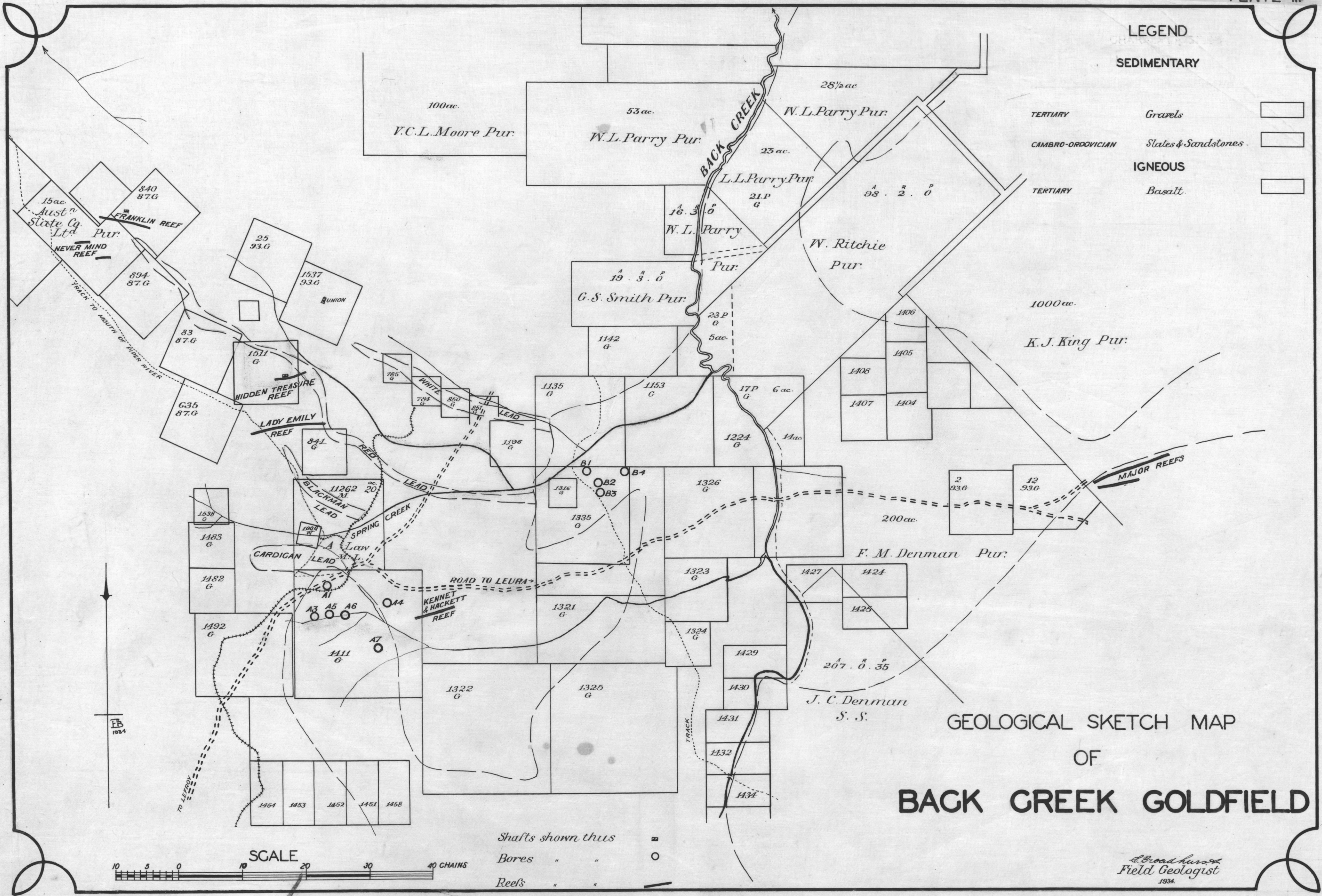

LEGEND

SEDIMENTARY	
TERTIARY	Gravels
CAMBRO-ORDOVICIAN	Slates & Sandstones
IGNEOUS	
TERTIARY	Basalt.

1000 ac.
K.J. King Pur.

GEOLOGICAL SKETCH MAP
OF
BACK CREEK GOLDFIELD



Shafts shown thus

Bores " "

Reefs " "

L. Broadhurst
Field Geologist
1934

698/31