

DIAGRAM FROM ACTUAL SURVEY

COUNTY OF RUSSELL

OF WHYTE RIVER

Scale 6 chains to an inch.

CANCELLED
11 MAY 1920

11 MAY 1920

FROM DAVID JONES,
DISTRICT SURVEYOR.

Waratah, Tas.,
August 24 1914

The SURVEYOR-GENERAL,
Hobart.

Sir,
I have the honour to forward a Report upon a Section applied for under the Regulations of the Mining Act, 1905, 5 Ed. VII., No. 23.

County of Russell
Vicinity of Wwhyte River - Waratah road.
Applicant The Magnet Silver Mining Co. (Vic)
Length 3m. 52ch. 45.3/16. No. 1319

Report :-

- This water has been marked off in accordance with the Regulations under the Mining Act 1905. It encroaches upon land held by the Government to the 60° No 5334 - by J. J. Jupp his 6669 - by S. B. Brandon 6672 and by S. B. Brandon 6669 - 140 acres.
- This water right crosses the main road (Macadamised) from Waratah to Waraburnd. It does not encroach upon any other road, water right or mining easement.
- Chiefly, densely wooded, rough country.

I have the honour to be,
Sir,
Your obedient Servant,
David Jones
District Surveyor.

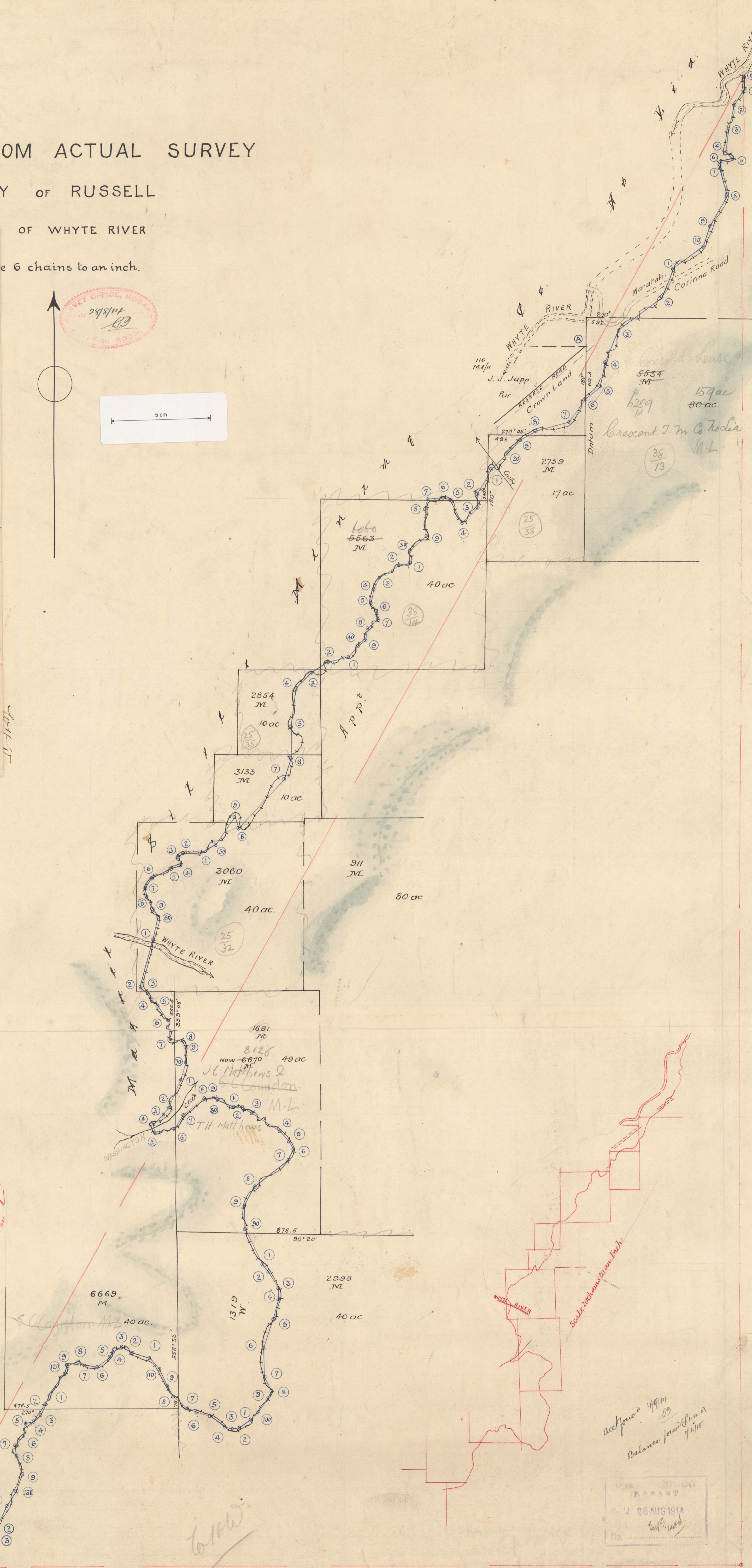
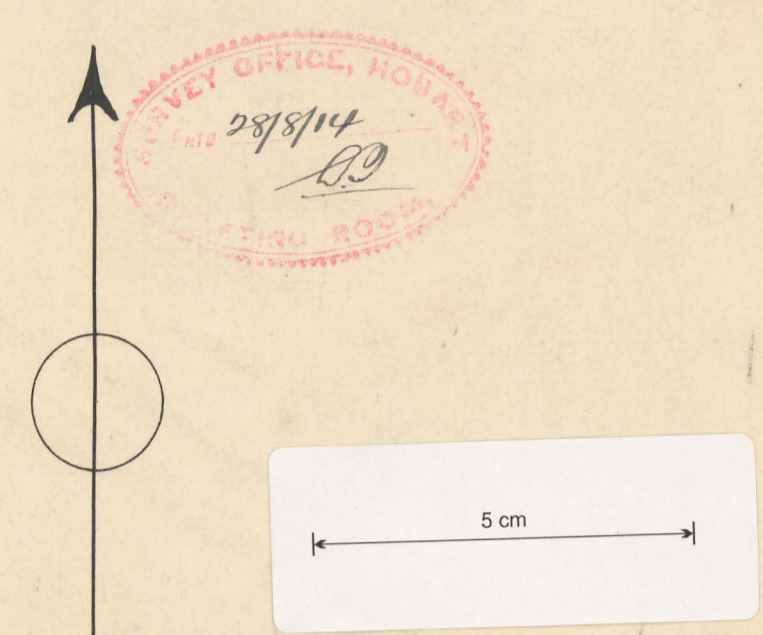

Reference to Stations

St.	Bearing	Distance in links	From
4	356° 25'	32	Beech
18	220° 02'	33.4	Big Beech
29	77° 56'	26.2	Gum
44	237° 45'	45	"
48	149° 50'	53	Gum
50	282° 56'	16.5	"
60	10° 15'	27	"
75	92° 08'	48	Big Gum
86	184° 47'	21.5	"
90	82° 27'	4.9	Beech
98	245° 05'	10.8	Big Beech
103	346° 10'	6.3	Beech
109	221° 25'	30	"
116	79° 50'	13.5	"
125	113° 00'	12.2	Big Beech
154	83° 50'	8	Beech
158	328° 30'	23.6	"
62	30° 20'	16	Eucriphia

Re Corinna Road

was 18-2-13

May be acted upon 11.1.15
Acted upon

Date of instruction 7. 2. 12
Survey commenced 3. 6. 14
Survey finished 9. 7. 14
Error in close 1 in
Plotted by *D. J. Jones*
Finally examined by *D. J. Jones*
Entered on General Plan by *D. J. Jones* 31. 8. 14
Tracing to Launceston 27. 8. 14

Rough scrubby country with big trees
David Jones
Surveyor.

Balance from *(D. J. Jones)*
No. *1319*

SP
44/01

Consolidated Lease B
Magnet Silver Mining Co. No Lia.

1319
W

44

44