

PLAN 5

54. BRISEIS TIN MINES.

54

PLAN

MINERAL

COUNTY OF DORSET VICINITY of CASCADE RIVER

Scale in 2m chains to an inch

Date of instructions 10th April 1902
Survey commenced 5th June 1902
" Finished 1st July 1902
Errors of close 1 in 2390, G.M.R.
3285 3656, 7 M.R.
Charted 06 5 7 02
Plotted by 29 18 7 02
Finally examined by 01 23 7 02
May be acted upon

Donald Fraser
Authorised Surveyor

CORNER	BEARING	DIST. IN LINKS	FROM
19	328° 50'	54.6	Dead Stump
22	30° 00'	1.2	" "
21	358° 40'	78.4	" "
24	90° 16'	65	" "
28	151° 30'	48	" "
31	215° 50'	58	" "
33	212° 0'	17.2	Stringy Bark
34	90° 16'	11.2	Stump



May be acted upon 24.7.02

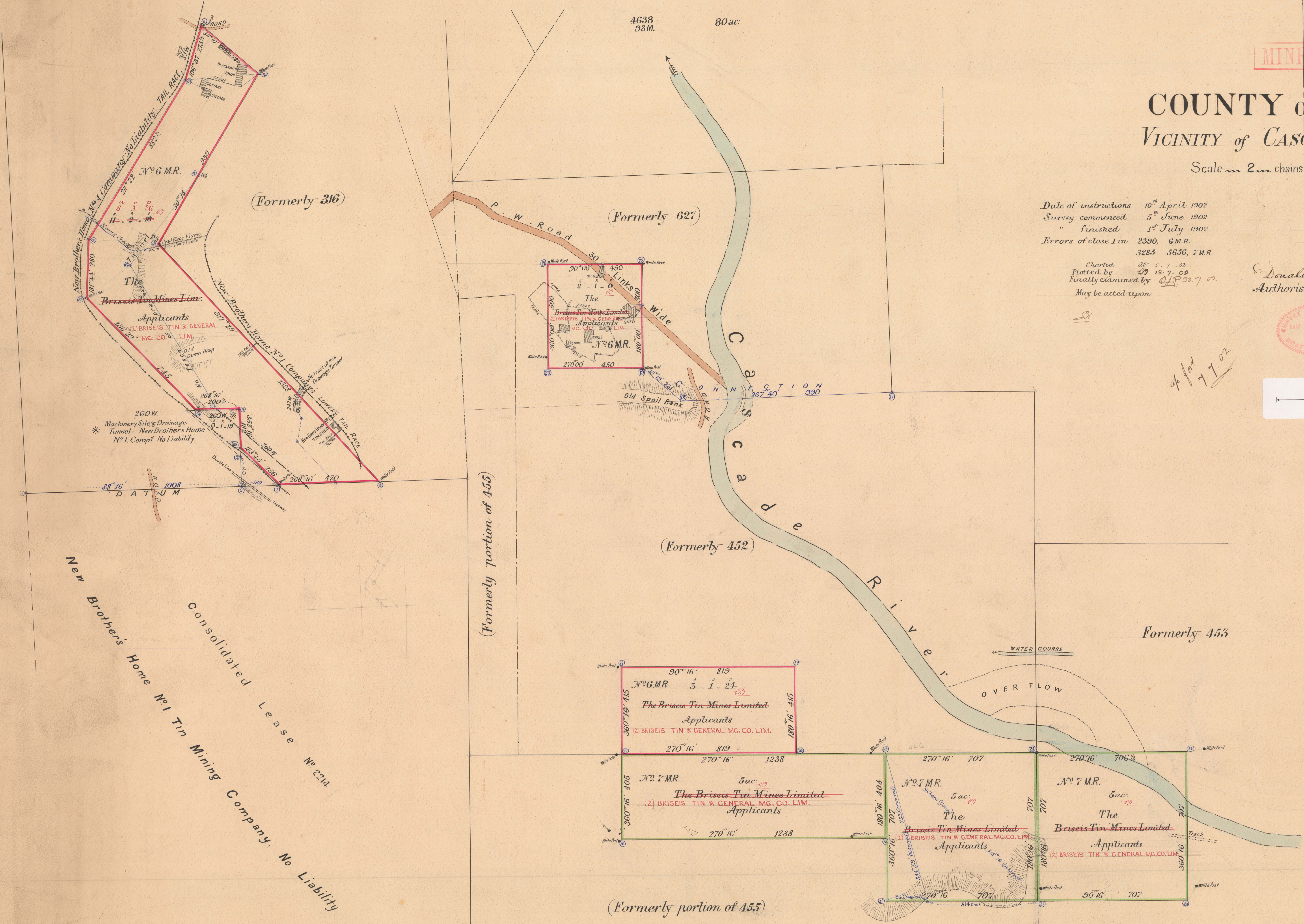
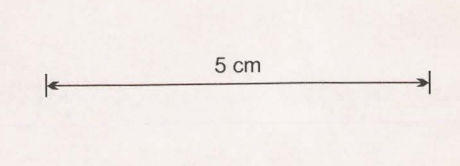

New Brothers Home No 1 Tin Mining Company. No Liability
Consolidated Lease No 2214



Issued to Section 5.7.02