

PLAN NEAR MOUNT BISCHOFF

COUNTY OF RUSSELL

SCALE EIGHT CHAINS TO AN INCH.

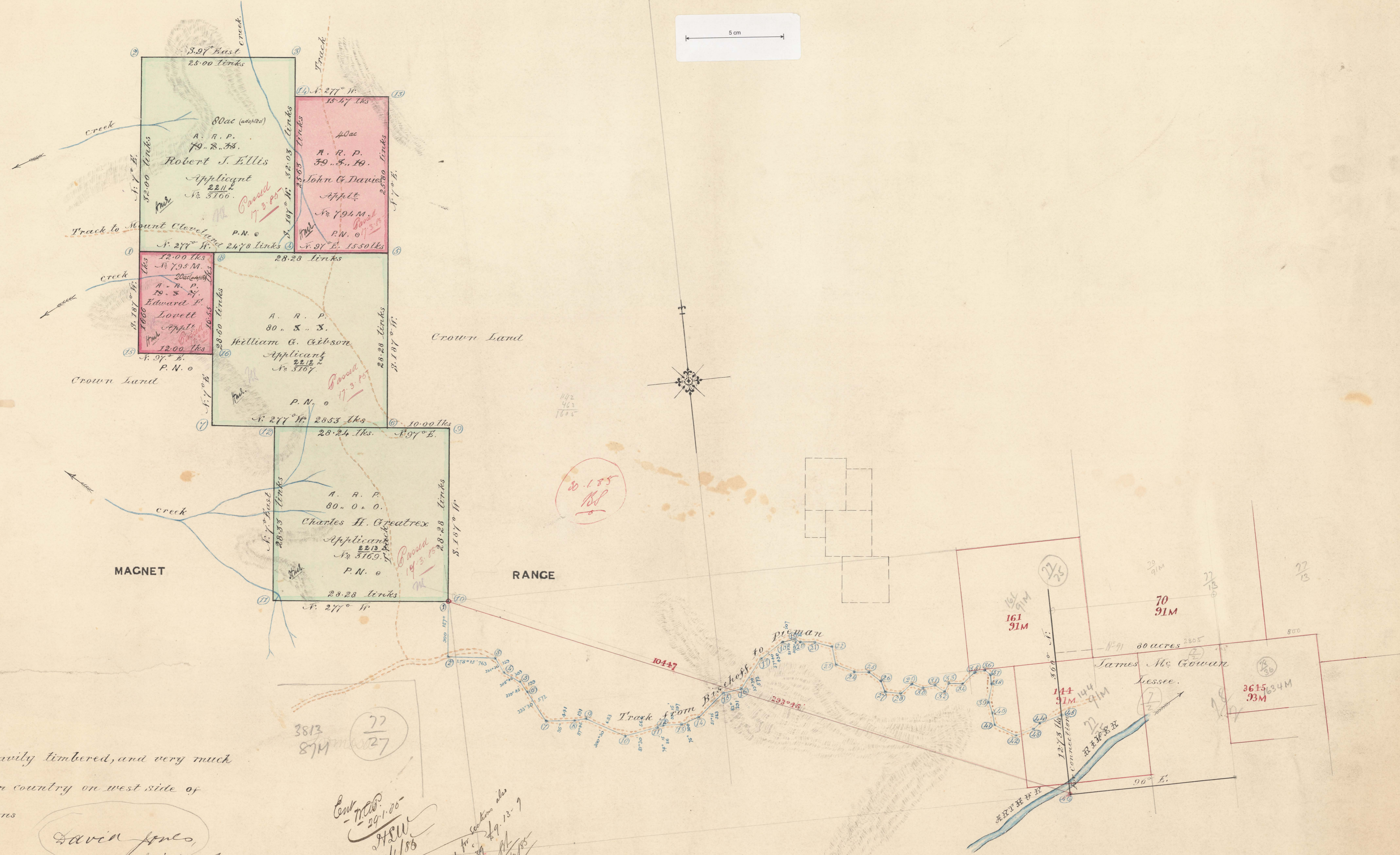
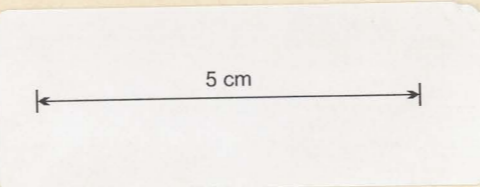

Heavily timbered, and very much broken country on west side of sections

David Jones,
Mining Surveyor.

Cont. No. 29-1-00
H.S.W.
29/1/88
ap. forwarded to the
Committee
15. 29. 29. 13. 7
3/2/85

SP
73/01

Charted by T.G.



MAGNET RANGE

73: MAGNET RANGE.

73

No 73