

— PLAN —  
— OF —  
— SURVEY OF WATERRIGHT —  
— PAISH OF CASTLE CAREY —  
— COUNTY CORNWALL —

E. GAUNT APPLICANT 323 *248 add h 40*  
2. South Esk Tin Mining Co. No Lia. 93W

**DUPLICATE.**

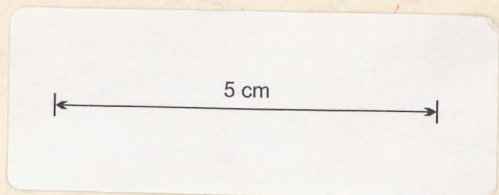

*Tracing to Liston  
26. 9-99*

SCALE 8 CHAINS TO 1 INCH

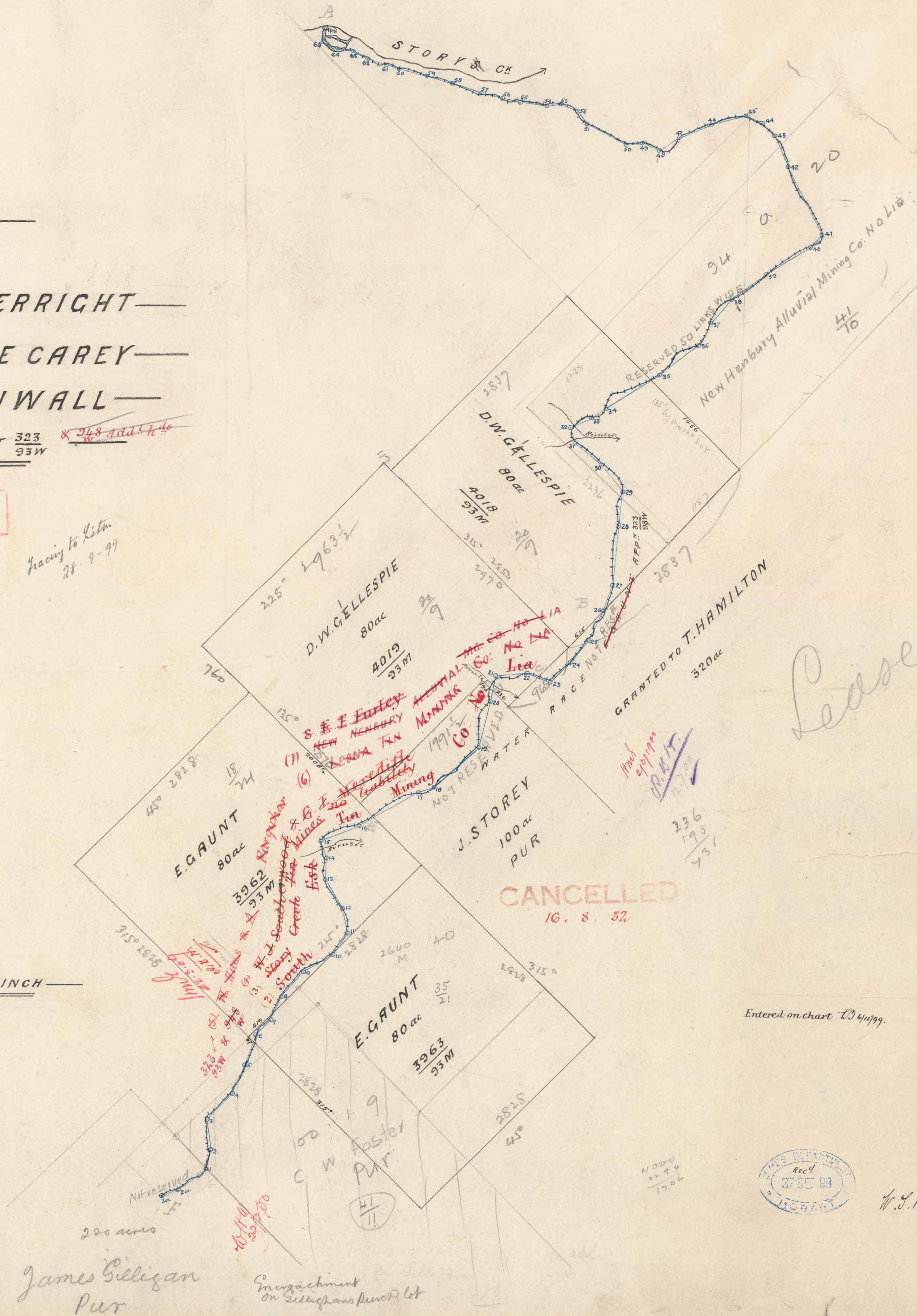

A to B 131.95 + -  
C to D 6.05 + -  
E to F 54.40 + -

*Lease as per plan*

Entered on chart D 4999. *3. 2. 1900*



*W. S. Burnard  
Assistant Surveyor  
21<sup>st</sup> Aug 1899*

SP  
77/02

*James Gilligan  
Pur*

*Encroachment  
on Gilligan's Pur lot*

*4070  
2294  
1706*

*11/10  
21/11/99  
236  
195  
431*

*but  
was*

323. & . 910 SOUTHERWOOD &

77. 93.W.

MEREDITH.

323 South Esk T. M. Co.  
33W  
Ben Lomond

AA  
846